

RoHS

REV	DESCRIPTION	DATE
A	ISSUE	Jan/10/2013

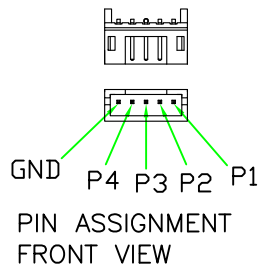
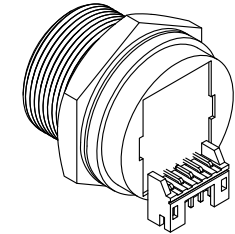
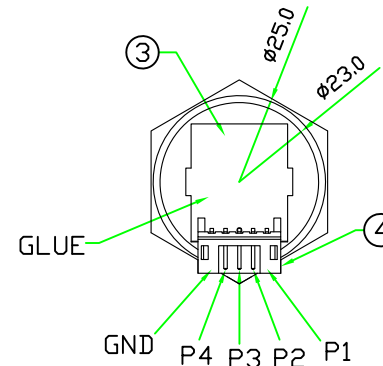
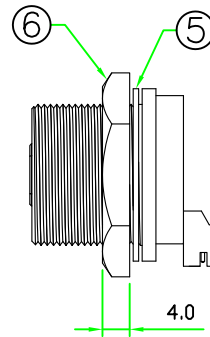
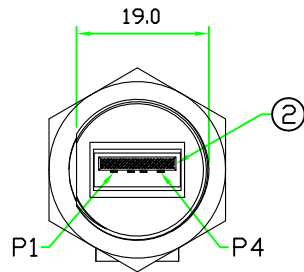
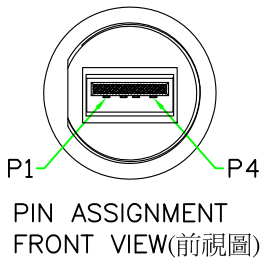
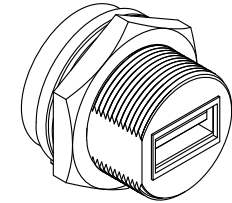
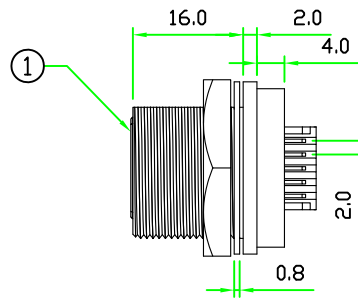
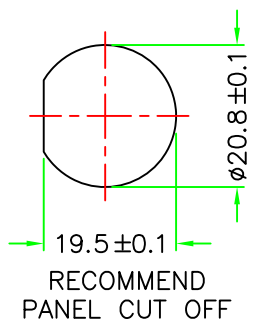

6	HEX NUT	NYLON+GF.	BLACK	1	RJ45CUSB-NUT
5	GASKET	EPDM.	BLACK	1	CCA-G
4	WAFER	PITCH 2.0mm, RIGHT ANGLE. 5P*1ROW.	BLACK	1	
3	PCB	FR4 . DOUBLE SIDE, 1.0mm THICKNESS.		1	USBABF-PCB
2	CONNECTOR	USB A TYPE FEMALE CONNECTOR.		1	
1	BODY	USB A TYPE FEMALE CONNECTOR BODY. NYLON+GF.	BLACK	1	USBAC-PC
No.	PART NAME	DESCRIPTION	COLOR	Q'TY	REMARKS

HOLIN® **All Connectors**
www.allconnectors.eu | info@allconnectors.eu
 Tel. +49 (0)711 / 358 110 20 | Fax +49 (0)711 / 358 110 25

UNIT: mm
 SCALE 1:1
 TITLE : USB A TYPE FEMALE C SIZE
 SCREW TYPE CIRCULAR FLANGE PANEL
 5 PIN RIGHT ANGLE WAFER

UNLESS OTHERWISE SPECIFIED TOLERANCES:
 x ±0.25 xx ±0.1
 xxx ±0.05 ANGLE ± 1°X

REV. A SHEET 1/1
 P/N: USB2AC-P3C04
 DWG.NO: USB2AC-P3C04

DR. *jaek*
 CH. *Michael*
 AP.