

RoHS

REV	DESCRIPTION	DATE
A	ISSUE	Jan/10/2013

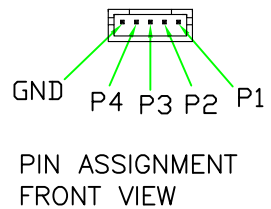
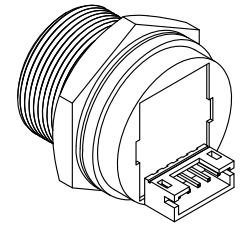
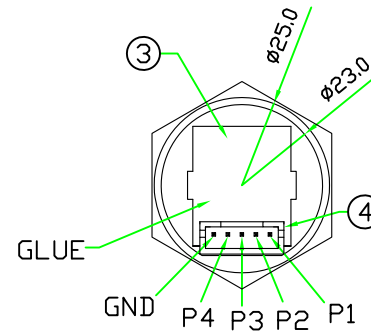
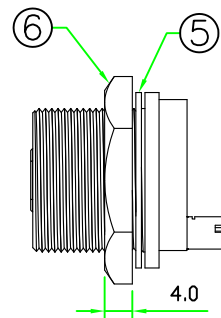
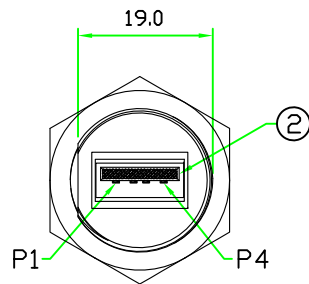
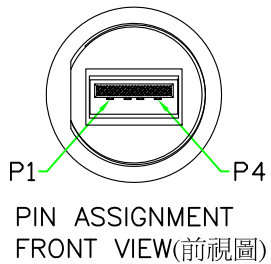
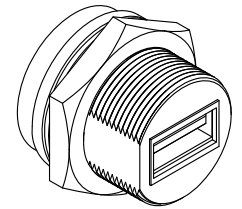
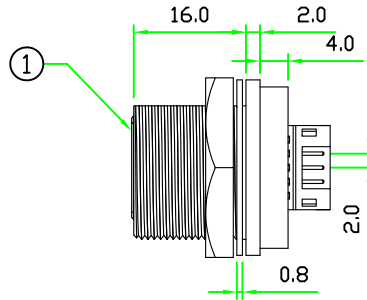
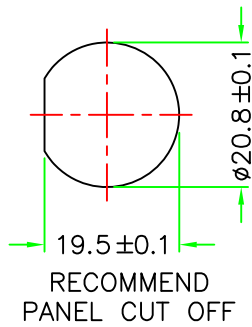

6	HEX NUT	NYLON+GF.	BLACK	1	RJ45CUSB-NUT	HOLIN® <small>www.allconnectors.eu info@allconnectors.eu Tel. +49 (0)711 / 358 110 20 Fax +49 (0)711 / 358 110 25</small>	TITLE : USB A TYPE FEMALE C SIZE SCREW TYPE CIRCULAR FLANGE PANEL 5 PIN STRAIGHT WAFER	DR. <i>Jack</i> CH. <i>Michael</i> AP.
5	GASKET	EPDM.	BLACK	1	CCA-G			
4	WAFER	PITCH 2.0mm, STRAIGHT ANGLE. 5P*1ROW.	BLACK	1				
3	PCB	FR4 . DOUBLE SIDE, 1.0mm THICKNESS.		1	USBABF-PCB			
2	CONNECTOR	USB A TYPE FEMALE CONNECTOR.		1				
1	BODY	USB A TYPE FEMALE CONNECTOR BODY. NYLON+GF.	BLACK	1	USBAC-PC			
No.	PART NAME	DESCRIPTION	COLOR	Q'TY	REMARKS	UNLESS OTHERWISE SPECIFIED TOLERANCES: X ±0.25 XX ±0.1 XXX ±0.05 ANGLE ± 1° REV. A SHEET 1/1	P/N: USB2AC-P3C03 DWG.NO: USB2AC-P3C03	