



Male socket with wire (M5*0.5 Rear mount)

Connector Series: M5

Gender: Male

Coding: A

Assembly Style: Screw (M5)

Part Number: M05AM0003

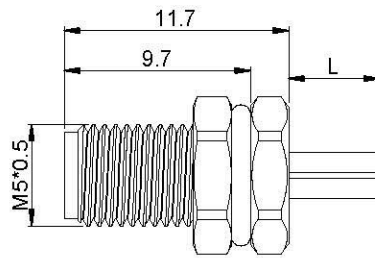

General Information:

Standard: IEC 61076-2-104-2008

Connector body: PA66+GF

Connector Contacts: Brass with gold plated



Coupling Nut: Brass with nickel plated

Operating temperature: $-25^{\circ}\text{C} \sim +80^{\circ}\text{C}$

Insulation Resistance: $\geq 100\text{M}\Omega$

Waterproof Rating: IP67/IP68

Electrical Character:

Contacts	Rated voltage		Rated current(40°C)	Contact Resistance	Cable format	Cable OD
	A/C	D/C				
 3 Pins	60V	60V	1A	<10mΩ	24AWG~20AWG	/
 4 Pins	60V	60V	1A	<10mΩ	24AWG~20AWG	/

Remarks:

All Connectors

www.allconnectors.de
Tel.: 0049 711 7009503
70794 Filderstadt - Germany

info@allconnectors.de
Fax: 0049 711 7009504
Kettnerstr. 25