

REV.	DESCRIPTION	DATE
A	ISSUE	Jun/05/2013

ø5.0±0.05

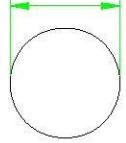

Recommended Panel Cut-Out

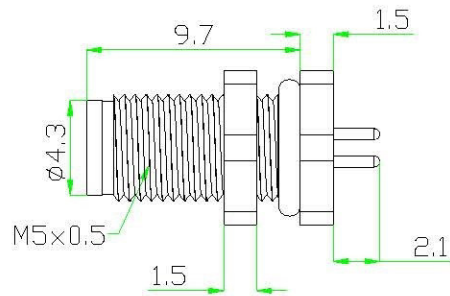

RoHS
IP67

NOTES:

1. ELECTRICAL CHARACTERISTICS:

CURRENT RATING: 1A

TEMPERATURE RANGE: -25°C TO +85°C

DIELECTRIC WITHSTANDING VOLTAGE:

500V AC FOR ONE MINUTE

2. HOW TO ORDER: A05X-M1XXHPR

04 - 4 PINS

I - CURRENT RATING 1A

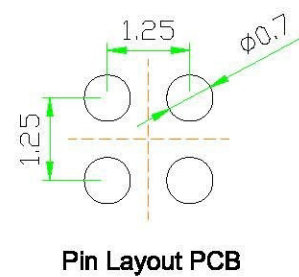
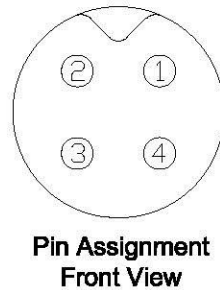
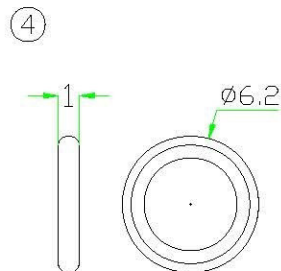
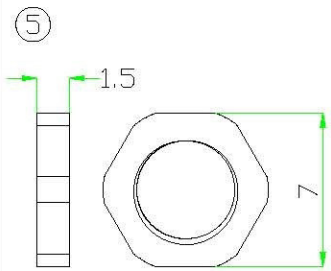
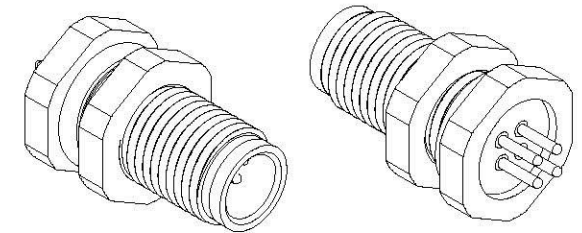
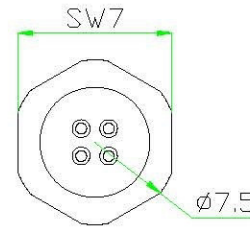
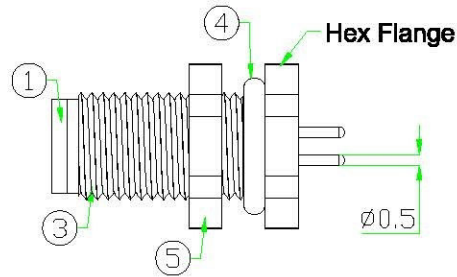
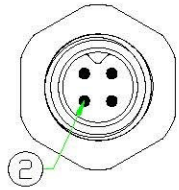

5	HEX NUT	BRASS, NICKEL PLATED.		1	
4	O-RING	VITON.	BLACK	1	
3	HOUSING	BRASS, NICKEL PLATED,		1	
2	CONTACT	Brass , 6 u" Gold plated .Male Contact.		4	
1	CONNECTOR	M5 Male 4-pins connector insert.	BLACK	1	
No.	PART NAME	DESCRIPTION	COLOR	QTY	REMARKS

		UNIT: mm	TITLE : M5 Male connector Rear mount Hex Flange PCB Pin	
		SCALE 3:1		
UNLESS OTHERWISE SPECIFIED TOLERANCES: X ±0.25 XX ±0.1 XXX ±0.05 ANGLE ± 1°X		P/N:	A05I-M104HPR DR. Stanley CH. N3CH	
REV. A	SHEET 1/1	DWG.NO:		

Allconnectors

www.allconnectors.de
Tel.: 0049 711 7000503
70771 Filzbergstr. - Germany

info@allconnectors.de
Fax: 0049 711 7005504
Kettnerstr. 25