

- NOTES:
- MATERIAL:
HOUSING: HEIGH TEMP THERMOPLASTIC
COLOR: BLOCK.
UL 94V-0
TERMINAL: PHOSPHOR BRONZE
SHELL: STEEL
 - PLATING
CONTACT AREA: GOLD OVER NICKEL.
TAIL AREA: TIN-LEAD OVER ALL.
SHELL: Ni OVER ALL.
 - RECOMMENDED PCB THICKNESS: 1.60mm
 - CONTACT AREA ALIGNMENT MUST BE WITHIN 0.15mm.

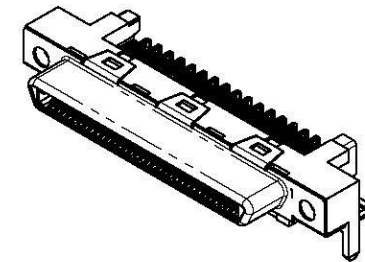
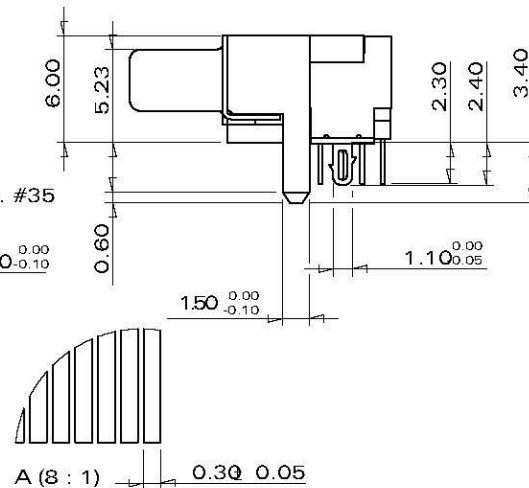
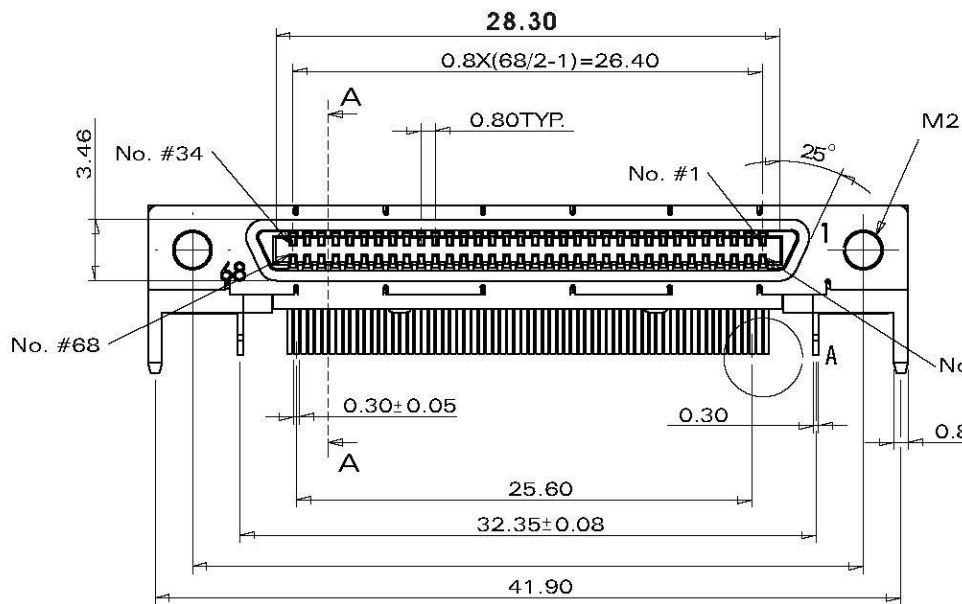

All Connectors

www.allconnectors.de
Tel.: 0049 711 7095-03
71734 Aldersbach - Germany

info@allconnectors.de
fax: 0049 711 7095-04
Ketteimerstr. 25

PART NO. VHC-SRN-068

DWG NO. VHC-SRN-068

FILE NO.

UNIT / mm

SCALE 1:1

CHECKED BY CY

DRAWING BY

PROJECTION



TOLERANCES ARE

.X ± 0.2
XX ±
XXX ±
AWG

DESCRIPTION:

VHDCI 0.8mm PITCH 68 PIN
RIGHT ANGEL RECEPTACLE
3.5mm CENTER HIGH

AREA

REVISIONS

HK

DATE