

SPDT

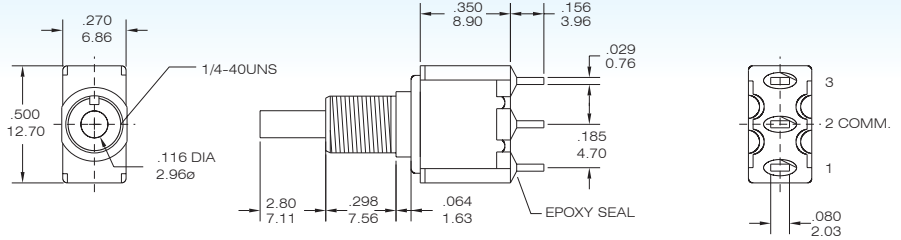

Model No.	Switching position	
L8601	on	on
L8603	on	mom
Term. Comm.	2-3	2-1

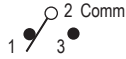

L8601-EBR-E

SPDT



Model No.	Switching position	
L8601P	on	on
L8603P	on	mom
Term. Comm.	2-3	2-1

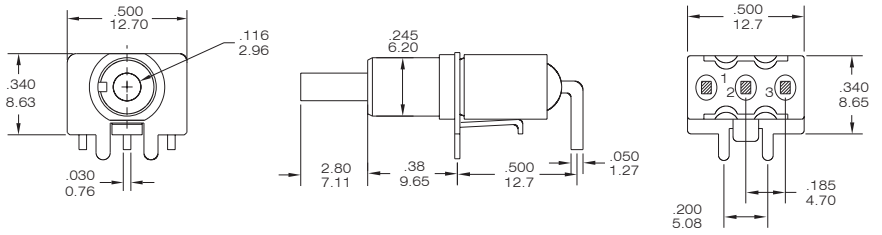
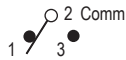

L8601P-MR-E

SPDT

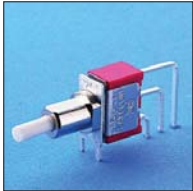

Model No.	Switching position	
L8601L	on	on
L8603L	on	mom
Term. Comm.	2-3	2-1

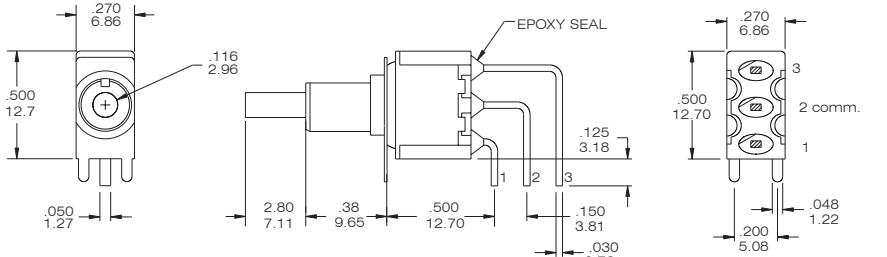
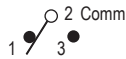

L8601L-MR-E

DPDT



Model No.	Switching position	
L8602	on	on
Term. Comm.	2-3 5-6	2-1 5-4

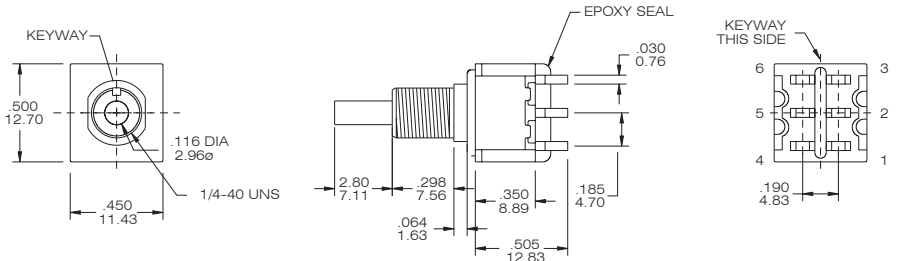

L8602-EBR-E

DPDT



Model No.	Switching position	
L8602P	on	on
Term. Comm.	2-3 5-6	2-1 5-4

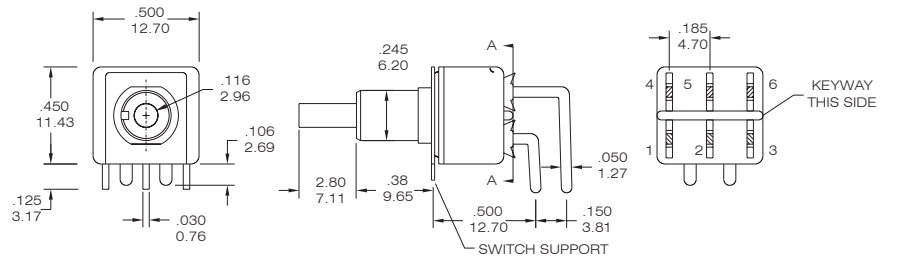

L8602P-MR-E

DPDT



Model No.	Switching position	
L8602L	on	on
Term. Comm.	2-3 5-6	2-1 5-4

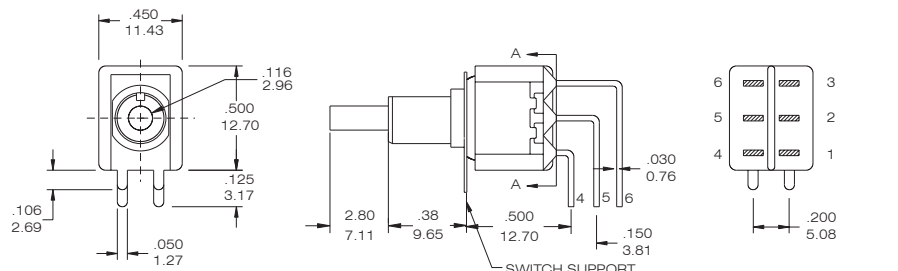

L8602L-MR-E



T80-L

Alternate Action and Momentary Pushbutton Switches



Cap and Actuator Option

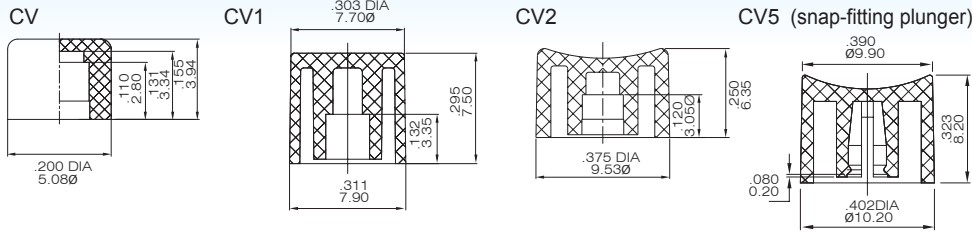

F22A

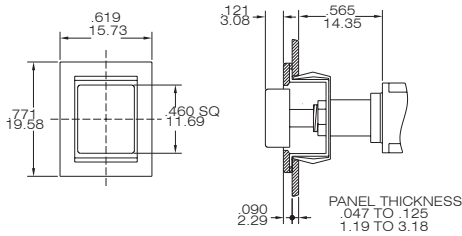

L860 * -F22A- * -BR-E

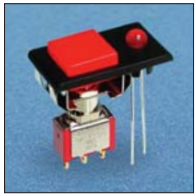

F32A

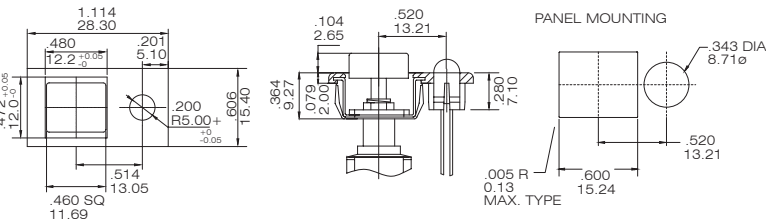

L860 * -F32A- * -BR-E

CAP & ACTUATOR OPTIONS	
1	White
2	Black(Std.)
3	Red
4	Orange
5	Yellow
6	Green
7	Blue
9	Gray

Panel Mounting

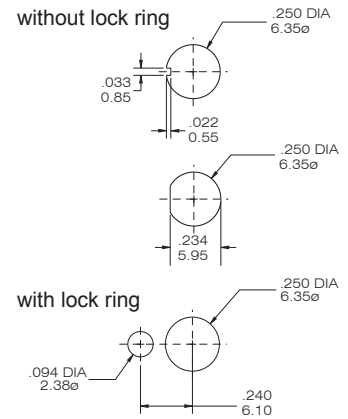

Plunger Option

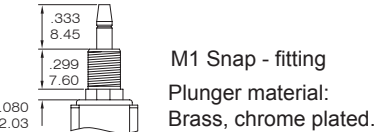
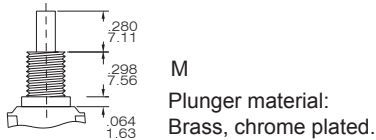
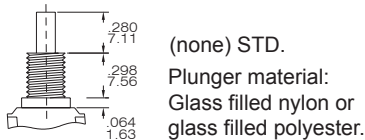

Bushing Option

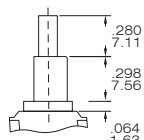
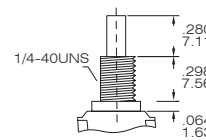
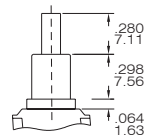
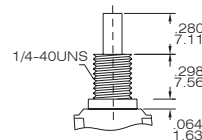
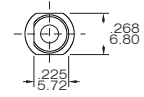
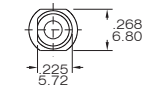
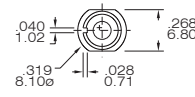
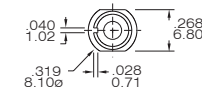

TERMINAL OPTION (ONLY FOR THE STRAIGHT TYPE L8601~L8602)

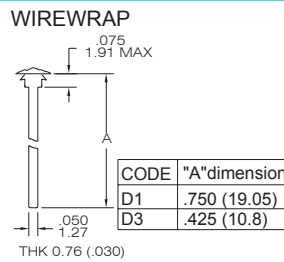
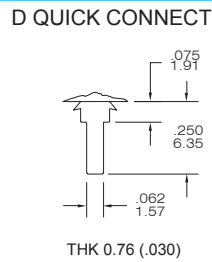
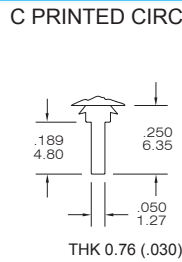
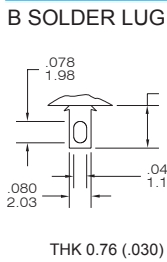

TERMINAL SEAL OPTION

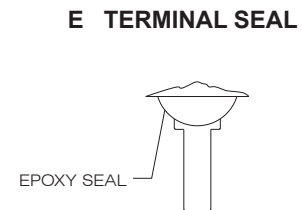

CONTACT MATERIAL OPTIONS

CODE	CONTACT MATERIAL	TERMINAL MATERIAL	RATING
Q	Silver plated	Silver plated	5A @ 125VAC or 28 VDC
R	Gold plated over nickel plated	Gold plated over nickel plated	0.4 VA MAX @ 20VAC or DC MAX
G	Gold plated over silver plated	Gold plated over silver plated	0.4 VA MAX @ 20 VAC or DC MAX or 5A @ 125VAC or 28 VDC

VERTICAL SUPPORT BRACKET OPTION

(only apply the straight type terminal . Please choose the terminal option in "c" code)

S20 / S25 / V20 / V25

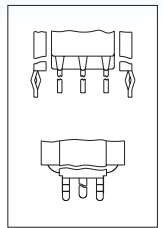
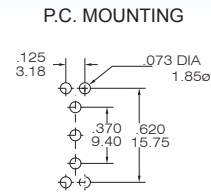
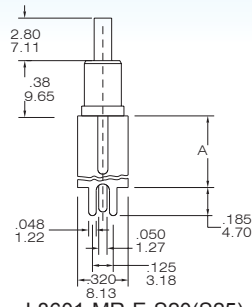
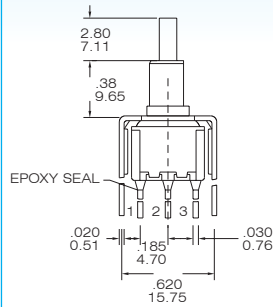

SNAP-IN
V20/ V25

L8601-MR-E-S20(S25)

option Code	A dimension
S20/V20	.460 11.68
S25/V25	.630 16.00
V20/V25: the snap-in type	

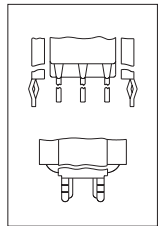
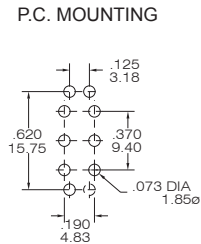
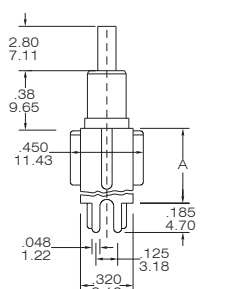
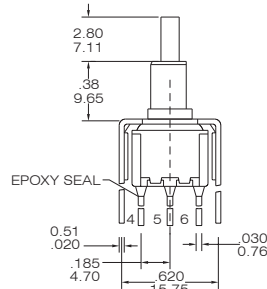

SNAP-IN
V20/ V25

L8602-MR-E-S20(S25)

S35 / S40 / V35 / V40

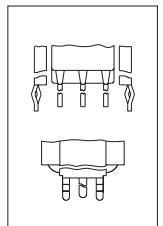
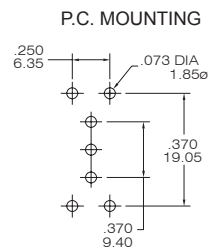
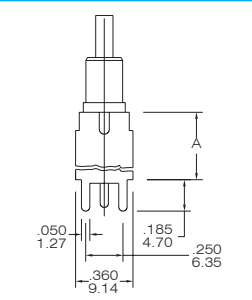
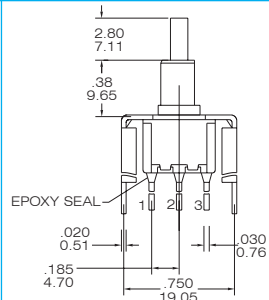

SNAP-IN
V35/ V40

L8601-MR-E-S35(S40)

option Code	A dimension
S35/V35	.460 11.68
S40/V40	.630 16.00
V35/V40 : the snap-in type	

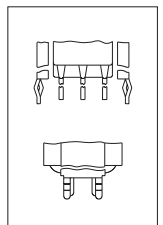
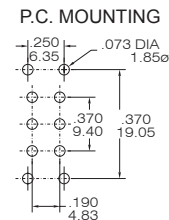
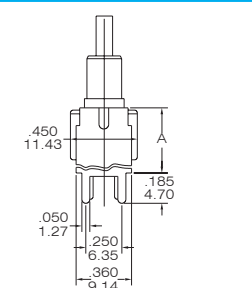
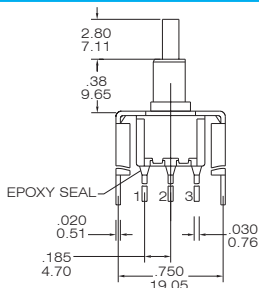

SNAP-IN
V35/ V40

L8602-MR-E-S35(S40)

The P.C.B mounting Dimensions

L8601P

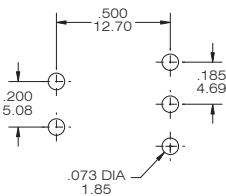

L8602P

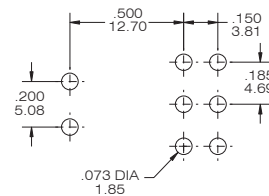

L8601L

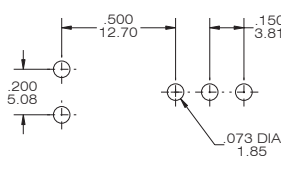

L8602L

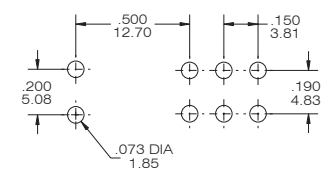

The hard ware of T80-L push button switches

STD.

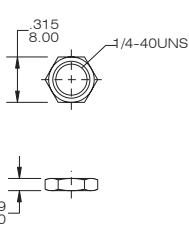

DRESS NUT

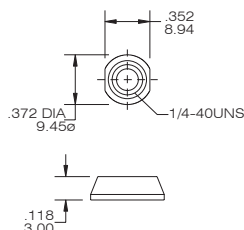

STD.

