

MATERIALS

1. HOUSING: HI-TEMP.(UL 94V-0).BLACK.
 2. TERMINAL: COPPER ALLOY(T=0.15mm),GOLD PLATED OVER NICKEL.
 3. COVER: STAINLESS STEEL(T=0.2mm)
- SPECIFICATION**
1. CURRENT RATING: 1.0 A. MAX
 2. DIELECTRIC WITHSTANDING VOLTAGE: 500V AC R.M.S. FOR ONE MINUTE.
 3. INSULATION RESISTANCE: 1000M Ω MIN. AT 500V DC.
 4. CONTACT RESISTANCE: 30m Ω MAX
 5. OPERATING TEMPERATURE: -40°C TO +85°C

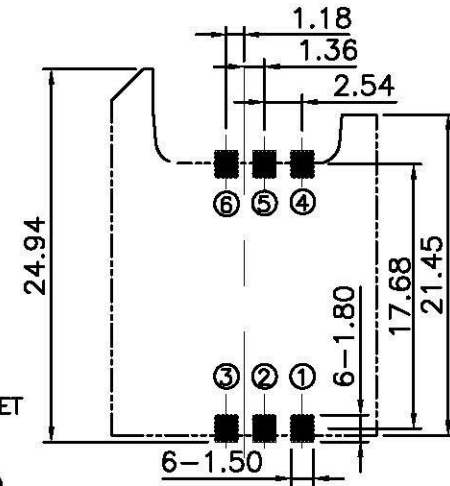
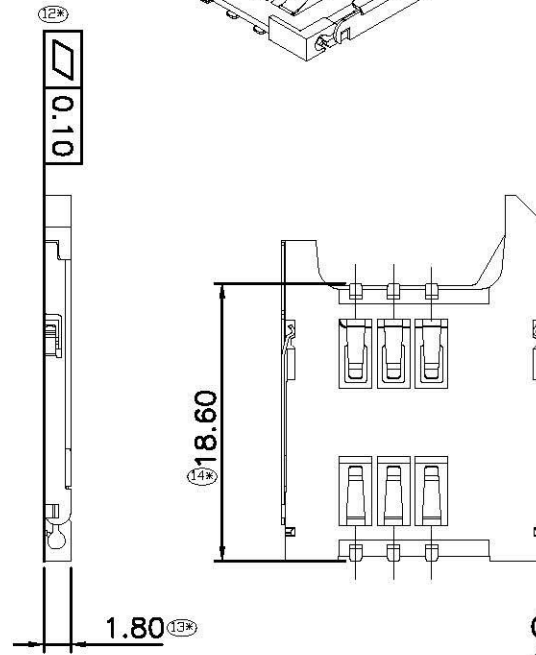
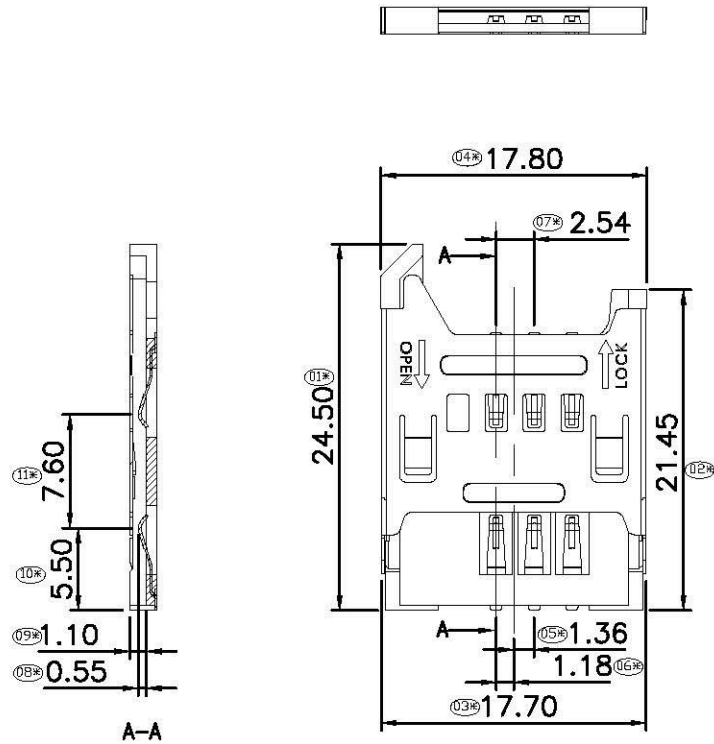

- ① VCC
- ② RESET
- ③ CLK
- ④ GND
- ⑤ VPP
- ⑥ I/O

RECOMMEND P.C.B LAYOUT
TOLERANCE ± 0.05
TOP VIEW

RoHS Compliant

All Connectors

www.allconnectors.de
Tel.: 0319 711 708008
70794 Filderstadt, Germany

info@allconnectors.de
Fax: 0319 711 708001
Kellereing. 25

DRAWING BY CY
CHECKED BY GENIUS
UNIT / mm SCALE 1 : 1
DATE
SIZE A4 PPROJECTION

TOLERANCES ARE

X \pm
X ± 0.30
.XX ± 0.25
.XXX ± 0.20
ANG $\pm 5^\circ$



ORDER INFORMATION

SCV-W1718XR-06-LF
SERIES | | | | LEADFREE
| | | | 06 WAY
| | | | REEL
90°SMT | | | | NON POST
| | | | HIGH 1.80mm
| | | | PAD TO PAD 17.68mm

DESCRIPTION: SIM Card Socket 6Pin Hinge Type H=1.8mm ,Gold Flash Plating,Without Peg

END

Start

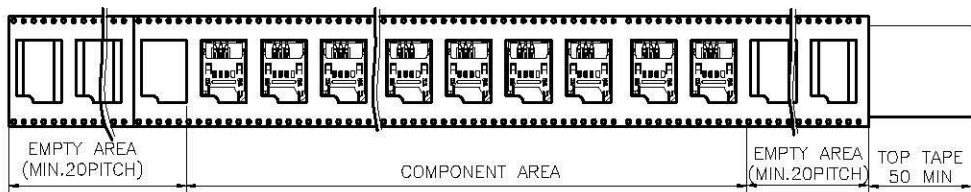

PEEL STRENGTH OF COVER TAPE:10~70g
 peeling speed:300mm/minute
 peeling angle:165to180degrees

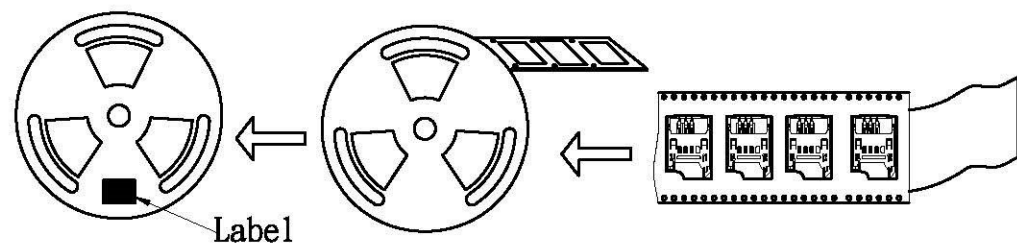
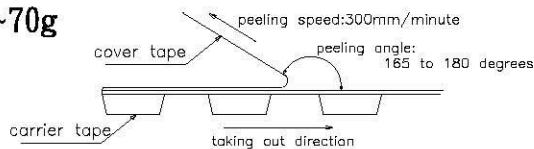

PACKAGING SPECIFICATION:

1. MATERIAL

- 1.1 Embossed Carrier Tape: PS Black
- 1.2 Top Cover Tape: PET 10-70g(Peel Speed 300mm/Minute)
- 1.3 Taping Reel: Plastic

2. PACKING

- 2.1 Quantity: 1000Piece/Reel

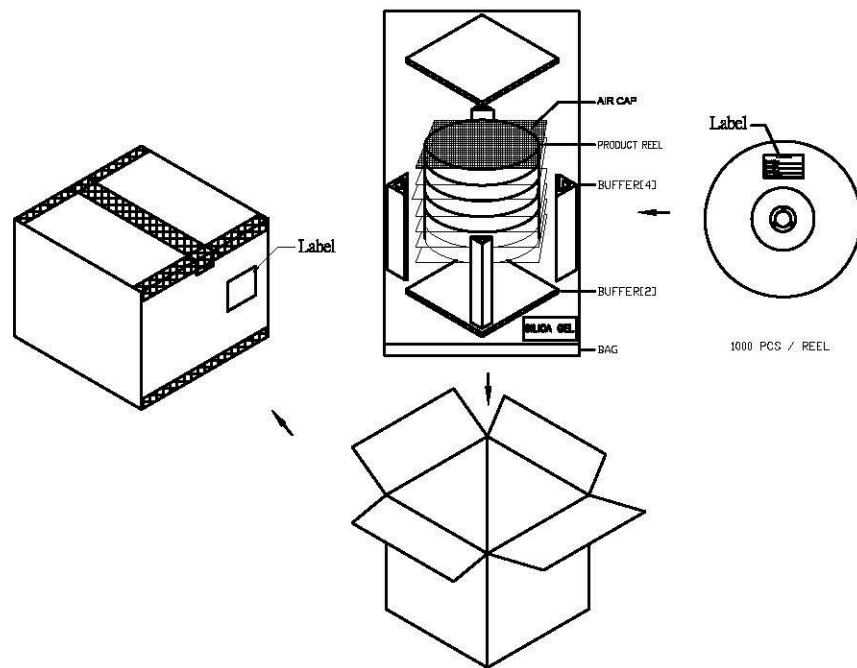

All Connectors

www.allconnectors.de
 Tel.: 0049 711 7009503
 70794 Filderstadt - Germany

inm@allconnectors.de
 Fax: 0049 711 7009504
 Kettenstr. 25

RoHS Compliant

DRAWING BY CY
 CHECKED BY GENIUS
 UNIT / mm SCALE 1 : 1
 DATE
 SIZE A4

TOLERANCES ARE

X ±
 .X ± 0.30
 .XX ± 0.25
 .XXX ± 0.20
 ANG ± 5°



ORDER INFORMATION

SCV-W1718XR-06-LF
 SERIES | | | | LEADFREE
 | | | | 06 WAY
 | | | | REEL
 90°SMT | | | | NON POST
 | | | | HIGH 1.80mm
 | | | | PAD TO PAD 17.68mm

DESCRIPTION: SIM Card Socket Hinge Type H:1.8mm