

WITHOUT CARD

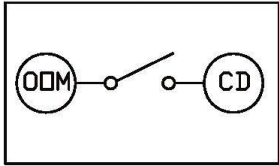

CARD INSERTED

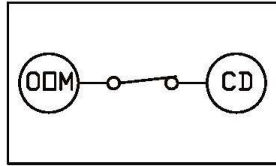

CARD DETECT SW. STATUS.

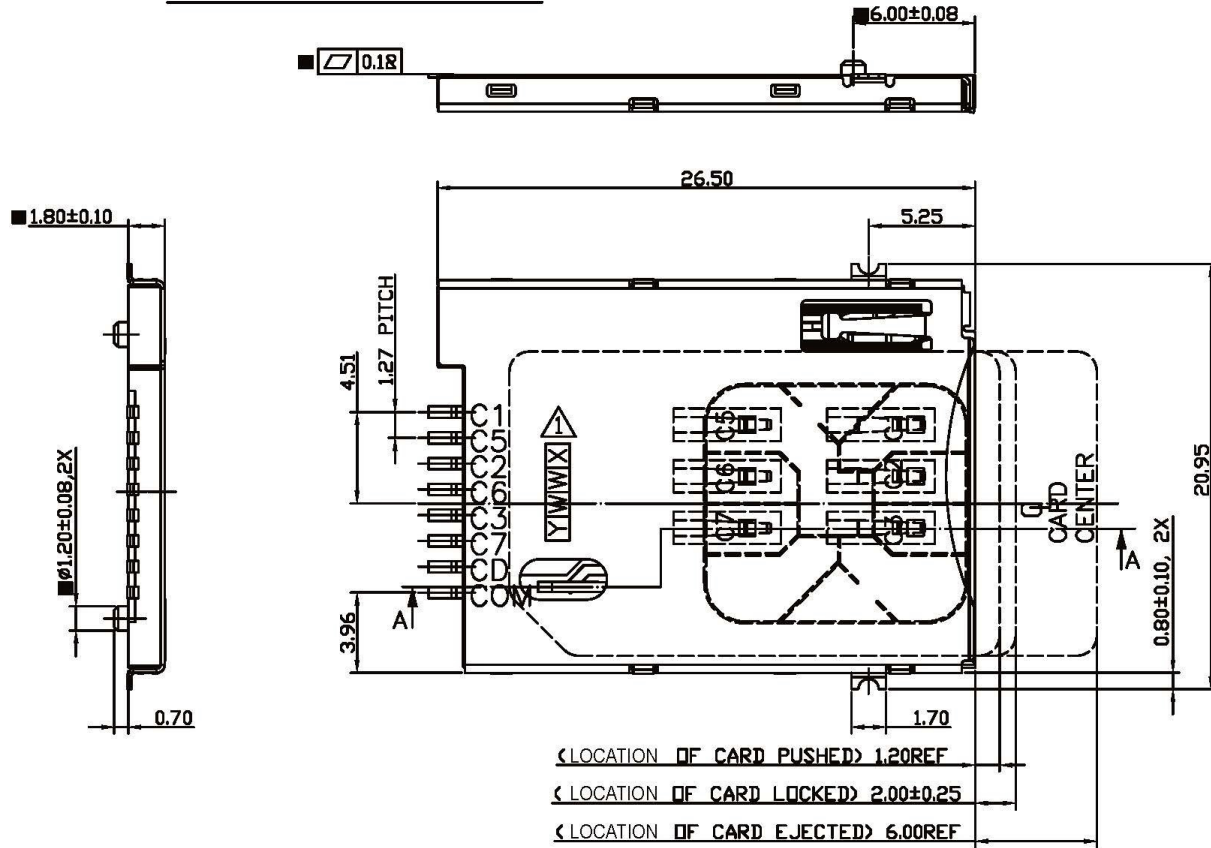

- NOTES:
1. MATERIAL:
HOUSING: LCP+30% G.F., UL 94V-0 RATED, COLOR BLACK.
CONTACTS: COPPER ALLOY.
SHIELD COVER: SUS304, 0.2T.
 2. PLATING:
CONTACT AREA: HARD GOLD PLATING OVER 1.27 μm (50 $\mu\text{Å}$) MIN, NICKEL UNDERPLATING.
SOLDERING ZONE: 3.05 μm (120 $\mu\text{Å}$) MIN. 100% TIN, OR LEAD-FREE PLATING PER PART NUMBER DESIGNATION, OVER NICKEL UNDERPLATING.
SHIELD COVER: GOLD FLASH NICKEL UNDERPLATING.
UNDERPLATING: 1.27 μm (50 $\mu\text{Å}$) MIN. NICKEL ALLOY.
 3. CUTTING BURR ALLOWED: 0.03mm MAX.
 4. THE DIMENSIONS MARKED WITH '■' ARE CRITICAL DIMENSIONS.
 5. COPLANARITY IS 0.10mm MAX.
 6. RoHS COMPLIANT PRODUCTS.
 7. DATE CODE MARKING:

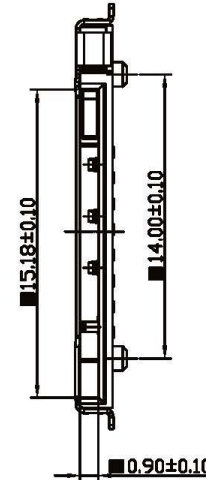

PARTS LIST

ITEM	DESCRIPTION	QTY (PC'S)
1	HOUSING	1
2	SLIDER	1
3	MAIN OCONTACT	1
4	ODM OCONTACT	1
5	CD OCONTACT	1
6	METAL COVER	1
7	CRANK	1
8	SPRING	1

RoHS Compliant

All Connectors

www.allconnectors.de info@allconnectors.de
Tel.: 0049 711 7009503 Fax: 0049 711 7009504
70794 Filderstadt - Germany Kettenerstr. 25

DRAWING BY CY
CHECKED BY GENIUS
UNIT/mm SCALE 1:1
DATE
SIZE A4

TOLERANCES ARE

X ±
.X ±
.XX ±
.XXX ±
ANG ±

PJECTION

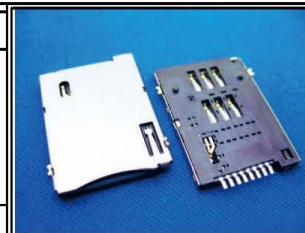

ORDER INFORMATION

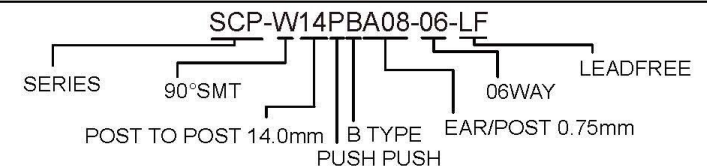

DESCRIPTION: SIM Card Socket 6+2 Pin Push-Push Type

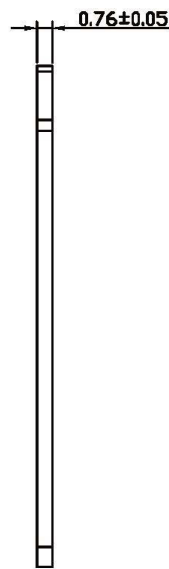
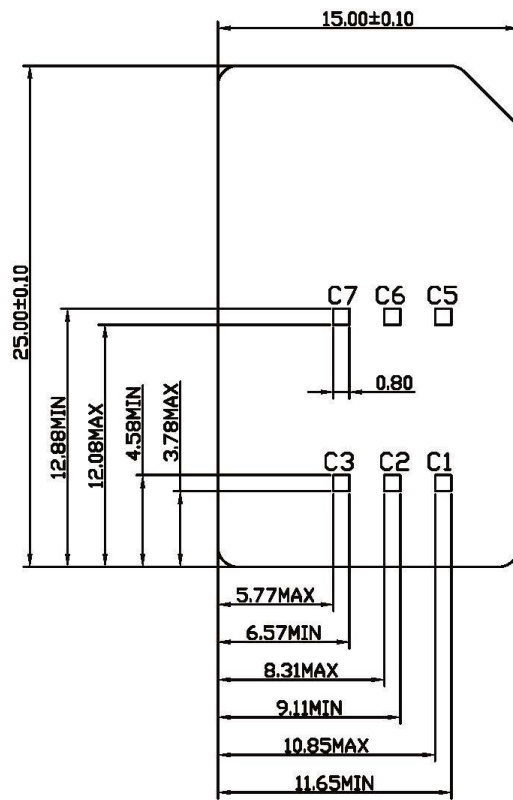

APPLICABLE CARD SIZE

- C1 Supply voltage(VCC)
- C2 Reset(RST)
- C3 Clock(CLK)
- C4 Not used
- C5 Ground(GND)
- C6 RFU²
- C7 Input/output(I/O)
- C8 Not used

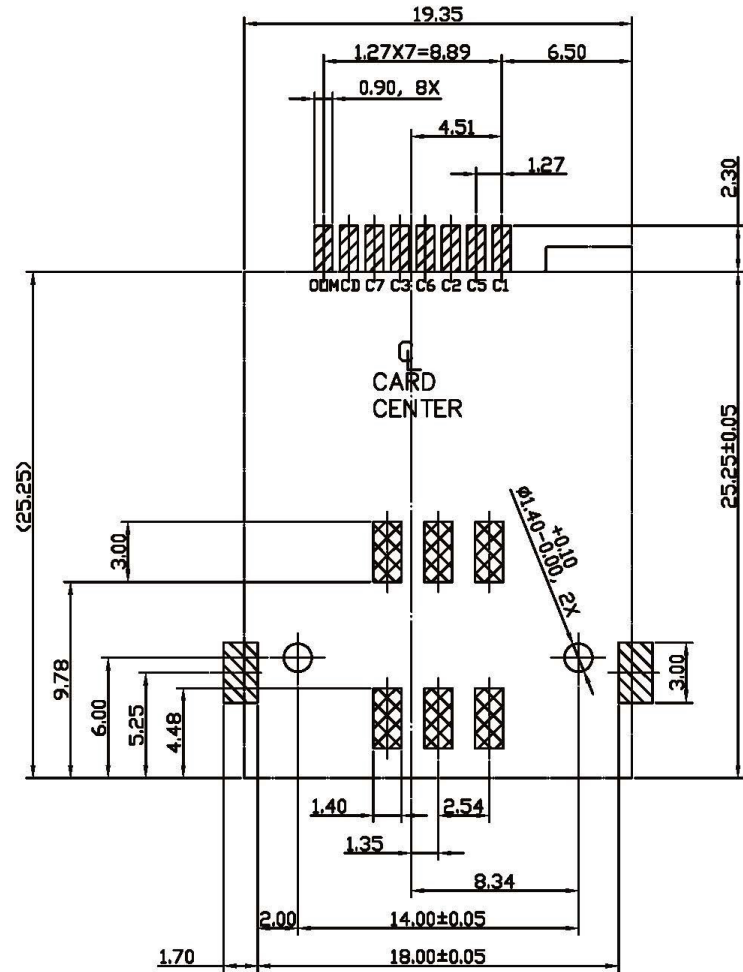

RECOMMENDED PCB LAYOUT

▨ — TRACR PROHIBITION AREA

		RoHS Compliant		TOLERANCES ARE	
		DRAWING BY CY	CHECKED BY GENIUS	X ±	X ±
www.allconnectors.de Tel.: 0049 711 7009503 70794 Filderstadt - Germany	info@allconnectors.de Fax: 0049 711 7009504 Kettenerstr. 25	UNIT/ mm	SCALE 1 : 1	.XX ±	.XXX ±
DATE		SIZE A4		PROJECTION	

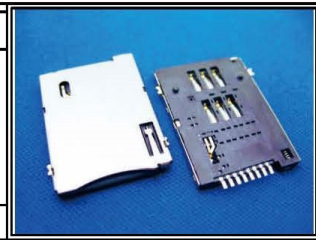

ORDER INFORMATION					
SCP-W14PBA08-06-LF					
SERIES	90°SMT		06WAY	LEADFREE	
POST TO POST 14.0mm			B TYPE	EAR/POST 0.75mm	
PUSH PUSH					

DESCRIPTION: