

**MATERIALS:**

- \*PIN: COPPER.NICKEL PLATED
- \*HOUSING: BAKELITE.
- \*BODY:ZINC.NICKEL PLATED.

**ELECTRIC CHARACTER**

- Rated current: 5A 125V
- Operation Limit Voltage: 200V AC
- Insulation Resistance: 100M OHM Min. at DC 500V
- Contact Resistance: 10m OHM Max. at DC 1A

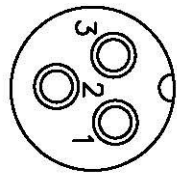
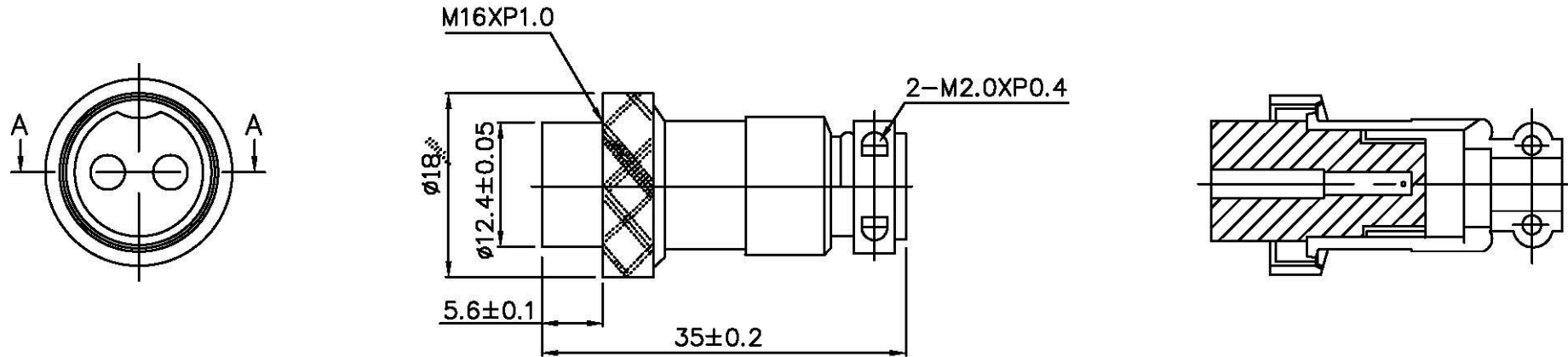

3P

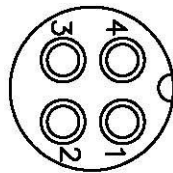

4P

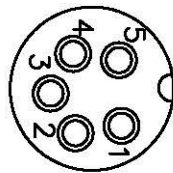

5P

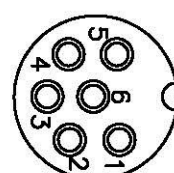

6P

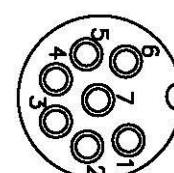

7P

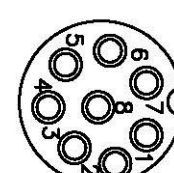

8P

RoHS Compliant

**All Connectors**

www.allconnectors.de  
Tel: 0049 71 709300  
70794 Filzschadt - Germany

info@allconnectors.de  
Fax: 0049 71 709304  
Kettnerstr. 25

DRAWING BY CY	
CHECKED BY GENIUS	
UNIT / mm	SCALE 1 : 1
DATE	
SIZE A4	P PROJECTION

TOLERANCES ARE

- X ±
- .X ±
- .XX ±
- .XXX ±
- ANG ±



ORDER INFORMATION

XLR-SA-xx-LF  
SERIES | T LEADFREE  
03-08WAY  
ASSEMBLY  
FEMALE

DESCRIPTION: