

REMARK : RoHS REQUIREMENT APPLIED  
(符合RoHS)

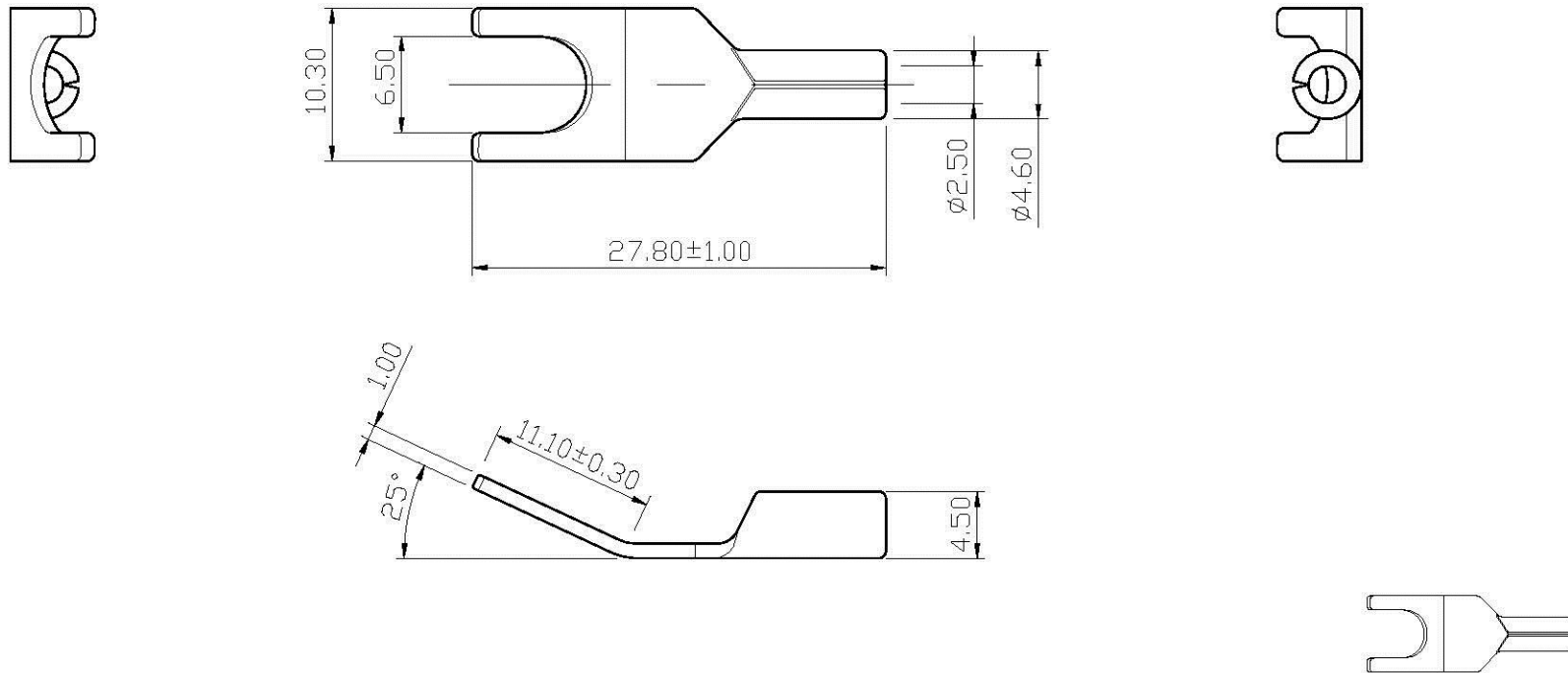

S 1 : 1

7						DIMENSIONS ARE IN MILLIMETERS  UNLESS OTHERWISE PECIFIED TOLERANCES (一般公差) 0.5~6 = ±0.2 >6~30 = ±0.4 >30~120 = ±0.6 >120~315 = ±1 >315~1000 = ±1.6 ANGLES(角度) = ±5°	APPROVED	 www.allconnectors.de Tel.: 0049 711 7009204 70794 Eilderstadt, Germany info@allconnectors.de Fax: 0049 711 7009204 Kellernstr. 25	
6					CHECKED		TITLE		
5							CABLE TERMINAL		
4							DRAWN	DRAWING NO.	
3							<i>Lala</i>	CT-264G-6.5-25-2.5	
2							DATE	FILE NO.	
1	body	1	copper	gold			2008. 03. 05	DRAW\AUDIO\CT\CT-264G-6.5-25-2.5	
NO.	Description	Unit	Materials	Finish	Drawing No.	SCALE	2 : 1	UNIT	MM