

REMARK : RoHS REQUIREMENT APPLIED
(符合RoHS)

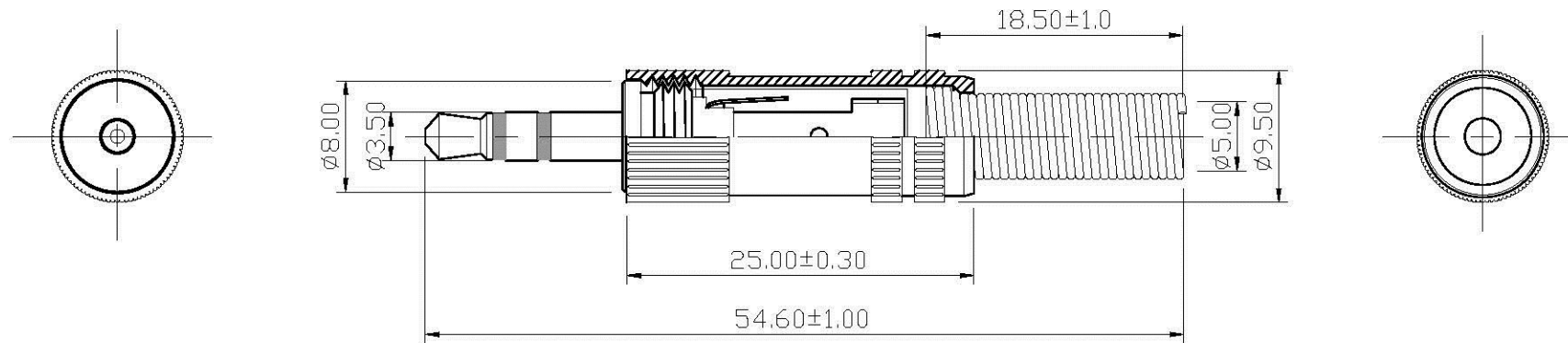

S 1 : 1

-	spring	1	iron	gold	
-	sleeve	1	pvc	transparent	
-	insulator	2	POM	black	
-	solder tab	1	brass	gold	
-	solder tab	1	brass	gold	
-	clip	1	brass	gold	
-	insulator	2	POM	white	
-	shell	1	brass	gold	
-	contact pin	1	brass	gold	
-	body	1	brass	gold	
-	body	1	brass	gold	
-	body	1	brass	gold	
NO.	Description	Unit	Materials	Finish	Drawing No.

DIMENSIONS ARE IN
MILLIMETERS

UNLESS OTHERWISE PECIFIED
TOLERANCES
(一般公差)
0.5-6 = ±0.2
>6-30 = ±0.4
>30-120 = ±0.6
>120-315 = ±1
>315-1000 = ±1.6
ANGLES(角度) = ±5°

SCALE 2 : 1 UNIT MM

APPROVED

CHECKED

DRAWN

Lala

DATE

2007. 12. 28

All Connectors

www.allconnectors.de
Tel: 0049 (0) 71 7005003
70754 Filderstadt, Germany

info@allconnectors.de
Fax: 0049 (0) 71 7005001
Kellernstr. 25

TITLE

AUDIO PLUG

DRAWING NO.

AP3.5-251GG-Stereo-5.0

FILE NO.

DRAWINGAUDIOVAPAP3.5-251GG-Stereo-5.0