

## JMD83A POWER CONNECTOR

[Back to product list](#)

### Type

The Male Connector: JMD-83AZ

The Female Connector: JMD-83AT



### Operating Environment

Operating Temperature	-55 to + 125 °C
Relative Humidity	98% (40 °C)
Vibration	10 to 2,000Hz (a = 147m/s <sup>2</sup> )
Shock	Acceleration 980m/s <sup>2</sup>

### Main Technical Specifications

Insulation Resistance		≥ 1,000MΩ			
Mechanical Life		1,000 times			
Housing Material		PET G30 UL94V-0 Black			
Contact	Spec.	Signal Contact	Power Contact		
		#20	#8	#4	
	Quantity	68	9	6	
	Rated Current	5A	75A	125A	
	Rated Voltage	50V	400V	600V	
	Contact Resistance	≤5.0mΩ	≤0.75mΩ	≤0.66mΩ	
	Withstand Voltage	1,000V	2,000V	3,000V	
	Surface Material	Gold plated over nickel		Silver plated over nickel	
	Terminal Style	#20: Crimping, PCB Tail, Solder Cup; #8 and #4: Crimping			
	Material	Pin and Socket	Brass or copper		
Crown Spring		Beryllium bronze			

External Sizes and Installation Dimensions (mm)

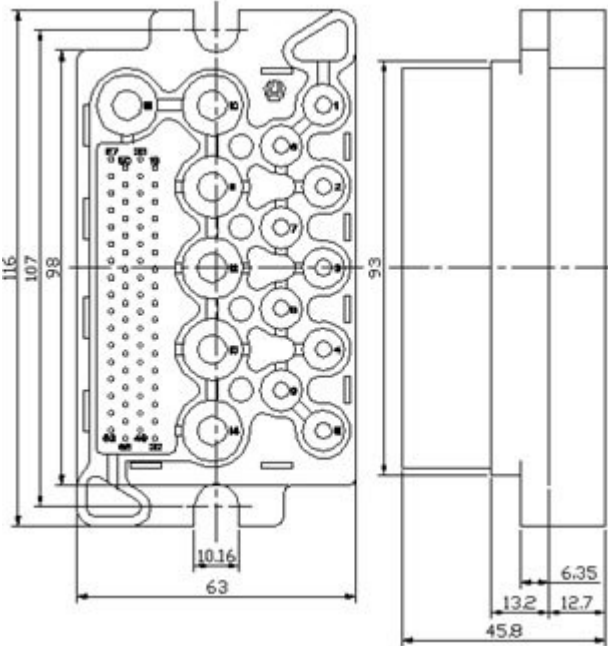

JMD-83AZ

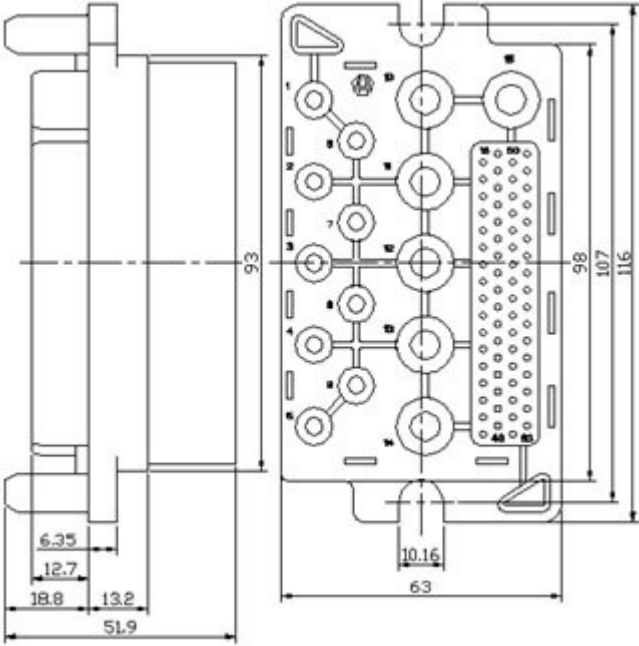

JMD-83AZ