

JMD4 POWER CONNECTOR

[Back to product list](#)

Type

The Male Connector: JMD-4Z

The Female Connector: JMD-4T



Operating Environment

Operating Temperature	-55 to + 125 °C
Relative Humidity	98% (40 °C)
Vibration	10 to 2,000Hz (a = 147ms ²)
Shock	Acceleration 980ms ²

Main Technical Specifications

Insulation Resistance		≥ 1,000MΩ
Mechanical Life		1,000 times
Housing Material		PET G30 UL94V-0 Black
Contact	Spec.	Power Contact
		#0
	Quantity	4
	Rated Current	150A
	Contact Resistance	≤0.32mΩ
	Withstand Voltage	1,500V
	Surface Material	Silver plated over nickel
	Terminal Style	Crimping, Internal Thread, External Thread
Material	Pin and Socket	Brass or copper
	Crown Spring	Beryllium bronze

External Sizes and Installation Dimensions (mm)

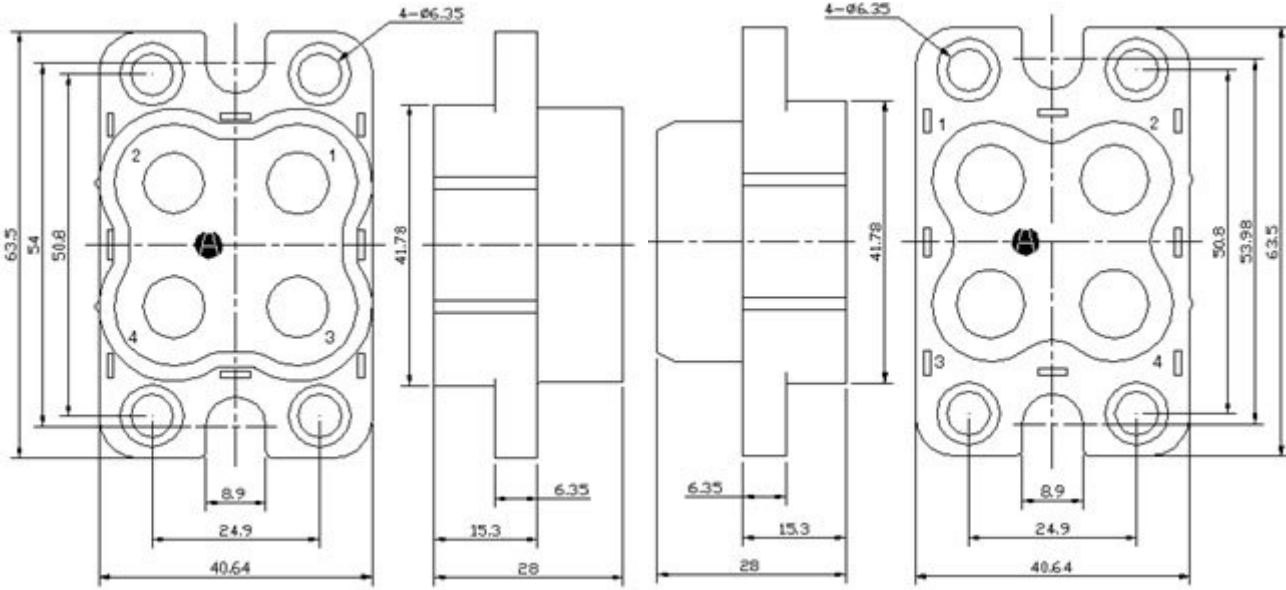

JMD-4Z

JMD-4T