

## JMD40 POWER CONNECTOR

[Back to product list](#)

### Type

The Male Connector(with pins): JMD-40Z1

The Female Connector(with sockets): JMD-40T1

### Operating Environment

Operating Temperature	-55 to + 125 °C
Relative Humidity	98% (40 °C)
Vibration	10 to 2,000Hz (a = 147m/s <sup>2</sup> )
Shock	Acceleration 980m/s <sup>2</sup>



### Main Technical Specifications

Insulation Resistance		≥ 1,000MΩ		
Mechanical Life		1,000 times		
Housing Material		PET G30 UL94V-0 Black		
Contact	Spec.	Signal Contact	Power Contact	
		#20	#12	#4
	Quantity	32	6	2
	Rated Current	5A	35A	125A
	Contact Resistance	≤5.0mΩ	≤1.0mΩ	≤0.66mΩ
	Withstand Voltage	1,000V	1,500V	1,500V
	Surface Material	Gold plated over nickel	Silver plated over nickel	
	Terminal Style	#20 and #12: Crimping, PCB Tail, Solder Cup #4: Crimping, Internal Thread, External Thread		
Material	Pin and Socket	Brass or copper		
	Crown Spring	Beryllium bronze		

External Sizes and Installation Dimensions (mm)

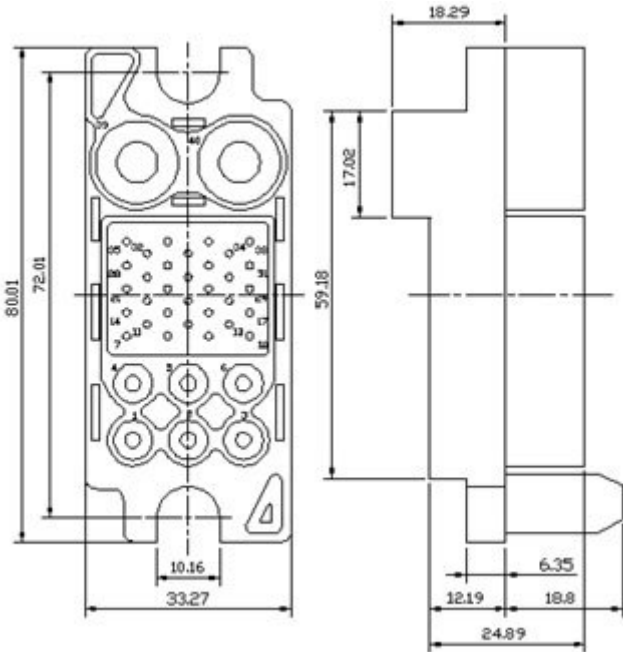

JMD-40Z1

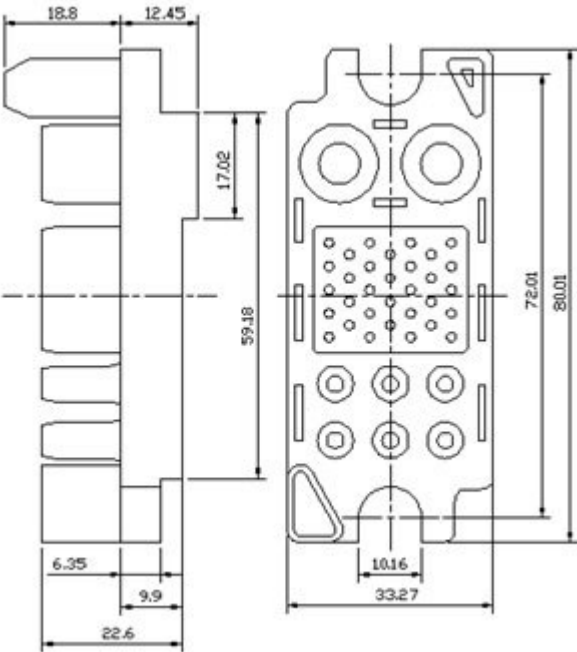

JMD-40T1