

| REV. | DESCRIPTION | ECN NO. | DATE | DRAWER |
|------|-------------------------|-----------|------------|--------|
| E | Add Amount of Pins | EC0605053 | 06/01/2006 | Aaron |
| F | Modified Amount of Pins | EC0610024 | 10/24/2006 | Aaron |
| G | Added New Type. | EC0612041 | 12/27/2006 | Jeff |

Notes:

- Material :
Housing : Thermoplastic UL 94V-0 , Black
Terminal : Copper Alloy
Cap : Stainless Steel
- Finish :
Terminal : 20u" Min. Gold over 50u" Min. Ni
Under-plated Overall
Cap : Source Material
- Order Information :

T PEO-012 X 0-02 X 6
T : RoHS(for High Temperature)

Amount of Pins :

- 3 : 6 Pins
- 9 : 18 Pins
- A : 20 Pins
- D : 26 Pins

Amount of Pins :

- T : Tube
- 1 : Cap + Tube
- 2 : Cap + Reel(For 20Pins Type)

Dimension Information:

| Part No. | Dim. | Amount of Pins | Dim.A | Dim.B | Dim.C | Dim.D |
|-----------------|------|----------------|-------|-------|-------|-------|
| TPE0-01230-02T6 | 6 | 6 | 12.70 | 10.16 | 5.08 | 6.35 |
| TPE0-01290-02T6 | 18 | 18 | 27.94 | 25.40 | 20.32 | 13.97 |
| TPE0-012A0-02T6 | 20 | 20 | 30.48 | 27.94 | 22.86 | 15.24 |
| TPE0-012D0-02T6 | 26 | 26 | 38.10 | 35.56 | 30.48 | 19.05 |

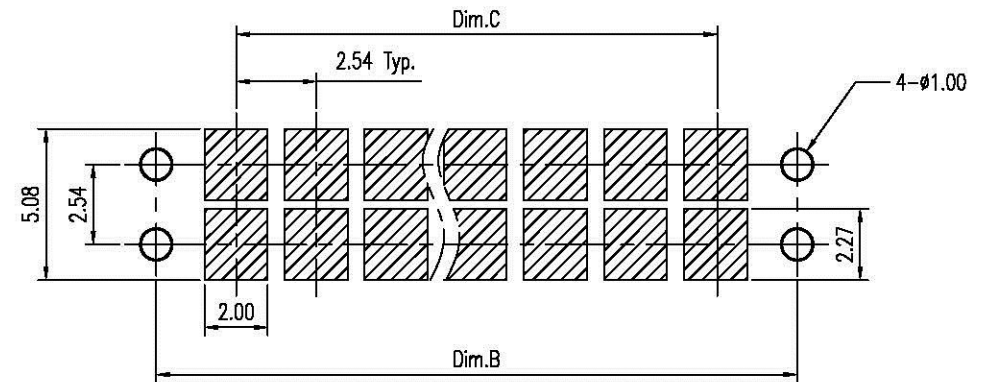
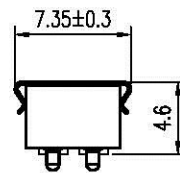
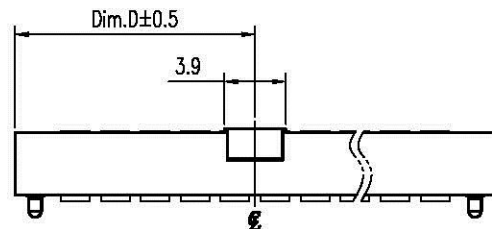
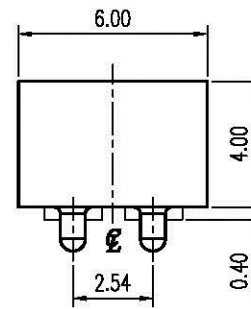
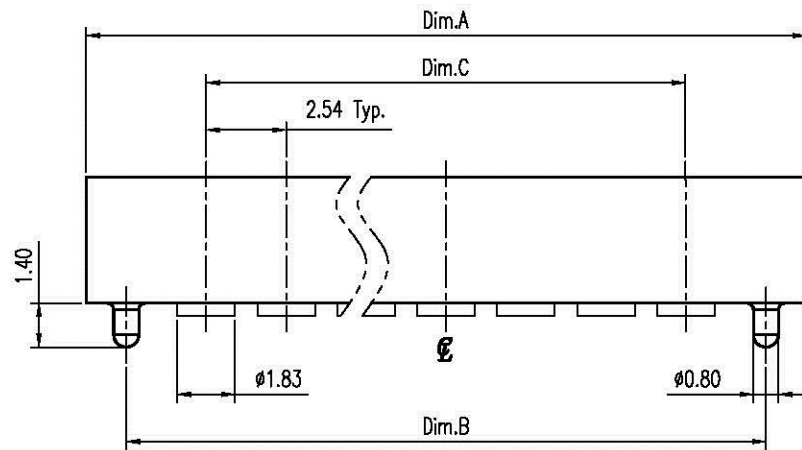
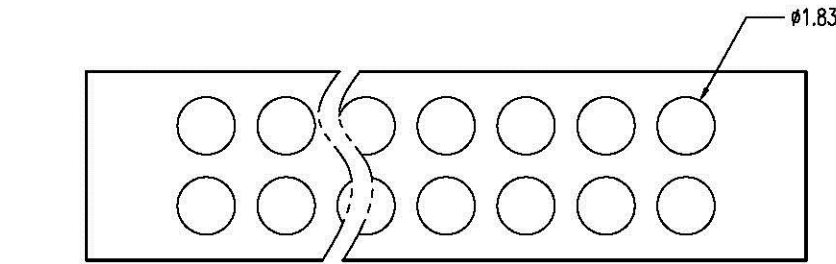

Recommended P.C.B. Layout
Layout Tolerance = ± 0.05 mm

With Cap
Scale 2:1

| DIMENSION IN mm [inch] | | All Connectors | Title 2.54mm Pitch SMT Conn. Female Dual Row Type | Scale: 4 : 1 | |
|--------------------------------------|------------|---|---|-----------------|-------------------------|
| Tolerance unless otherwise specified | | | | | |
| X. ± | X." ± 10' | www.allconnectors.de info@allconnectors.de Tel.: +49 711 3095305 70721 Filderstadt - Germany | Dwg No. TPE0-012X0-02X6 | Size: A 4 | |
| X.X ± 0.38 | X.X' ± 5' | | CUSTOMER DRAWING | File No. P03033 | Rev : G |
| X.XX ± 0.25 | X.XX' ± 2' | | Approver: | Checker: | Drawer: Jeff |
| X.XXX ± 0.13 | X.XXX' ± | | | | 12/27/2006 Sheet: 1 / 1 |