

### Specifications

Current Rating: 2Amp  
 Insulation Resistance: 1000MΩ Min.  
 Dielectric Withstanding: 500V AC/DC  
 Contact Resistance: 20mΩ Max.  
 Operating Temperature: -40°C to +105°C

### Materials

Contact Material: Copper Alloy  
 Insulation Material: Polyester, UL 94V-0  
 NYLON-6T

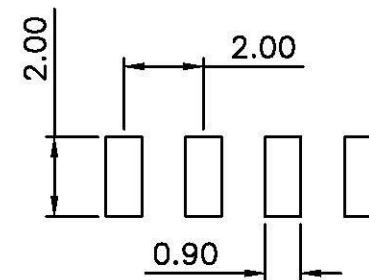
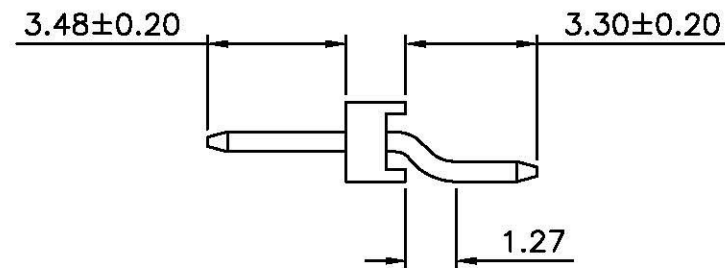

Recommended P.C.Board

RoHS Compliant

**All Connectors**

www.allconnectors.de info@allconnectors.de  
 Tel: 0049 711 704910 Fax: 0049 711 704914  
 70794 Filzbergstr. 6 Germany Bellenstedt 1, 25

DRAWING BY CY  
 CHECKED BY GENIUS  
 UNIT / mm SCALE 1 : 1  
 DATE  
 SIZE A4 PROJECTION

TOLERANCES ARE

X ±  
 .X ± 0.38  
 .XX ± 0.25  
 .XXX ± 0.13  
 ANG ±

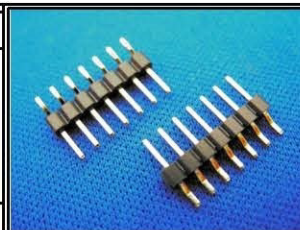

ORDER INFORMATION

M-WX-1Xxx-LF  
 SERIES | LEADFREE  
 1X02:02WAY  
 1X40:40WAY  
 NON POST  
 90°SMT

DESCRIPTION: 2.0 PIN HEADER SINGLE ROW SMT TYPE BASE 1.5H