

REV.	ECN.NO.	DATE
A	RELEASED	10/04/04
B	Revise Post	10/11/04
C	Add Color	03/30/07

NOTES

*Material

Body : NYLON46+30%G.F
 UL 94V-0 Rated.Color: White or Black Orange
 CAV.No: A~H
 Contacts : Brass or Phosphor Bronze
 Plating: Gold plating over Nickel on contact Area; Tin plating on Solder tail.

*Mechanical:

Insertion Force: 1.15N max per contact pair;
 Withdrawal Force: 0.15N min per contact pair;
 Contact Retention Force: 4.9N min per contact;

*Electrical Specification

Contact Resistance : 30 Milliohms Max.
 Current Resistance : 1.1 Ampere
 Insulation Resistance : 1000 Megohms Min, At 500V AC.
 Operating Temperature : -55°C to +105°C

*How to order:

Series NO. WPES-064 A N4 1 B 2 2 U S
 Number of Contacts
 Gold A:Flash B:5u" C:10u"
 D:15u" E:20u" F:30u"
 N:Nylon66 B:PBT N4:Nylon46
 3:White 1:Black
 G:Orange (1485C)
 S:Subtract
 U:Lead Free
 Blank:Sn Pb
 2:Plastic Posts
 2:Pin Length 2.5mm
 3:Pin Length 3.0mm
 B:Brass
 P:Phosphor Bronze

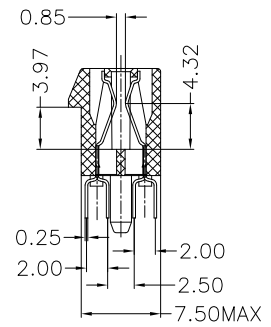
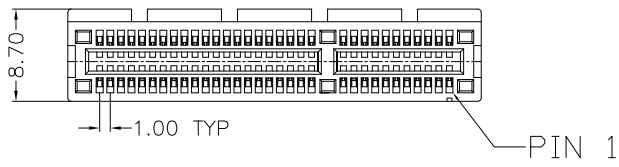

Unit:mm

Part Number	Dim`A`
WPES-064AN41B22UWS	2.5mm
WPES-064AN41B32UWS	3.0mm

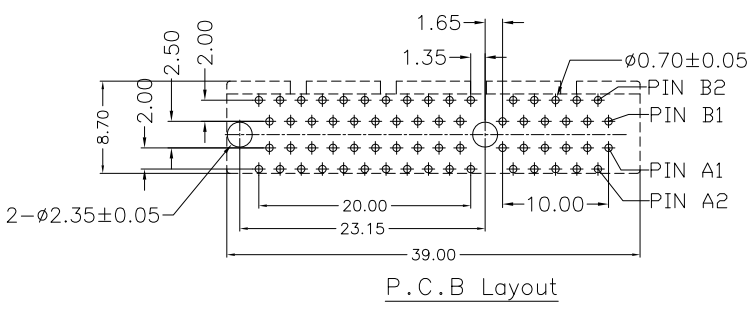
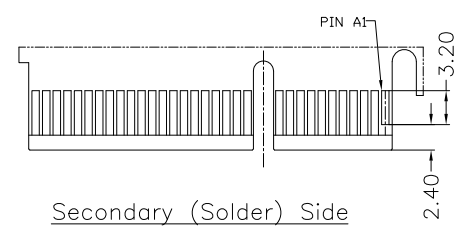
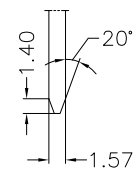
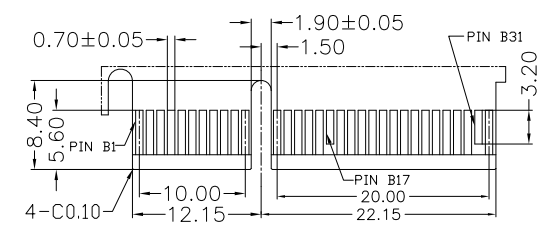
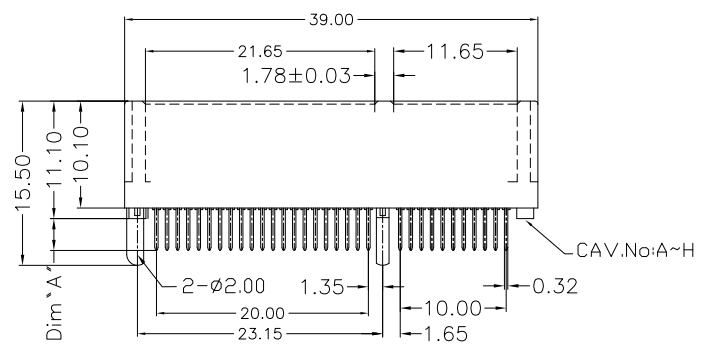

REV	Add Color	Units	mm	Scale	Drawing By	Data	Allconnectors		
		Tolerance Unless Otherwise Specified			LULU	03.30.07	www.allconnectors.eu info@allconnectors.eu Tel. +49 (0)711 / 358 110 20 Fax +49 (0)711 / 358 110 25		
		.X	~	±0.38	Reviewed By	Data	Date	01/23/08	Title PCI EXPRESS 64Pin Strop Form Pin Plastic Posts (Subtract)
		.XX	~	±0.25	Roger	03.30.07	Sheet	1 of 1	
		.XXX	~	±0.20	Approval By	Data	Third Angle Projection		
		Angle	~	± 3°	Richard	03.30.07	Drawing No. WPES-064PS-AN-W040 REV C		