

REV.	ECN.NO.	DATE
A	RELEASED	02/25/08

Notes:

***Material**

Body : Nylon46+30%G.F or Nylon66+30%G.F,
UL 94V-0 Rated.

Color: Black

Contacts : Brass

Plating: Gold plating over Nickel on contact
area; Tin plating on Solder Tail.

***Mechanical:**

Insertion Force: 1.15N max per contact pair;
Withdrawal Force: 0.15N min per contact pair;
Contact Retention Force: 3.43N min per contact;

***Electrical Specification**

Contact Resistance : 30 Milliohms Max.
Current Resistance : 1 Ampere
Insulation Resistance : 1000 Megohms Min, At 500V AC.

***Environmental**

Operating Temperature : -55°c to +105°c

***How to order:**

WPES-026 A N4 1 B 1 1 U S

S: Subtract
U: Lead Free
1: None Posts
1: Solder 2.1mm
2: Solder 2.5mm
B: Brass
1: Black
N4: Nylon46
N: Nylon66
Selective Gold A: Flash
Number of contacts

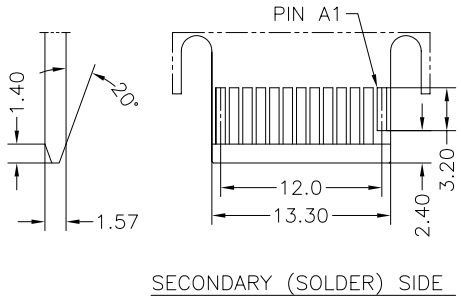
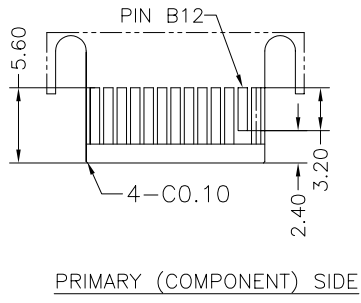
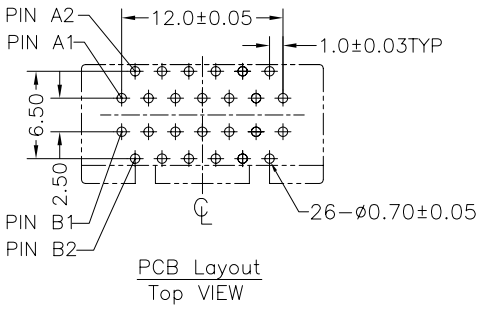
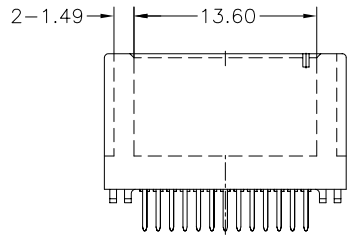
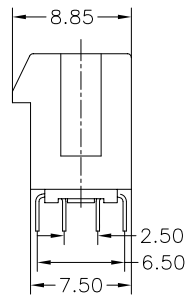
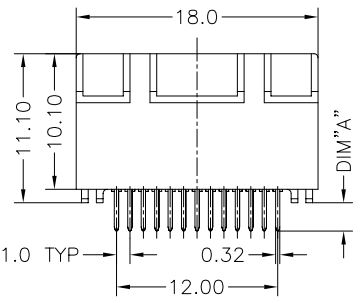
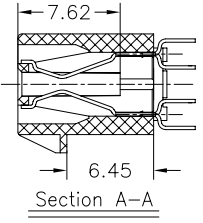
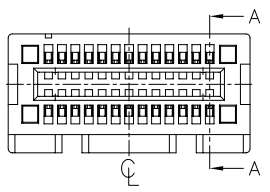

Type	Dim 'A'
Solder2.1mm	2.10mm
Solder2.5mm	2.50mm

REV	Units	mm	Scale	16:1	Drawing By	Data
					ZH	02/25/08
	Tolerance Unless Otherwise Specified				Reviewed By	Data
	.X	~ ±0.38		ZYZ	02/25/08	
	.XX	~ ±0.25		Approval By	Data	
	.XXX	~ ±0.20		Richard	02/25/08	
	Angle	~ ± 3°				

Allconnectors
www.allconnectors.eu | info@allconnectors.eu
Tel: +49 (0)711 / 358 110 20 | Fax: +49 (0)711 / 358 110 25

Date	02/25/08	Title	PCI EXPRESS CONNECTOR		
Sheet	1 of 1		Strip Form Pin 26P None Posts		
Third Angle Projection			Drawing No	WPES-026PS-AN-W107	REV