

TYPE	CONTACT NO.	L
DETECT	36 ,67	3.5
GENERAL	OTHERS	4.25
POWER	1,17,34,35,51,68	5.0

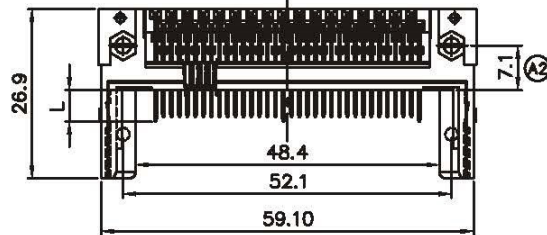
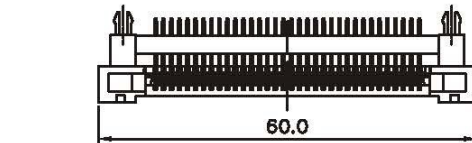

**Material:**

Housing: 30% Glass filled LCP UL94V-0.  
Contacts: Brass.

**Electrical Characteristics:**

Current Rating: 0.5 AMP.  
Dielectric Withstanding Voltage: AC 1000V For 1 minute.  
Insulator Resistance: 1000MΩmin. at DC 500V.  
Contact Resistance: 30mΩmax. at DC 100mA.  
Operating Temperature: -55°C~+105°C.

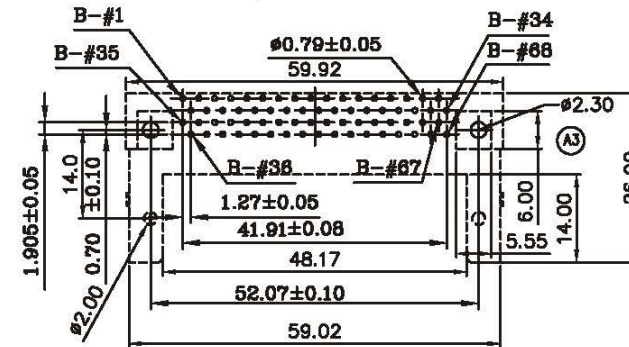
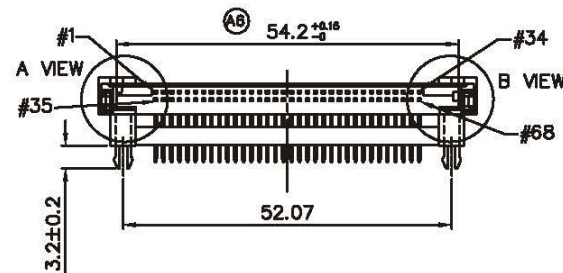
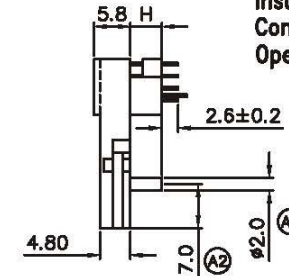

P.C. Board Layout

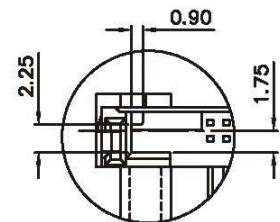

A VIEW  
S=2/1  
FOR 3.3 V

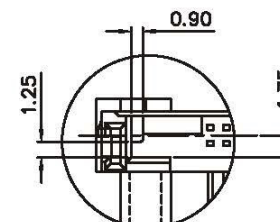

A VIEW  
S=2/1  
FOR 5.0 V

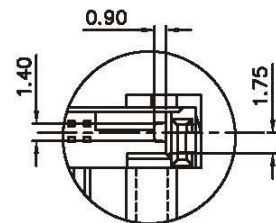

B VIEW  
S=2/1

PCC-PRxxVxZ-68-LF  
 00:0.00mm  
 20:2.00mm  
 28:2.80mm  
 40:4.00mm  
 50:5.00mm  
 80:8.00mm  
 22:2.20mm  
 3:3.3V  
 5:5.0V  
 LEADFREE

H	Dimension
00	0.00mm
20	2.00mm
28	2.80mm
40	4.00mm
50	5.00mm
80	8.00mm
22	2.20mm

**Allconnectors**

www.allconnectors.de  
 info@allconnectors.de  
 20190 Hildesheim - Germany

PART NO. PCC-PRxxVxZ-68

DWG NO. PCC-PRxxVxZ-68

FILE NO.

UNIT / mm

SCALE 1:1

CHECKED BY CY

DRAWING BY

PROJECTION

RoHS Compliant

TOLERANCES ARE

.X ± 0.2  
 .XX ±  
 .XXX ±  
 AWG

DESCRIPTION:

AREA

REVISIONS

HK

DATE