

This document is the property of Nian-Yeong Corporation and is delivered on the express condition that it is not to be disclosed, reproduced or used, in whole or in part, for manufacture or sale by anyone other than Nian-Yeong Corporation without its prior consent, and that no right is granted to disclose or to use any information in this document.

CUSTOMER DRAWING

REV.	DESCRIPTION	APPROVED BY	DATE	ECN NO.
A	RELEASE	Fido Weng	24/12/13	
B				
C				

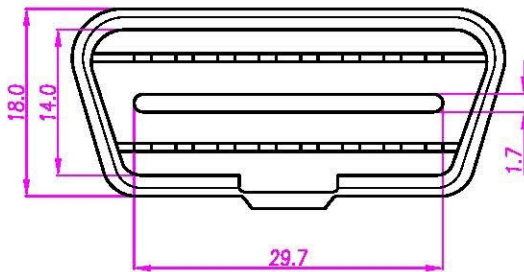
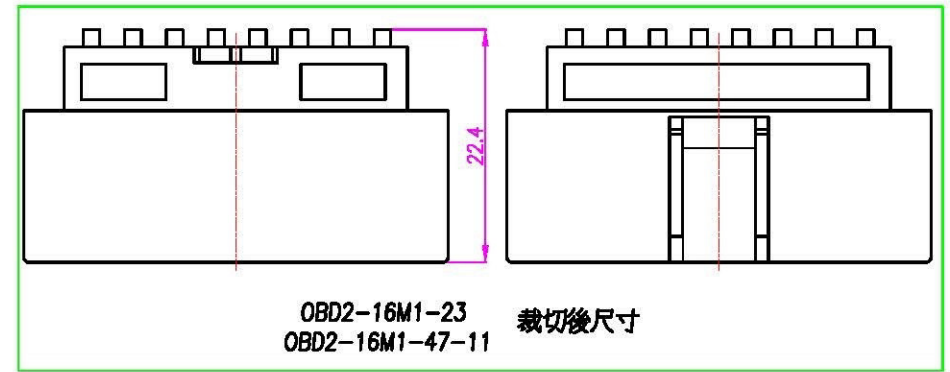
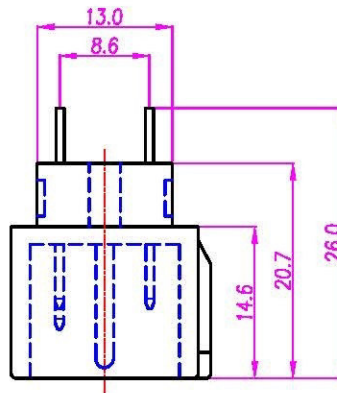
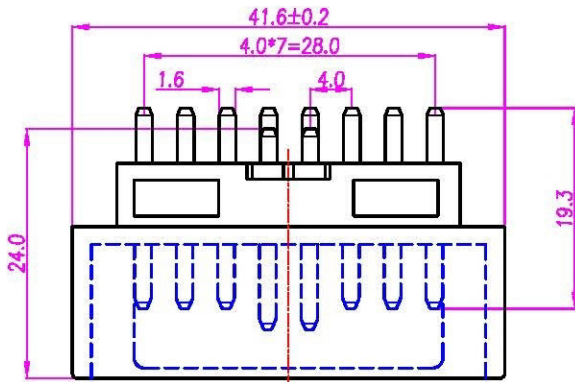
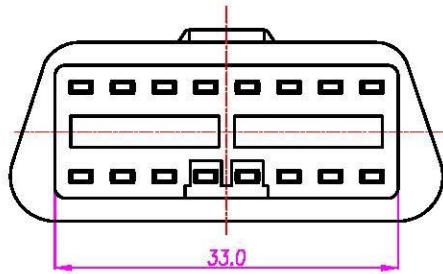

NOTE:

- MATERIAL:
 - 1-1.HOUSING: NYLON 66+15%GF
 - 1-2.CONTACT: BRASS ,t=0.80mm
- PLATING:
 - 2-1.CONTACT: CONTACT AREA : SEE TABLE A
 - OTHER AREA : GOLD FLASH
 - SOLDER AREA : BRIGHT TIN 60u"

TABLE A

OBD2-16M1-47-11	ALL BRIGHT TIN 100u"
OBD2-16M1-23	GOLD FLASH
P/N	PLATING

DRAWN	Jen Xie	APP'D	Fido Weng	UNIT	MM	TOLERANCE	All Connectors		TITLE	OBD2 16(M) 成型式(有孔膠芯)		SHEET			
CHK'D	Emily Suen			SCALE	1:1	X ±0.20 YX ±0.10 ZXXX ±0.05 JXXX ±0.03 ANGULA ±1°		www.allconnectors.de Tel.: 0049 711 7005503 70754 Hiltersbühl, Germany	info@allconnectors.de Fax: 0049 711 7005504 Kettensmestra. 29	PART NO.	SEE TABLE A	DWG NO.	QC5051	VERSION	A