

This document is the property of Nan-Yeong Corporation and is delivered on the express condition that it is not to be disclosed, reproduced or used, in whole or in part, for manufacture or sale by anyone other than Nan-Yeong Corporation without its prior consent, and that no right is granted to disclose or to use any information in this document.

CUSTOMER DRAWING

REV.	DESCRIPTION	APPROVED BY	DATE	ECN NO.
D	Change PART NO.	Fido Weng	22/04/09*	ECN09068
E	DELETE OBD2-16M1-23 IN TABLE A	Fido Weng	08/11/10*	ECN10123
F				

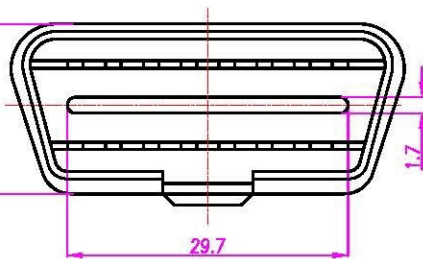
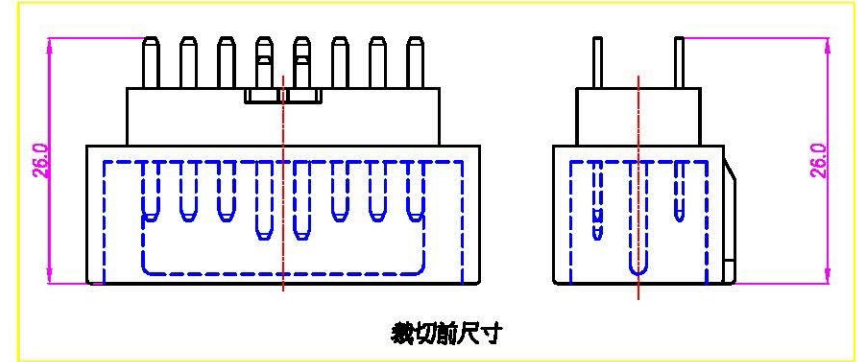
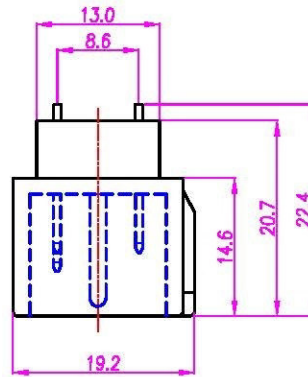
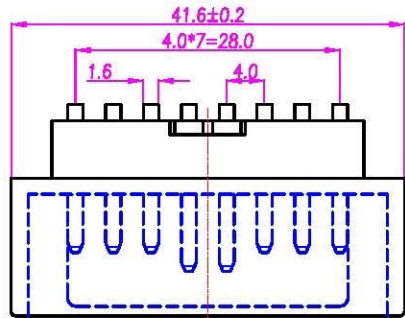
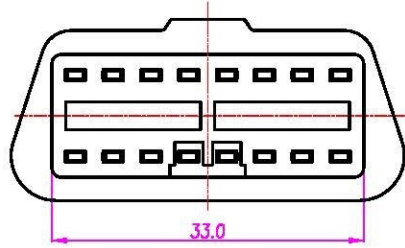

NOTE:

- MATERIAL:
 - 1-1.HOUSING: NYLON 66+15%GF
 - 1-2.CONTACT: BRASS ,t=0.80mm
- PLATING:
 - 2-1.CONTACT: SEE TABLE A

TABLE A

OBD2-16M1-04	OBD2 16(M)(短)(半全鍍)	BRIGHT TIN 60u"	GOLD FLASH
OBD2-16M1-20	OBD2 16(M)(短)(全鍍)	BRIGHT TIN 60u"	BRIGHT TIN 60u"
P/N	DESCRIPTION	SOLDER PLATED	CONTACT PLATED

DRAWN	CHK'D	APP'D	UNIT	PR	TOLERANCE	ANGULA	ALL CONNECTORS	TITLE	PART NO.	SEE TABLE A	DWG NO.	QC1799	VERSION
Jen Xie	Emily Suen	Fido Weng	SCALE	1:1	X ±0.20 XX ±0.10 XXX ±0.05 XXXX ±0.03 ANGULA ±1°		www.allconnectors.de TEL: 0049 711 7009203 70734 Filderstadt - Germany info@allconnectors.de Fax: 0049 711 7009204 Kette merstr. 25	SEE TABLE A	SEE TABLE A				E