

PCB LAYOUT (T=1.00mm)  
COMPONENT SIDE

Pin No.	Signal Name
1	VBUS
2	D-
3	D+
4	ID
5	GND
6	MicB_SSTX-
7	MicB_SSTX+
8	GND_DRAIN
9	MicB_SSRX-
10	MicB_SSRX+

NOTES:

\*Material

Housing: LCP+50%GF, UL 94V-0 rated, Color: Black;  
 Contact: Phosphor Bronze;  
 Plating: Au Plating on contact area, Au(Flash) Plating on solder tail, Ni(50u" Min) underplating over all;  
 Shell: Stainless steel; Nickel(40u" Min) Plating.

\*Mechanical

Insertion Force: 35N Max;  
 Withdrawal Force: 8N Min;  
 Durability: 10000 cycles Min.

\*Electrical Specification

Current Rating: 1.8A(Only Pin1,5), 0.25A For Other Pin;  
 Contact Resistance: 30mΩ Max;  
 Insulation Resistance: 100MΩ Min;  
 Dielectric Withstanding Voltage: 100V AC Min.

\*Environmental

Operating Temperature: -55°C to +85°C.

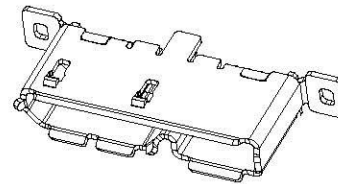
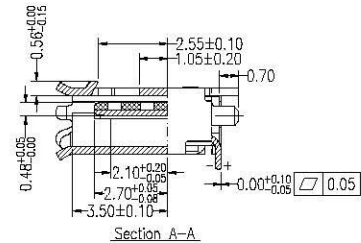
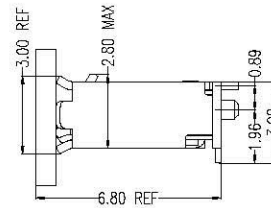

RoHS Compliant

Allconnectors

www.allconnectors.de  
 Tel: 0049 711 7009503  
 70734 Filderstadt - Germany

info@allconnectors.de  
 Fax: 0049 711 7009504  
 Kettenstr. 25

DRAWING BY CY

CHECKED BY GENIUS

UNIT / mm SCALE 1 : 1

DATE

SIZE A4 PPROJECTION

TOLERANCES ARE

X ±  
 X ± 0.38  
 XX ± 0.25  
 XXX ± 0.20  
 ANG ±



ORDER INFORMATION

MISB-SVPMEG30C-10B-HF  
 SERIES | | | | | HALOGEN FREE  
 FEMALE | | | | | 10 PIN B TYPE  
 180°SMT | | | | | METAL EAR  
 POST

DESCRIPTION: Micro USB 3.0 Vertical B Type Receptacle(6.0)