

1

2

3

4

5

6

A

B

C

D

A

B

C

D

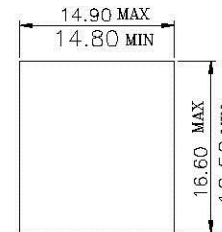
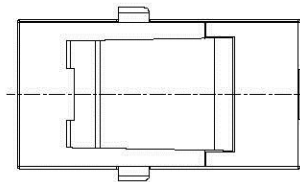
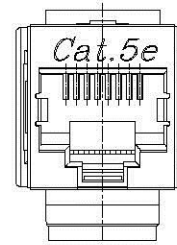
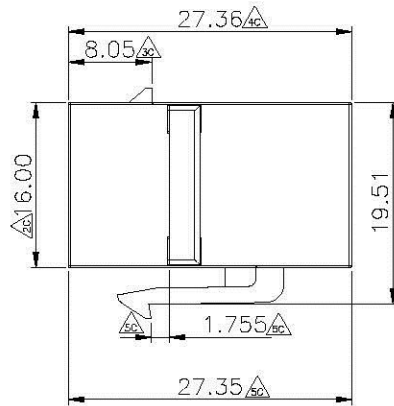
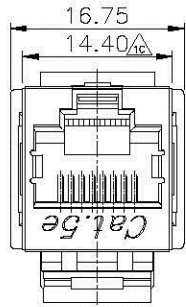

Front Panel Jack Only Clearance
W/O Latch Feature

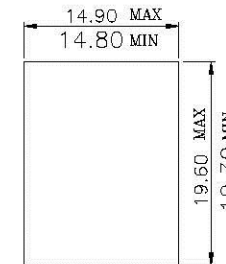

Single Panel-Latch Clearance
Panel Thickness 1.60mm

Electrical:
 1.Voltage Rating:125 Vac Rms.
 2.Current Rating:1.5 Amp.
 3.Contact Resistance:40 Milliohms Max.
 4.Insulation Resistance:1000 Megohms Min @500 Vdc.
 5.Dielectric Strength:1000 Vac Rms 60Hz, 1Min.
Mechanical:
 1.Operating:750 Cycles Min.
Environmental:
 1.Storage:-40°C To +85°C.
 2.Operation:-20°C To +75°C.
 Mates With Modular Plug Conforming
 To FCC Part 68, Subpart F.

Materials:
 Shielded: Stainless Steel.
 Plastic Housing: Engineering Thermoplastic
 Flammability Rating UL 94V-0.
 Contacts: Thickness Phosphor Bronze
 Plating: Gold Plating Over Nickel In Contact.

6u" P/N J201690281
 15u" P/N J201690282
 30u" P/N J201690283
 50u" P/N J201690284

All Connectors <small>CONNECTIONS FOR THE FUTURE</small>			
UNIT	SCALE	SHEET	TITLE
mm	2/1	1 of 1	MODULAR COUPLER JACK (8P8C SHIELDED)C. 5e
DRAWN BY	APPROVED BY		DRAW NO :
Alan	Alan		J201690281
	110329	110329	REV.
General tolerance			A
.XXX	±0.10		
.XX	±0.25		
.X	±0.38		
	±0.50		
ANG	±3°		
REV	DESCRIPTION	DATE	

1

2

3

4

5

6