

SNAP LATCH ASSEMBLY P/N DESCRIPTION:

1	BONED	R	M	C	1	-	X	-	X	P	X	2	-	X	X	X	X	-	X	
2	MEDICAL																			
3	STYLE	C1= PR(In-Line-Receptacle with cable collet)----- SOLDER TERMINATION																		
4	OUTER SHELL MATERIAL	G=GREY PSU	B=BLACK PSU	M=WHITE PSU	F=BLACK PEI	P=GREY PEI														
5	BACK NUT MATERIAL	0=BLACK	1=WHITE	2=RED	4=YELLOW	5=GREEN	6=BLUE	8=GREY	P=PEEK											
6	INSULATOR																			
7	CONTACT DIAMETER	1= 1.3mm (ONLY FOR 2 PIN) 2= 0.9mm (ONLY FOR 4,5 PIN) 3= 0.7mm (ONLY FOR 6,7,8 PIN) 4= 0.5mm (ONLY FOR 9,10,14 PIN)																		
8	CONTACT PLATING	2=FOR MEDICAL																		
9	CABLE COLLET	1= Ø3.9mm (CABLE Ø=2.7~3.9mm) 2= Ø5.2mm (CABLE Ø=4.0~5.2mm) 3= Ø6.5mm (CABLE Ø=5.3~6.5mm)																		
10	CODING	D= 0° A= 40° C= 60° E= 80° H= 170° J= 205°																		
11	NUMBER OF CONTACTS	02=2 PIN 03=3 PIN 04=4 PIN 05=5 PIN 06=6 PIN 07=7 PIN 08=8 PIN 09=9 PIN 10=10 PIN 14=14 PIN																		
12	LOGO	0='nextron' LOGO G=NO LOGO																		

POSITIONS	VIEW FROM TERMINATION SIDE
	SOCKET PART
2 PIN	
3 PIN	
4 PIN	
5 PIN	
6 PIN	
7 PIN	
8 PIN	
9 PIN	
10 PIN	
14 PIN	

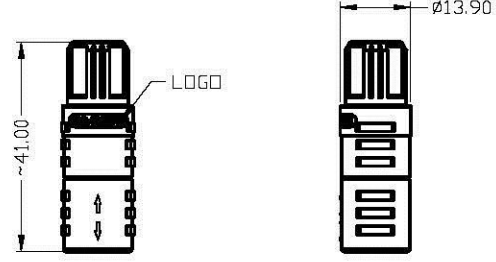

- NOTES :
- 1.MATERIAL  
OUTER SHELL : PSU/PEI  
INSULATOR : PEEK  
CONTACT : COPPER ALLOY  
CABLE COLLET : PEU/PEI  
BACK NUT : PSU/PEI
  - 2.NUMBER OF CONTACT : 2 TO 14 POSITION
  - 3.ALL DIMENSIONS ARE IN MILLIMETERS.
  - 4.RoHS DIRECTIVE COMPLIANCE

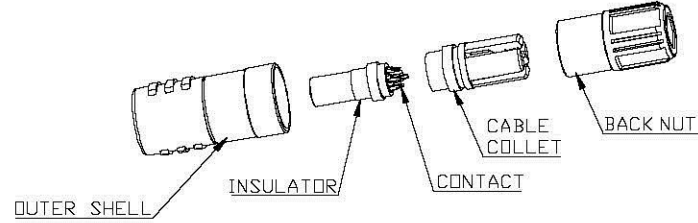

B3	UPDATE DWG.	07/16/14	Seawen
B2	ADD NEW P/N	03/23/13	Seawen
REV.	DESCRIPTION	DATE	APPD

UNITS mm INCH	NAME: SNAP LATCH (In-Line-Receptacle)	Allconnectors www.allconnectors.com TEL: 0049 711 7009049 FAX: 0049 711 7009044 E-MAIL: info@allconnectors.com	
GENERAL TOLERANCES: (UNLESS SPECIFIED)	PART NO: RMC1XXPX2XXXXX	TITLE: CUSTOMER DWG.	
4 PLACE ± ** ± **	APPD: 楊海文 07/16/14	DWG NO: 010-0000-460	
3 PLACE ± ** ± **	CHKD: 羅旋 07/16/14	SCALE: SHEET: REV.:	
2 PLACE ± 0.20 ± **	DRAWN: 段小鋒 07/16/14	1/1	1/3 B3
1 PLACE ± ** ± **			
ANGULAR: X° ± ** X° ± **			

SNAP LATCH ASSEMBLY P/N DESCRIPTION:

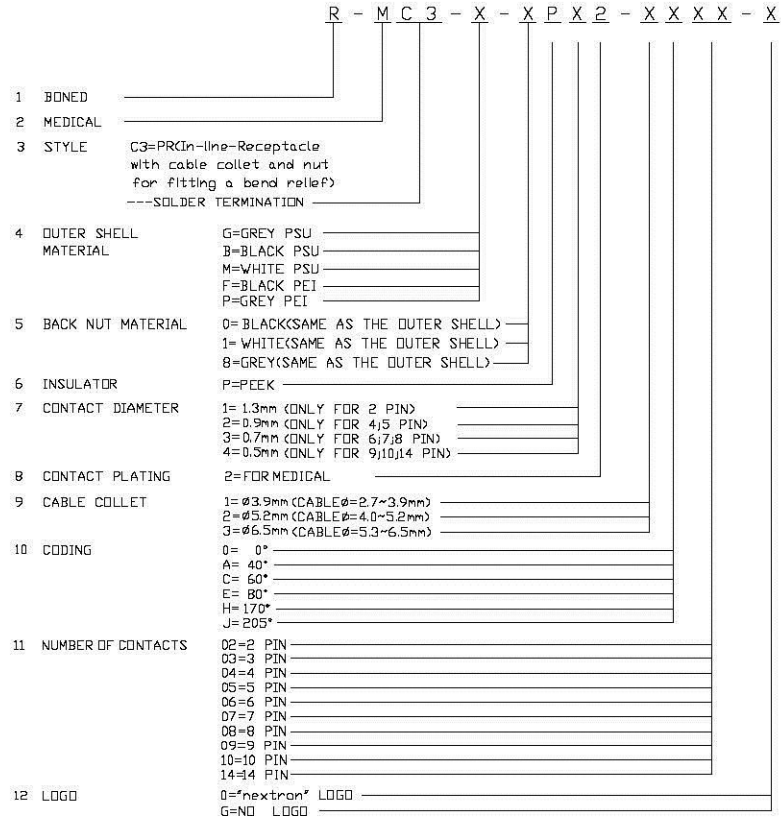

POSITIONS	VIEW FROM TERMINATION SIDE
	SOCKET PART
2 PIN	
3 PIN	
4 PIN	
5 PIN	
6 PIN	
7 PIN	
8 PIN	
9 PIN	
10 PIN	
14 PIN	

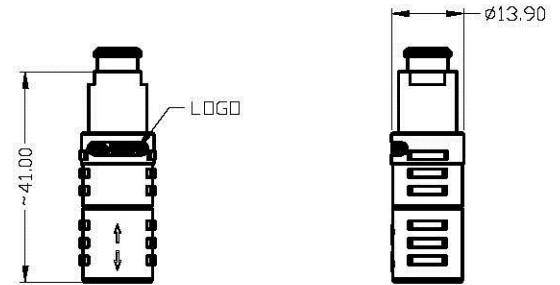

- NOTES :
- 1.MATERIAL  
OUTER SHELL : PSU/PEI  
INSULATOR : PEEK  
CONTACT : COOPER ALLOY  
CABLE COLLET : PSU/PEI  
BACK NUT : PSU/PEI
  - 2.NUMBER OF CONTACT : 2 TO 14 POSITION
  - 3.ALL DIMENSIONS ARE IN MILLIMETERS.
  - 4.RoHS DIRECTIVE COMPLIANCE

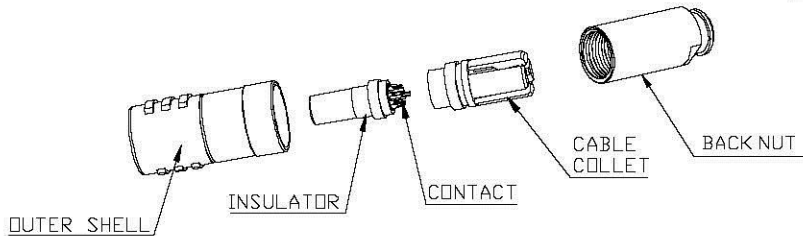

REV.	DESCRIPTION	DATE	APPD
B3	UPDATE DWG.	07/16/14	Seawen
B2	ADD NEW P/N	03/23/13	Seawen

UNITS	
<input checked="" type="checkbox"/> mm	<input type="checkbox"/> INCH
GENERAL TOLERANCES: (UNLESS SPECIFIED)	
4 PLACE	$\pm .0001$
3 PLACE	$\pm .0002$
2 PLACE	$\pm .001$
1 PLACE	$\pm .005$
ANGULAR:	$X^{\circ} \pm .01$

NAME: SNAP LATCH (In-Line-Receptacle)
PART NO: RMC3xxPX2xxxxx
APPD: 楊海文 07/16/14
CHKD: 羅旋 07/16/14
DRAWN: 段小鋒 07/16/14

Allconnectors	
TITLE: CUSTOMER DWG.	
DWG NO: 010-0000-460	
SCALE: 1/1	SHEET: 2/3
REV: B3	

CODING (RECEPTACLE FRONT VIEW):

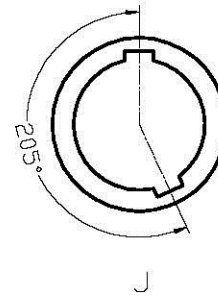
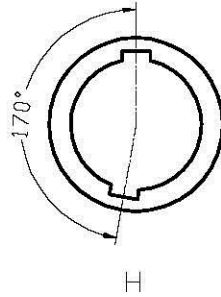
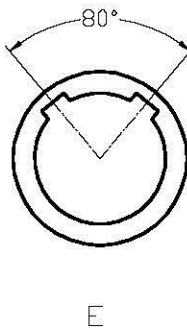
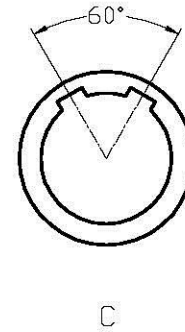
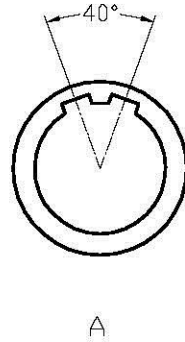
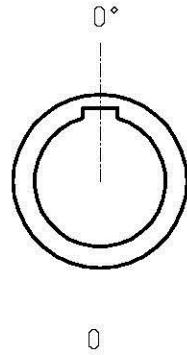

UNITS		NAME: SNAP LATCH (In-Line-Receptacle)		<b>All Connectors</b>	
<input checked="" type="checkbox"/> mm <input type="checkbox"/> INCH		PART NO: RMCXXXPX2XXXXX		TITLE: CUSTOMER DWG.	
GENERAL TOLERANCES: (UNLESS SPECIFIED)		APPD: 楊海文 07/16/14		DWG NO: 010-0000-460	
		mm	INCH	SCALE: SHEET: REV.:	
4 PLACE	± .005	± .002	± .0001	1/1	3/3
3 PLACE	± .005	± .002	± .0001		
2 PLACE	± 0.20	± .008	± .0004		
1 PLACE	± .005	± .002	± .0001		
ANGULAR:	X° ± .005	X° ± .002	X° ± .0001		
REV. DESCRIPTION		DATE APPD		DRAWN: 段小鋒 07/16/14	
B3	UPDATE DWG.	07/16/14	Seawen		
B2	ADD NEW P/N	03/23/13	Seawen		