

NOTE:

- MATERIAL AND FINISH
SHELL ASSEMBLY: COPPER ALLOY, OUTER SHELL Cr PLATING,
OTHER METALLIC COMPONENTS Ni PLATING
INSULATOR: PEEK
CONTACT: COPPER ALLOY, GOLD PLATING OVER Ni
- ROHS COMPLIANCE
- PART NO.

R - F 0 K R * * 0 4 0 0 0 0 0

PRODUCT TYPE
F=SNAP LATCH METAL

CONTACT PLATING
4=Au 20u"

PRODUCT STYLE
OK=OK STYLE

NUMBER OF CONTACTS
02=02PIN
SEE TABLE

PRODUCT MODEL
R=RECEPTACLE

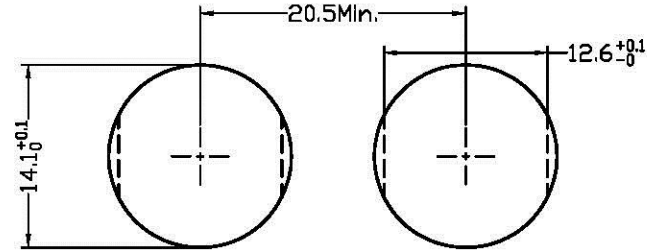

PANEL CUT-OUT

POSITIONS	02 PIN	03 PIN	04 PIN	05 PIN	06 PIN	07 PIN	09 PIN
VIEW FROM TERMINATION SIDE PIN PART							

UNITS mm INCH		
GENERAL TOLERANCES: (UNLESS SPECIFIED)		
	mm	INCH
4 PLACE	±.30	±.012
3 PLACE	± 0.30	±.012
2 PLACE	± 0.50	±.020
1 PLACE	± 0.80	±.031
ANGULAR	X°± 2°	X°±.075

NAME: SNAP LATCH METAL OK FIXED SOCKET
PART NO: R-F0KR**0400000
APPD: Seawen 06/11/12
CHKD: Peter 06/11/12
DRAWN: Camby 06/11/12

All Connectors		
TITLE: CUSTOMER DWG.		
DWG NO: 010-0000-B86		C
SCALE: 5/1	SHEET: 1/1	REV: X1

X1	NEW RELEASE	06/11/12	Seawen
REV.	DESCRIPTION	DATE	APPD