

NO	DESCRIPTION	MATERIAL	Q'TY	FINISH	REMARK
1	BODY 1	BRASS	1	GOLD	B-SMA0209-G
2	INSULATION 1	TEFLON	1	TEFLON	I-0547T
3	PIN	Be Cu	1	GOLD	P-SMA0120-G
4	INSULATION 2	TEFLON	1	TEFLON	I-0229T
5	BODY 2	BRASS	1	GOLD	B-SMA0473-G

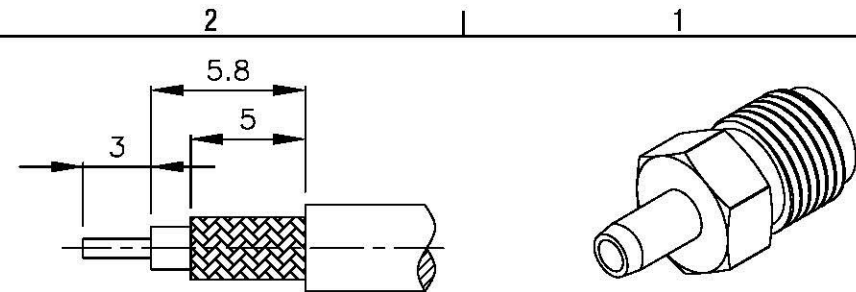

(Recommended Stripping Dimension)

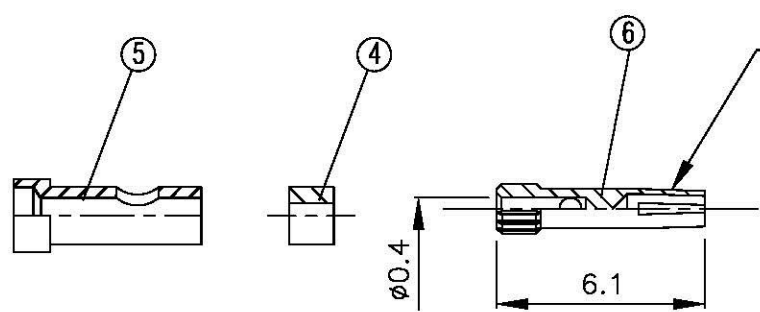

PIN CHUCK
0.2x2x2 GROOVE

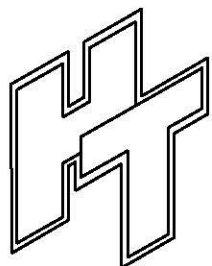
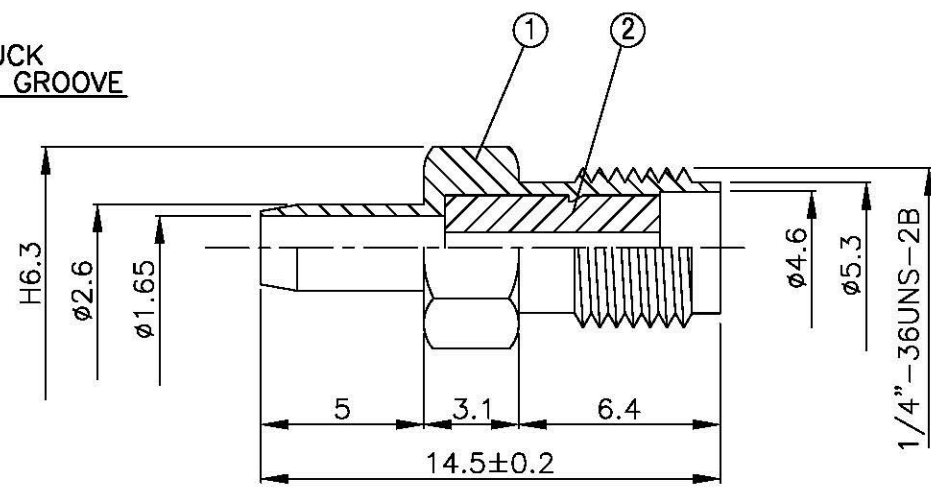

All Connectors
www.allconnectors.de
Tel.: 0049 741 700500
70784 Hilderstadt, Germany

info@allconnectors.de
Fax: 0049 741 700504
Kottbusstr. 25

TITLE **SMA FEMALE CRIMP FOR RG-178/U**

PART NO. **SMA-04M-TGG**

DRAWING NO. **SMA 04M TGG**

DRAWN **MARY** DATE **96.03.15**

CHECKED **黃巧君** DATE

Q.A. **蘇姿潔** DATE

APPROVAL **徐燦霖** DATE

REVISION DATE

DIMENSIONS ARE IN MILLIMETERS

UNLESS OTHERWISE SPECIFIED TOLERANCES

0.5-5=±0.2 120-315=±1

5-30=±0.4 315-1000=±1.6

30-120=±0.6 1000-2000=±2.4

SCALE **4:1** SIZE **A**

REVISION	
DESCRIPTION	ENGINEER