

NO	DESCRIPTION	MATERIAL	Q'TY	FINISH	REMARK
1	SCREW	BRASS	1	NICKEL	N-0028-N
2	BODY	BRASS	1	GOLD	N-0025-N
3	BODY	BRASS	1	NICKEL	B-16560542-N
4	BODY	BRASS	1	NICKEL	B-16560543-N
5	INSULATION	TEFLON	1	TEFLON	I-0259T
6	INSULATION	TEFLON	1	TEFLON	I-0260T
7	PIN	BE CU	1	GOLD	P-16560221-G
8	WASHER	BRASS	1	SILVER	W-0050-S
9	SPIGOT	BRASS	1	SILVER	B-16560544-S
10	BODY	BRASS	1	NICKEL	B-16560350-G

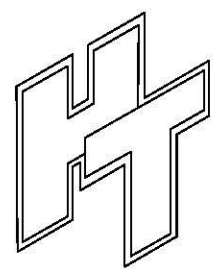
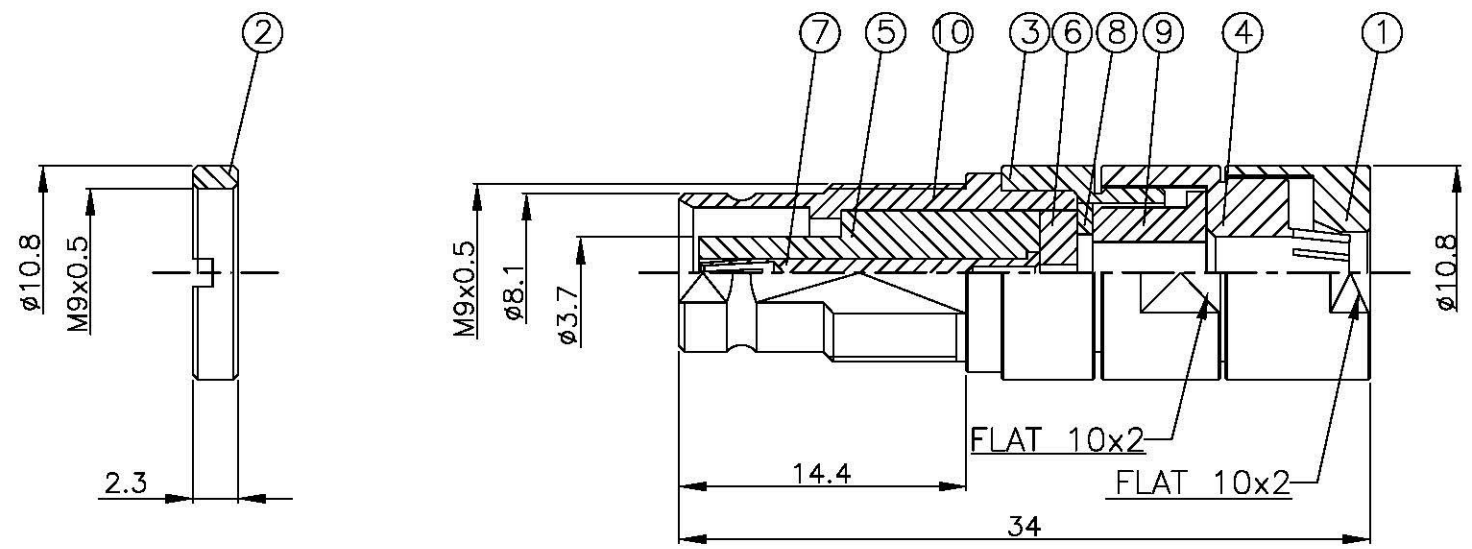
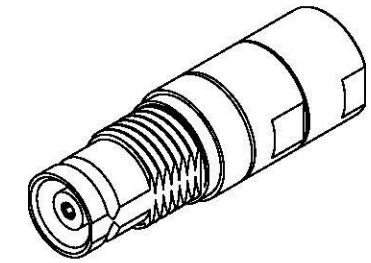

All Connectors
 www.allconnectors.de
 info@allconnectors.de
 70724 Ulm/Erststadt - Germany
 70724 Ulm/Erststadt - Germany

TITLE
1.6/5.6 FEMALE CLAMP FLEX 3

PART NO.
1656-112VIC-TGN

DRAWING NO.
1656 112VIC TGN

DRAWN MARY DATE 96.08.26
 CHECKED 蘇志欣 DATE
 Q.A. 蘇姿潔 DATE
 APPROVAL 徐燦霖 DATE
 REVISION DATE

DIMENSIONS ARE IN MILLMETERS

UNLESS OTHERWISE SPECIFIED TOLERANCES

0.5-5 = ±0.2 120-315 = ±1
 5-30 = ±0.4 315-1000 = ±1.6
 30-120 = ±0.6 1000-2000 = ±2.4

SCALE 4:1 SIZE A

REVISION	
DESCRIPTION	ENGINEER