

Contract:  
 Contact: Phosphor Brass.  
 Insulator: PBT.  
 Finish: Copper Alloy with Gold over Nickel Plated.

Specifications:  
 Current Rating: 0.5 Amp  
 Contact resistance: 30m Ohm Max.  
 Insulator resistance: 1000M ohm min.  
 Operating Temperature Range: -40°~+105°C

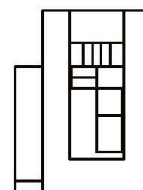
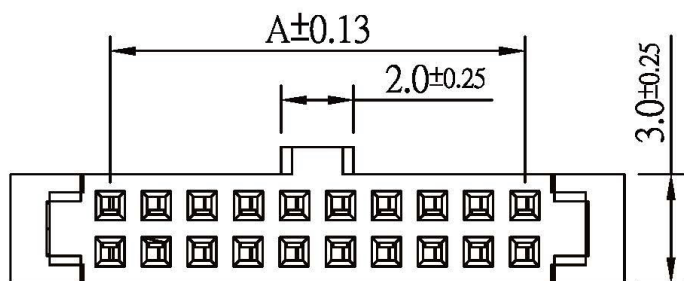
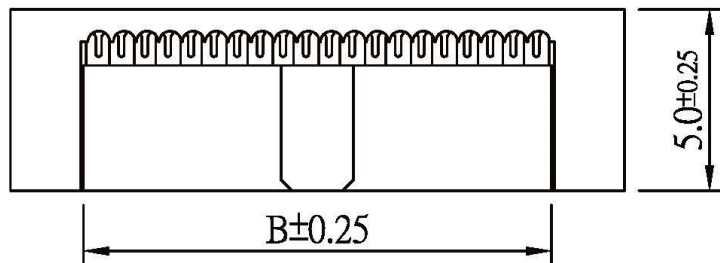
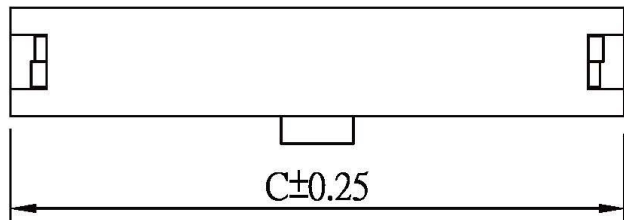

Circuits	Dimension		
	A	B	C
6	2.54	4.01	8.04
8	3.81	5.28	9.31
10	5.08	6.55	10.58
12	6.35	7.82	11.85
14	7.62	9.09	13.12
16	8.89	10.36	14.39
20	11.43	12.90	16.93
24	13.97	15.44	19.47
26	15.24	16.71	20.74
30	17.78	19.25	23.28
34	20.32	21.79	25.82
40	24.13	25.60	29.63
44	26.67	28.14	32.17
50	30.48	31.95	35.98
60	36.83	38.30	42.33
64	39.37	40.84	44.87
66	40.64	42.11	46.14
68	41.91	43.38	47.41

**All Connectors**

www.allconnectors.de info@allconnectors.de  
 Tel.: 0049 711 7009503 Fax: 0049 711 7009504  
 70794 Filderstadt - Germany Kettenerstr. 25

**RoHS Compliant**

DRAWING BY CY  
 CHECKED BY GENIUS  
 UNIT/ mm SCALE 1 : 1  
 DATE  
 SIZE A4

TOLERANCES ARE

X ±  
 .X ±  
 .XX ±  
 .XXX ±  
 ANG ±

PJECTION

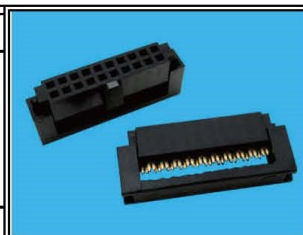

**ORDER INFORMATION**

HAF-C2-xx-LF  
 SERIES | LEADFREE  
 | 06~68WAY  
 IDC TWO TYPE

DESCRIPTION: 1.27-1.27 Pitch IDC Straight