

FEATURES:

- Half pitch 1.27mm(.050") series
- D-SUB Male connector solder type for cable
- Assembly hood: with ABS plastic (steel inner shell) or Die-Cast metal
- Fully EMI/RFI shielded

MATERIALS:

- Housing: Thermoplastic P.B.T UL94V-0 black
- Contacts: Phosphor bronze mating end selective gold plated
- Front Shell: Steel nickel plated over copper

ELECTRICAL:

- Current Rating: 1 Amp
- Insulation Resistance: 500MΩ/Min
- Withstanding Voltage: AC 500V/Min
- Contact Resistance: 35mΩ MAX
- Temperature Range: -55°C ~ +105°C

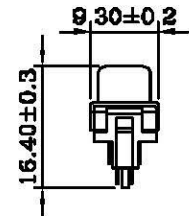
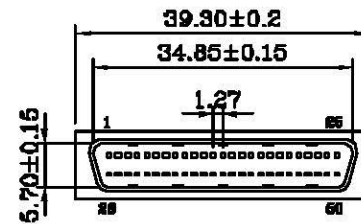
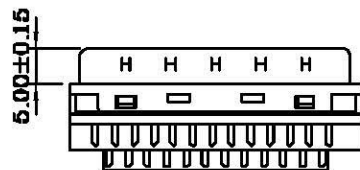
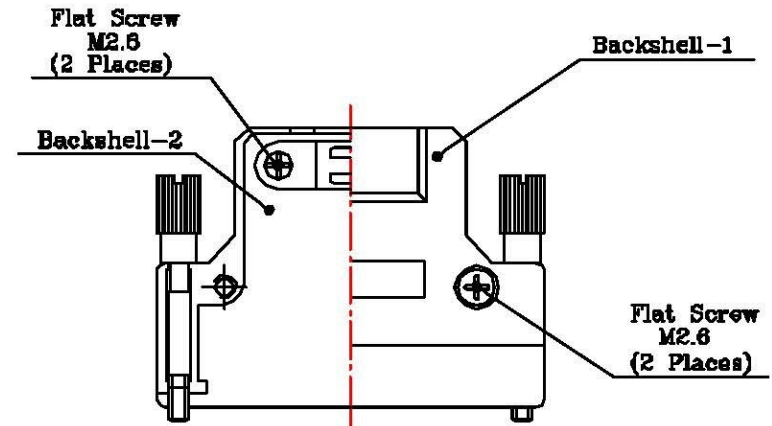
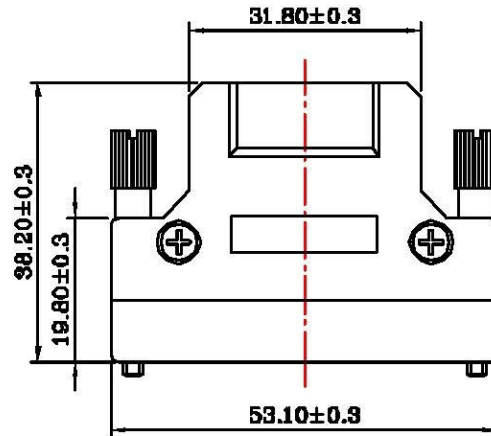
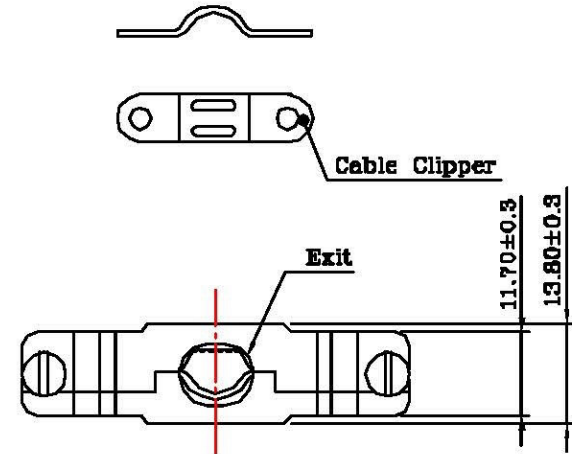
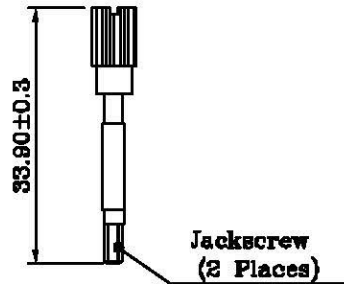

All Connectors

www.allconnectors.de
Tel.: 0049 711 7099503
40794 Hilderstadt - Germany

info@allconnectors.de
Fax: 0049 711 7099504
Kettmeistr. 20

PART NO. HPD-PSM-050		CHECKED BY CY		TOLERANCES ARE		DESCRIPTION:			
DWG NO. HPD-PSM-050		DRAWING BY		.X ±		AREA		REVISIONS	
FILE NO.		PROJECTION		.XX ±		HK		DATE	
UNIT / mm	SCALE 1:1			.XXX ±					
				AWG					