

SECTION:A-A

NOTE:
 MATERIAL:
 HOUSING:THERMOPLASTIC(NYLON+GF)UL 94V-0
 CONTACT:PHOSPHOR BRONZE
 PLATING:
 CONTACT: GOLD PLATING
 SPECIFICATION:
 VOLTAGE RATING: 250V
 CURRENT RATING: 1A
 CONTACT RESISTANCE TERMINAL:30mΩ MAX
 DIELECTRIC WITHSTANDING VOLTAGE:500V AC/MIN
 INSULATION RESISTANCE:1000MΩ MIN

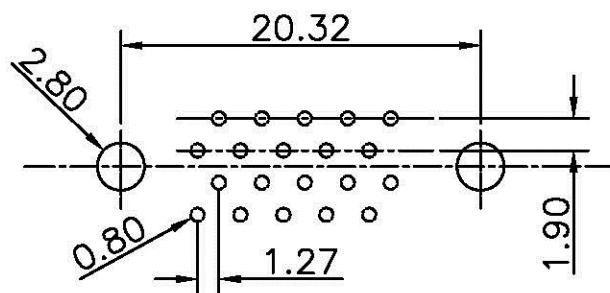
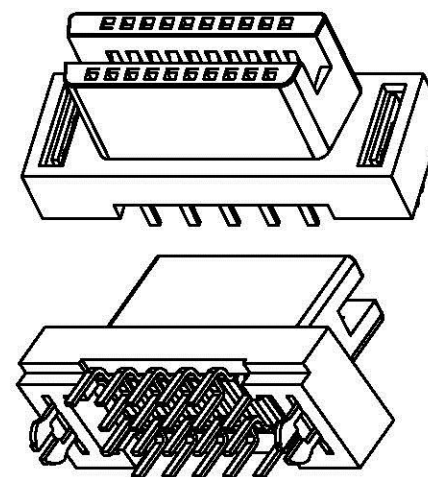
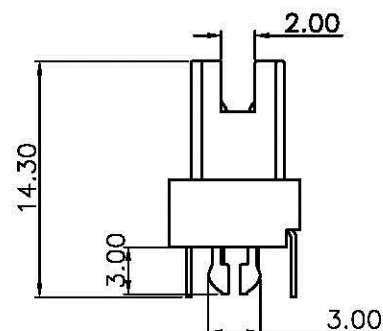
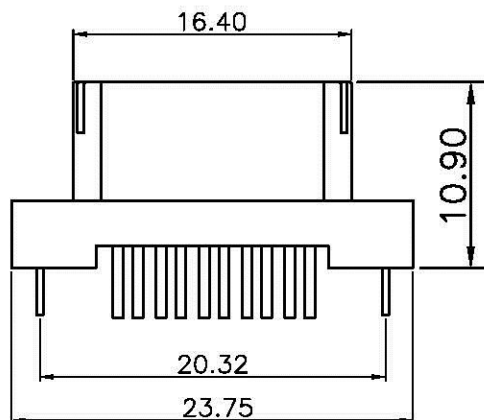

PCB LAYOUT: COMPONENT SIDE RECOMMENDED PCB THICKNESS:1.60mm

HPCP-SDZU-020-LF
 LEADFREE

RoHS Compliant

All Connectors

www.allconnectors.de
 Tel.: 0049 711 7009503
 70734 Filderstadt Germany

info@allconnectors.de
 Fax: 0049 711 7009504
 Kette mcrstr. 25

PART NO. HPCP-SDZU-020

DWG NO. HPCP-SDZU-020

FILE NO.

UNIT / mm

SCALE 1:1

CHECKED BY CY

DRAWING BY

PROJECTION



TOLERANCES ARE

.X±0.2
 .XX±
 .XXX±
 AWG

DESCRIP TION:

PITCH 1.27mm
 CARD EDGE 20PIN DIP

AREA

REVISIONS

HK

DATE