

SEC.A-A

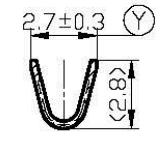

SEC.B-B

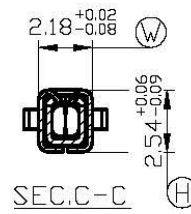
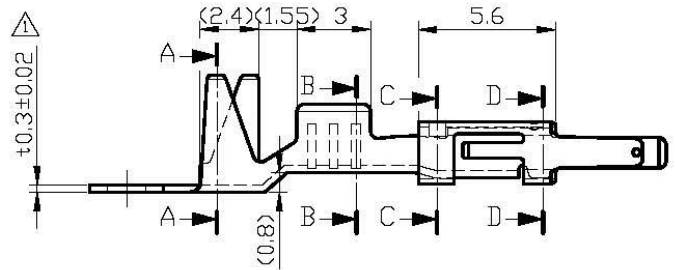

SEC.C-C

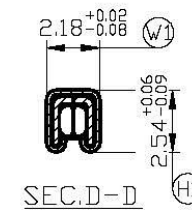

SEC.D-D

- 說明:
- 1.預鍍錫膜厚40u"以上
  - 2.對手件: TAB=0.6  
插入力: 0.4KG以下  
拉拔力: 0.1KG以上  
10回拉拔力: 0.1KG以上
  - △ 3.產品淨重: 約 0.4g

- NOTE:
- 1.Pre-Tin Plated Thickness More Than 40u"
  - 2.Mating Part: TAB=0.6  
Inserted Force: Less Than 0.4KG  
Tensile Force: More Than 0.1KG  
The Ten Time Tensile Force: More Than 0.1KG
  - △ 3.Net Weight of the Product: about 0.4g

1	Q060T-FT-18	Body: Phosphor Bronze Spring: Stainless	Note 1	0.5~0.85mm <sup>2</sup>
NO.	產品編號 Part Number	材料 Material	表面處理 Surface Treatment	線徑 Wire Range

Q060T-FT-18-LF  
LEADFREE  
RoHS Compliant



PART NO. Q060T-FT-18		CHECKED BY CY		TOLERANCES ARE X ± .X ± .XX ± .XXX ± ANG	DESCRIPTION:
DWG NO. Q060T-FT-18		DRAWING BY			
FILE NO.		PROJECTION		AREA	REVISIONS
UNIT / mm	SCALE 1:1			DATE	