

# Y311R Y543R Y556R CRIMP TERMINAL

Features:

unit:mm

- \* MATERIAL: BRASS
- \* THICKNESS: 0.4mm
- \* TREATMENT: TIN PLATED BEFORE STAMPING
- \* WIRE RANGE: AWG#18-22

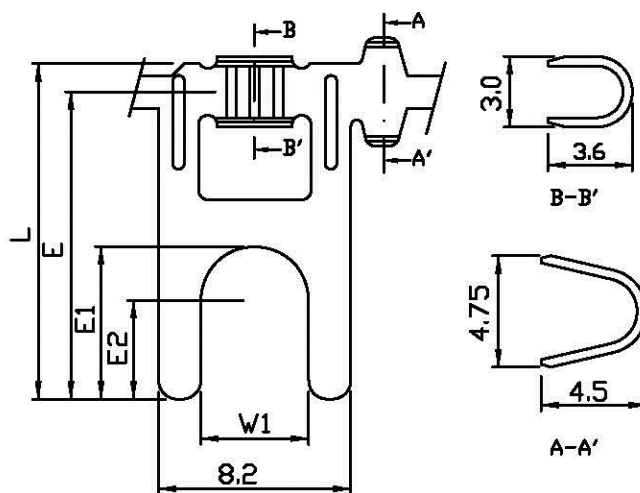

PART NO.	L	E	E1	E2	W1	INSULATION O.D.	QTY/REEL
Y311R	14.3	13.1	6.05	4.2	3.7	$\phi 3.7 \sim \phi 1.5 \text{mm}$	4,000
Y543R	14.3	13.1	6.5	4.2	4.6	$\phi 3.7 \sim \phi 1.5 \text{mm}$	4,000
Y556R	14.3	13.1	6.9	4.2	5.4	$\phi 3.7 \sim \phi 1.5 \text{mm}$	4,000