

# 產品成品圖

Terminal (090 Type)

品號	適用電線	線皮外徑	IS	WS	H9	H8	①	②	③
D70210BS-2AS	20-22	2.6-2.45	4.3	2.3	4	2.15	1.4	2.8	3
D70210BS-2AM	16-18	3.2-2.9	4.5	2.7	4	2.9	1.4	2.8	3
D70210BS-2AL	14-16	3.6-3.2	5.0	3.7	4	3.8	1.4	2.6	3.2

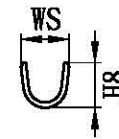
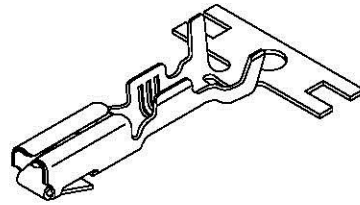
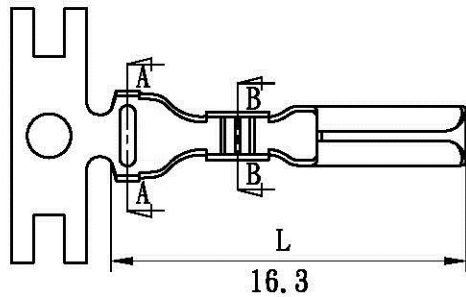

B-B Section

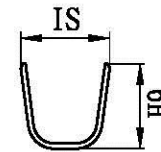
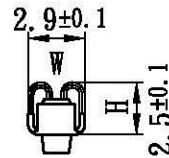
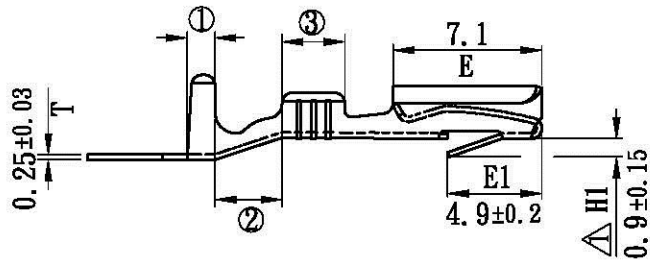

A-A Section

表面處理(Surface treatment):  
預鍍錫膜厚 $40\mu$ "以上  
(Pre-tin-plated thickness  
more than  $40\mu$ " )

對手件(Mating part):  
D60210BS-2  
D60210BS-2S  
D60219BS-2

包裝數量(Standard packing):  
5000 PCS

All Connectors

www.allconnectors.de  
Tel.: 0049 711 7008303  
70962 Allmersbach, Germany

info@allconnectors.de  
Fax: 0049 711 7008504  
Kittlingstraße, 35

UL NO:	CSA NO:	TUV NO:	名稱(Name): 產品規格(Product specifications)			核發單位 (Issued by)	制定單位 (Instituted by)
			編號(Part No.): D70210BS-A系列			部品部 2009.6.26 核發	開發課 2009.6.26 制定
			材質(Material): 黃銅[Brass]				
△	補上HI代號	2	26-Jun-09	核准 (Approved by)	審查 (Confirmed by)	制定 (Drawn by)	單位(Unit):mm 比例(Scale):Free
		1	21. Jun. 05				
記號 (Sign)	變更內容 (Change description)	版次 (Edition)	制修訂日期 (Drawn date)	韓曜安	韓曜安	黃莉雯	第三角法 (Projection): 一般公差 (General tolerance): $\pm 0.3$