

FEATURES:

- . 2–20 Circuits
- . Housing, UL 94V–2 Nylon 6/6, Natural
- . Designed for parallel and perpendicular board stacking, connection
- . Mates with .045" [1.14mm] square pins

SPECIFICATIONS:

- . Current rating: 7A AC, DC
- . Voltage rating: 250V AC, Maximum
- . Temperature range: $-40^{\circ}\text{C} \sim +105^{\circ}\text{C}$
- . Contact resistance: Initial Value/10m Ω max.
After environmental testing /20m Ω max.
- . Insulation resistance: 5000 M Ω min
- . Withstand Voltage: 1500V AC/minute
- . Applicable PC board thickness: .063" [1.6mm]

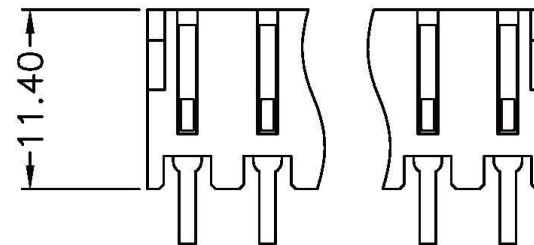
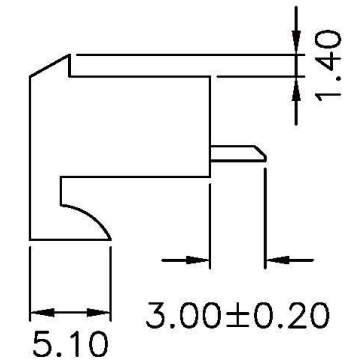
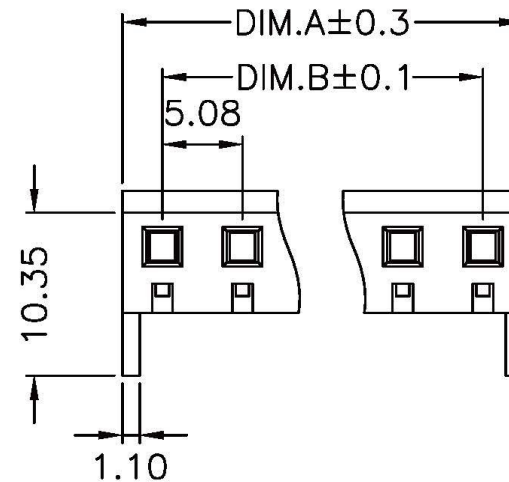

PIN數	DIM.A	DIM.B
02	10.16	5.08
03	15.24	10.16
04	20.32	15.24
05	25.40	20.32
06	30.48	25.40
07	35.56	30.48
08	40.64	35.56
09	45.72	40.64
10	50.80	45.72
11	55.88	50.80

PIN數	DIM.A	DIM.B
12	60.96	55.88
13	66.04	60.96
14	71.12	66.04
15	76.20	71.12
16	81.28	76.20
17	86.36	81.28
18	91.44	86.36
19	96.52	91.44
20	101.6	96.52

All Connectors

www.allconnectors.de
Tel.: 0049 711 7009503
70794 Filderstadt - Germany

info@allconnectors.de
Fax: 0049 711 7009504
Kettnerstr. 25

RoHS Compliant

DRAWING BY CY
CHECKED BY GENIUS
UNIT/mm SCALE 1:1
DATE
SIZE A4

TOLERANCES ARE

X ±
X ±
.XX ±
.XXX ±
ANG ±

PJECTION

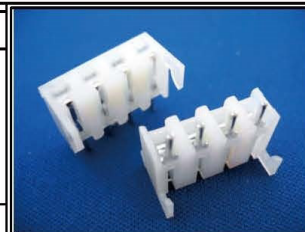

ORDER INFORMATION

LKX-T-xx-LF
SERIES | 02~20WAY | LEADFREE
TOP ENTRY

DESCRIPTION: