

■ SPECIFICATIONS

- Voltage rating: 600V AC, DC
- Current rating: 7A, AC, DC
- Withstanding Voltage: 1500V AC/minute
- Insulation resistance: 1000M min
- Temperature range: -40°C~+105°C
- Applicable PC board thickness: .063" (1.6mm)
- Contact resistance: Initial Value/10m max
- After environmental testing/20m max

■ WAFER

- Part No.: MF-9360S-1*XX
- Poles: 03-12
- Material: Nylon 66 UL 94V-2
- Q`ty: 1000pcs/bag

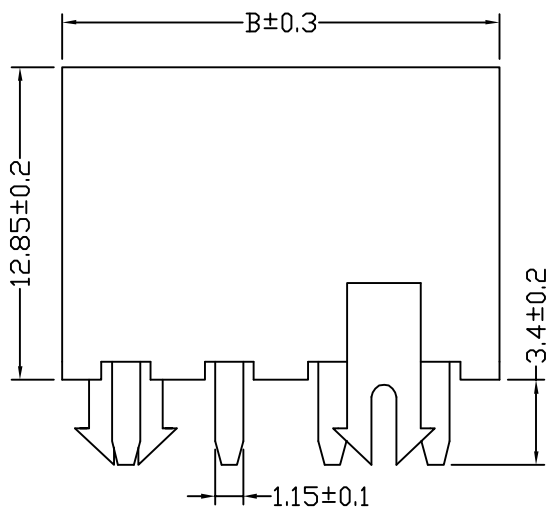

Poles	Part No	Dimensions (mm)	
		A	B
3	9360S-1*03	8.40	13.80
4	9360S-1*04	12.60	18.00
5	9360S-1*05	16.80	22.20
6	9360S-1*06	21.00	26.40
7	9360S-1*07	25.20	30.60
8	9360S-1*08	29.40	34.80
9	9360S-1*09	33.60	39.00
10	9360S-1*10	37.80	43.20
11	9360S-1*11	42.00	47.40
12	9360S-1*12	46.20	51.60

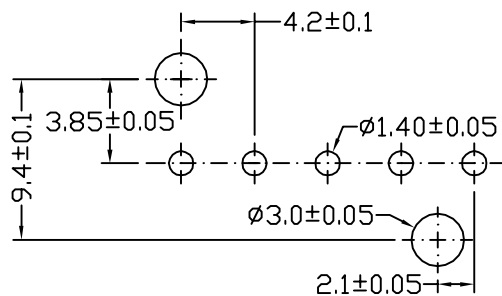
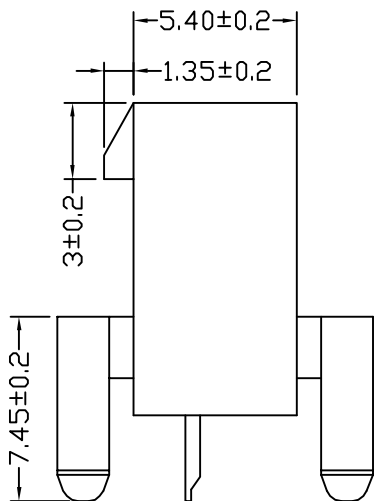

PCB Recommended Layout

APPROVED BY	DATE	SCALE	TOLERANCE	
	2007/05/15	4:1	.0	±0.3
CHECKED BY	UNIT	VIEW	.00	±0.2
	mm	⊕ □	.000	±0.1
DRAWN BY	VER NO.	SIZE	.0	±
	D1	A1	.0	±