

■ SPECIFICATIONS

- Voltage Rating: 600V AC, DC
- Current Rating: 9A, AC/DC
- Withstanding Voltage: 1500V AC/minute
- Insulation Resistance: 1000M min
- Temperature Range: $-40^{\circ}\text{C} \sim +105^{\circ}\text{C}$
- Contact resistance: Intial value/10m max
- After enviornmental testing/20m max

■ WAFER

- Part No.: MF-9359-1*XX
- Poles: 02-12
- Material: Nylon 66 UL 94V-0 or UL94V-2
- Q'ty: 1000pcs/bag

Poles	Part No	Dimensions (mm)	
		A	B
2	9359-1*02	4.20	9.60
3	9359-1*03	8.40	13.80
4	9359-1*04	12.60	18.00
5	9359-1*05	16.80	22.20
6	9359-1*06	21.00	26.40
7	9359-1*07	25.20	30.60
8	9359-1*08	29.40	34.80
9	9359-1*09	33.60	39.00
10	9359-1*10	37.80	43.20
11	9359-1*11	42.00	47.40
12	9359-1*12	46.20	51.60

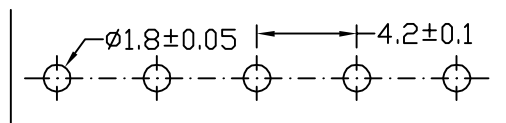

Recommnd PCB Layout

APPROVED BY	DATE	SCALE	TOLERANCE	
	2007/05/03	4:1	.0	± 0.3
CHECKED BY	UNIT	VIEW	.00	± 0.2
	mm		.000	± 0.1
DRAWN BY	VER NO.	SIZE	.0	\pm
	D1-1	A1	.0	\pm