

PS-SE-1Xxx-LF
 LEADFREE
 RoHS Compliant

Specifications:
 Current rating:5.0 AC/DC
 Voltage rating:250V AC/DC
 Contact resistance:20m ohm. max.
 Insulator resistance:1000M ohm. Min.
 Withstanding voltage:1500V AC for one minute
 Operating temperature range:-25°C to + 105°C
 Application wire:AWG#26 TO #18
 Material and Finish:
 Insulator:high Temp. Plastic(UL94V-2)

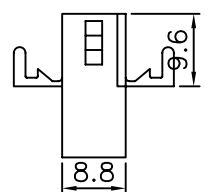

PS-SE-1X02

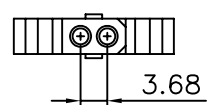
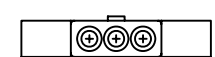
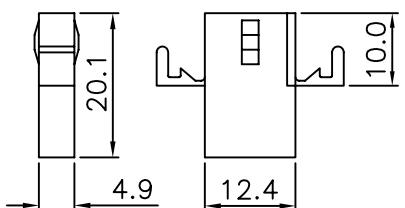
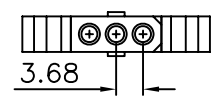

PS-SE-1X03

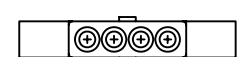
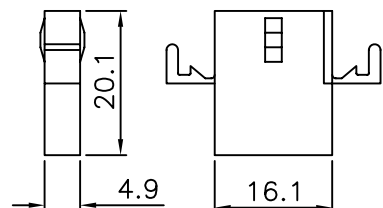
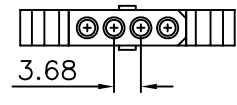

PS-SE-1X04

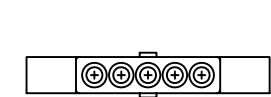
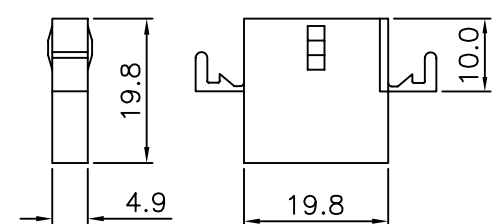
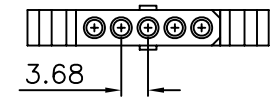

PS-SE-1X05



PART NO. PS-SE-1Xxx		CHECKED BY CY		TOLERANCES ARE .X ± 0.2 .XX ± .XXX ± AWG	DESCRIPTION: Plug Housing With Ear			
DWG NO. PS-SE-1Xxx		DRAWING BY			AREA	REVISIONS	HK	DATE
UNIT / mm	SCALE 1:1	PROJECTION						