

RECOMMENDED P.C. BOARD HOLE DIMM.

Specifications

Current Rating: 3A AC, DC
 Voltage Rating: 250 AC Maximum
 Operating Temp: -25°C ~ + 85°C
 Contact Resistance: 20mΩ Max
 Insulation Resistance: 1000MΩ Min
 Terminal Material: Brass/Tin-plated
 Material: Nylon 66, UL94V-2

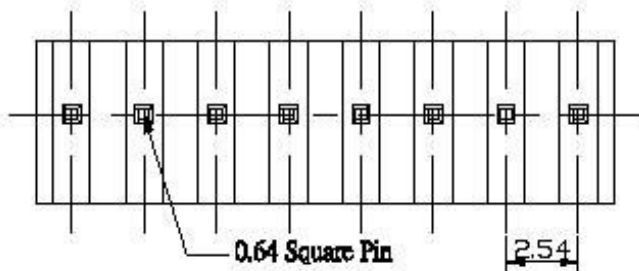
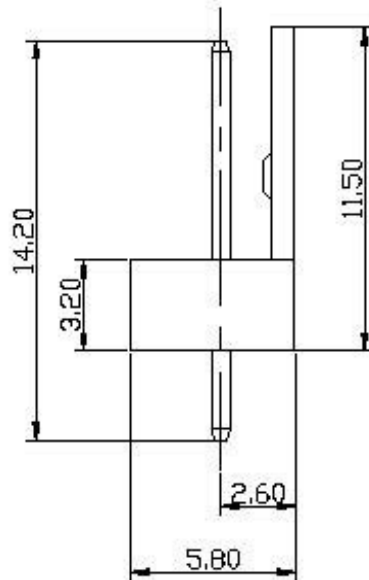
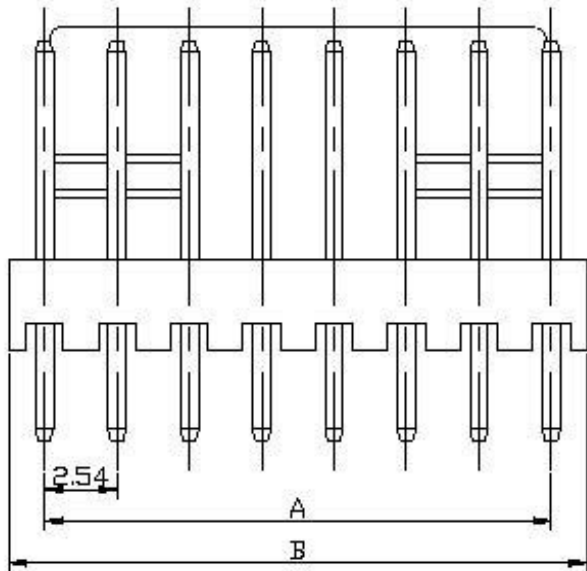

| Poles | Dimension mm (in.) | | Part No. |
|-------|--------------------|--------------|----------|
| | A | B | |
| 2 | 2.54(0.100) | 5.12(0.202) | MK-D-02 |
| 3 | 5.08(0.200) | 7.66(0.302) | MK-D-03 |
| 4 | 7.62(0.300) | 10.20(0.402) | MK-D-04 |
| 5 | 10.16(0.400) | 12.74(0.502) | MK-D-05 |
| 6 | 12.70(0.500) | 15.30(0.602) | MK-D-06 |
| 7 | 15.24(0.600) | 17.94(0.706) | MK-D-07 |
| 8 | 17.78(0.700) | 20.48(0.806) | MK-D-08 |
| 9 | 20.32(0.800) | 23.02(0.906) | MK-D-09 |
| 10 | 22.86(0.900) | 25.58(1.007) | MK-D-10 |
| 11 | 25.40(1.000) | 28.12(1.107) | MK-D-11 |
| 12 | 27.94(1.100) | 30.68(1.208) | MK-D-12 |
| 13 | 30.48(1.200) | 33.10(1.303) | MK-D-13 |
| 14 | 33.02(1.300) | 35.80(1.409) | MK-D-14 |
| 15 | 35.56(1.400) | 38.34(1.509) | MK-D-15 |
| 16 | 38.10(1.500) | 40.94(1.612) | MK-D-16 |
| 17 | 40.64(1.600) | 43.30(1.705) | MK-D-17 |
| 18 | 43.18(1.700) | 45.90(1.807) | MK-D-18 |
| 19 | 45.72(1.800) | 48.56(1.912) | MK-D-19 |
| 20 | 48.26(1.900) | 50.80(2.000) | MK-D-20 |

All Connectors

www.allconnectors.com
 All rights reserved.
 02/2018 Edition - Germany
 info@allconnectors.com
 www.allconnectors.com
 06/2018 Edition

RoHS Compliant

DRAWING BY CY
 CHECKED BY GENIUS
 UNIT/mm SCALE 1:1
 DATE
 SIZE A4 PROJECTION

TOLERANCES ARE

X ±
 XX ± 0.50
 XXX ± 0.10
 XXX ±
 ANG ±

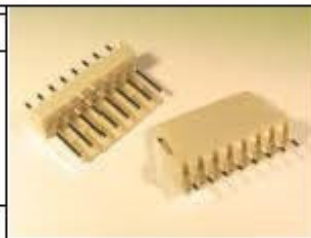

ORDER INFORMATION



DESCRIPTION: 2.54mm Wire-to-Board Header DIP 180° Type