

A-A SECTION

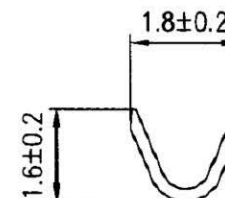
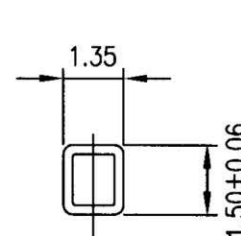
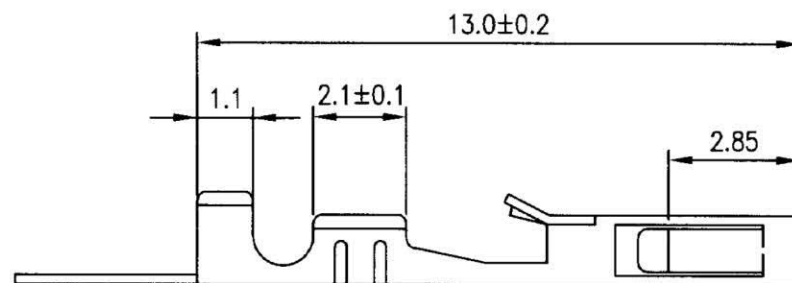

B-B SECTION

■ **TERMINAL**

- Material: Phos. bronze
- Thickness: 0.2mm
- Plating: Tin plated 60u"
- Wire Range: Suitable for AWG#22~28
- Insulation O.D: 1.7mm(max)
- Q'TY: 15,000 pcs/roll

RoHS Compliant

TOLERANCES ARE

All Connectors

DRAWING BY CY

X ±

CHECKED BY GENIUS

.X ±

UNIT / mm

SCALE 1 : 1

.XX ±

DATE

.XXX ±

SIZE A4

PROJECTION

ANG ±



ORDER INFORMATION

MCT-T-22-LF
 SERIES | T | LEADFREE
 22 AWG
 TERMINAL

DESCRIPTION:

www.allconnectors.de info@allconnectors.de
 Tel.: 0049 711 7009503 Fax: 0049 711 7009504
 70794 Filzbadenstadt - Germany Kettnerstr. 25