

# C2505 Series 2.50mm Pitch Series Wire to Wire Connectors

## C2505HM-2NP-N2BK

2.50mm Pitch Dual Row Housing

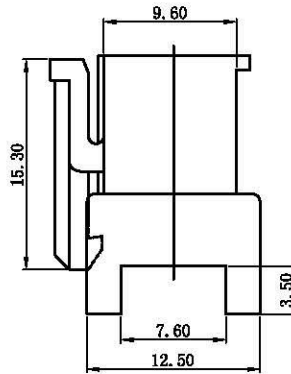
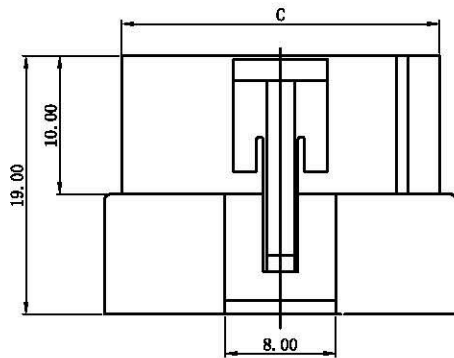
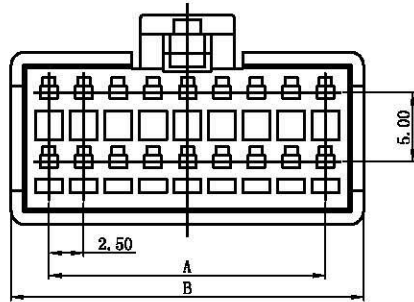

### Reference Informations:

\*Material:

Housing: PA66 UL94V-2/Black

\*Suitable LDZY C2505 series Terminal

\*Mates with LDZY C2505 Female Housing

Ordering Information & Dimensions

Poles	Dimensions (mm)		
	A	B	C
2*7	15.00	20.50	18.00
2*8	17.50	23.00	20.50
2*9	20.00	25.50	23.00
2*10	22.50	28.00	25.50

## C2505TF-PT1

2.50mm Pitch Terminal

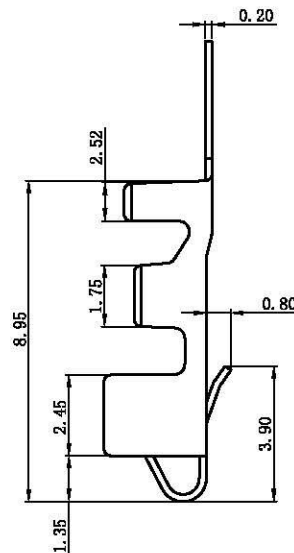
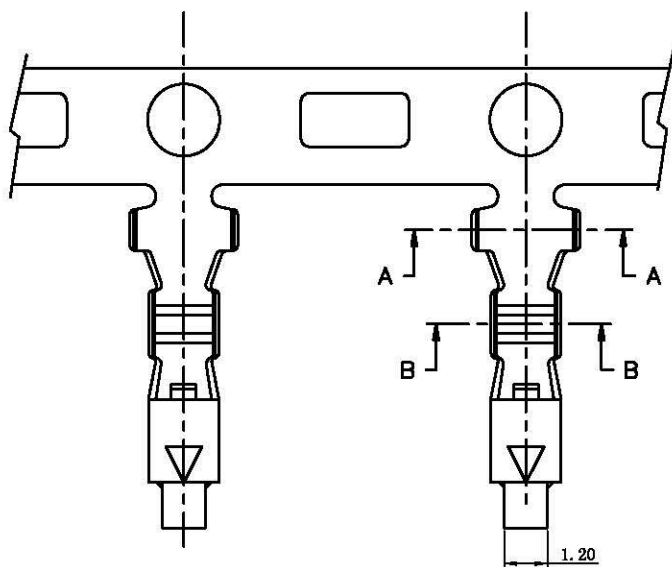

### Reference Informations:

\*Material: Phosphor Bronze/Tin-plated

\*Mates with LDZY C2505 series Housing

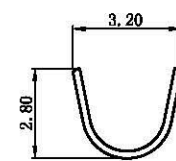

SEC:A-A

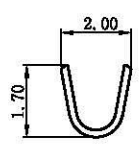

SEC:B-B

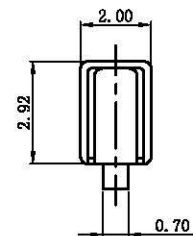

### Ordering Information & Specifications

Part No	Wire Range	Insulation O.D.	Material	Finish	Qty/reel
C2505TF-PT1	AWG#22-#28	1.80mm(max)	Phosphor Bronze	Tin-plated	5,000pcs