

A-A SECTION

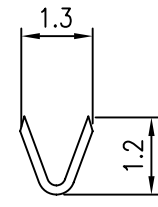

B-B SECTION

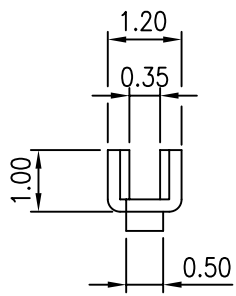
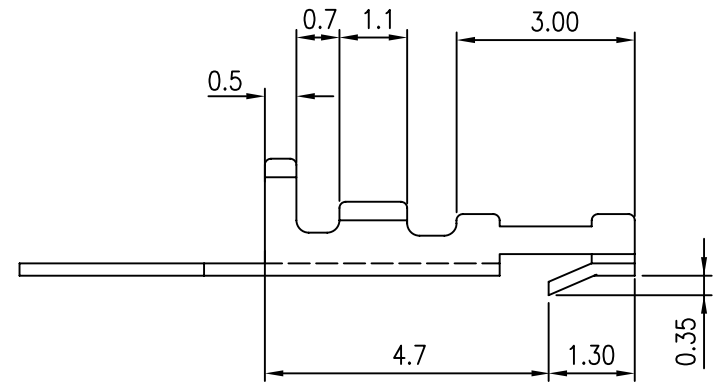

MV-T-26-LF  
LEADFREE

RoHS Compliant

PART NO.	PLATING
MV-T-26-LF	TIN
MV-TG-26-LF	GOLD

■ **TERMINAL**

- Material: Brass
- Thickness: 0.2mm
- Plating: Gold, Tin
- Wire Range: Suitable for AWG#26~30
- Insulation O.D: 1.35mm(max)
- Q'TY: 10,000 pcs/roll

PART NO. MV-T-26		CHECKED BY CY		TOLERANCES ARE .X±0.2 .XX± .XXX± AWG	DESCRIP TION: 2.00mm Pitch Terminal
DWG NO. MV-T-26		DRAWING BY			
FILE NO.		PROJECTION		AREA	REVISIONS
UNIT / mm	SCALE 1:1			HK	DATE