

1 2 3 4 5 6 7 8 9 0

J
I
H
G
F
E
D
C
B
A

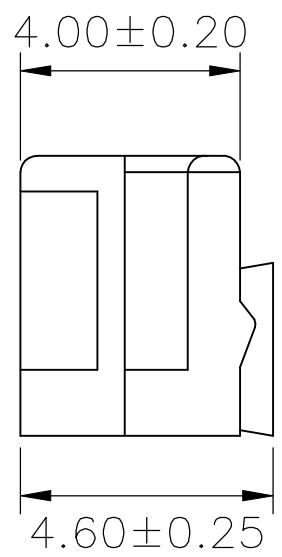
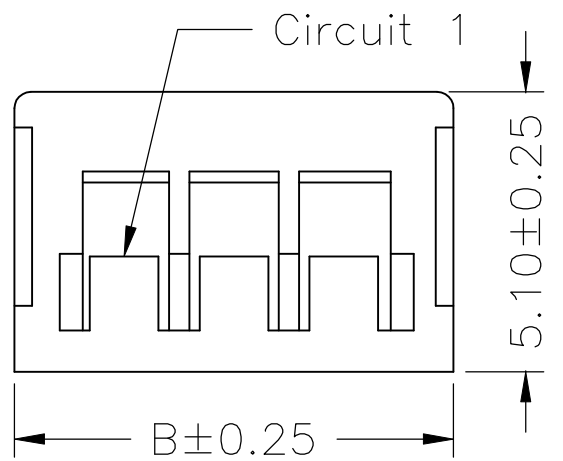
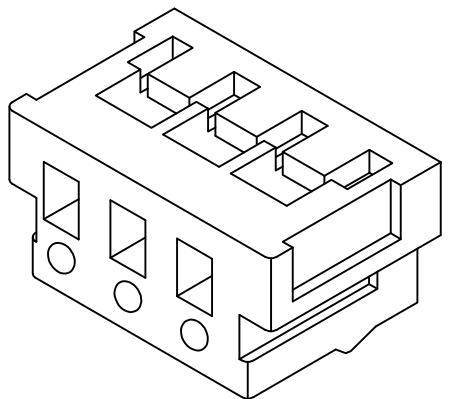
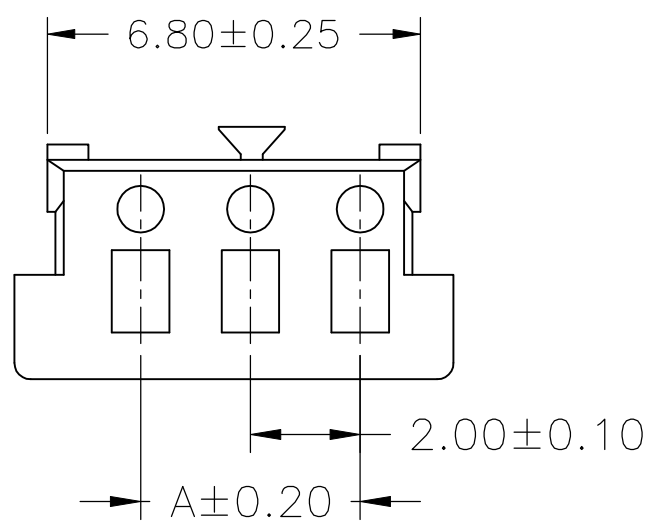

SPECIFICATIONS

Current Rating: 1A AC,DC
 Voltage Rating: 100V AC,DC
 Temperature Range: -25°C ~ +85°C
 Contact Resistance: 20mΩ Max.
 Insulation Resistance: 1000MΩ Min.
 Withstanding Voltage: 800V AC/minute
 Material: Nylon 66,UL94V-0

CT-H-xx-LF
 LEADFREE

RoHS Compliant

Ordering Information & Dimensions

PART NO.	Dimensions	
	A	B
CT-H-02	2.00	6.00
CT-H-03	4.00	8.00
CT-H-04	6.00	10.00
CT-H-05	8.00	12.00
CT-H-06	10.00	14.00
CT-H-07	12.00	16.00
CT-H-08	14.00	18.00
CT-H-09	16.00	20.00
CT-H-10	18.00	22.00
CT-H-11	20.00	24.00
CT-H-12	22.00	26.00
CT-H-13	24.00	28.00
CT-H-14	26.00	30.00
CT-H-15	28.00	32.00

All Connectors
 www.allconnectors.eu | info@allconnectors.eu
 Tel. +49 (0)711 / 358 110 20 | Fax +49 (0)711 / 358 110 25

PART NO. CT-H-xx		CHECKED BY CY	TOLERANCES ARE .X ± 0.2 .XX ± .XXX ± AWG
DWG NO. CT-H-xx			
FILE NO.		DRAWING BY	DESCRI P TION: 2.00mm PITCH HOUSING
UNIT / mm	SCALE 1:1	PROJECTION	

AREA	REVISIONS	HK	DATE
------	-----------	----	------