

This document is the property of Targ Yu Enterprise and is delivered on the express condition that it is not to be disclosed, reproduced or used, in whole or in part, for manufacture or sale by anyone other than Targ Yu Enterprise without its prior consent, and that no right is granted to disclose or to use any information in this document.

# Engineer Drawing

REV	ECN NO.	DESCRIPTION	DATE	APP'D
C/1	N/A	UPDATE DRAWING	12/27/12'	Paul
C/2	N/A	UPDATE DRAWING	06/27/13'	Paul
C/3	N/A	UPDATE FINISH	03/11/14'	Paul

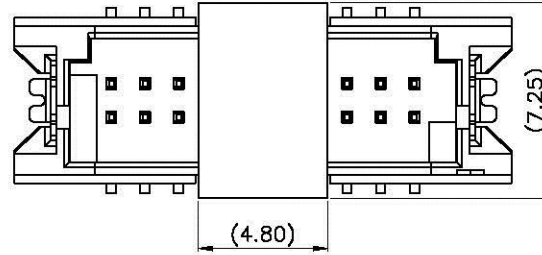
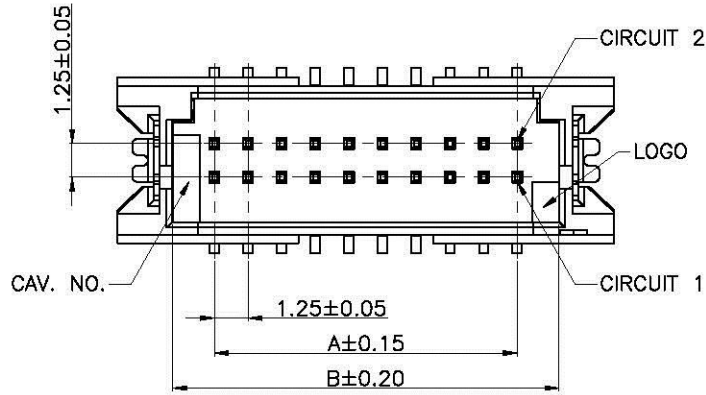

PICK AND PLACE AREA

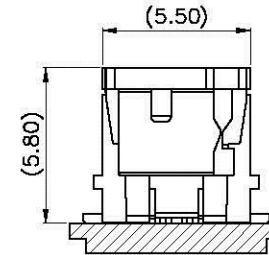
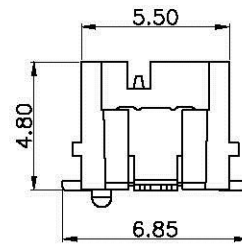
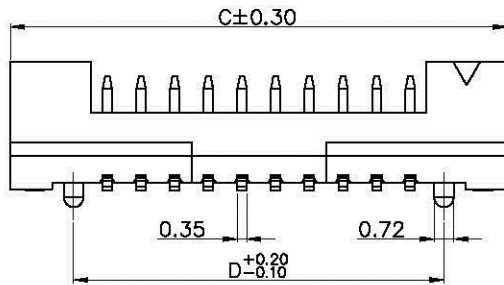
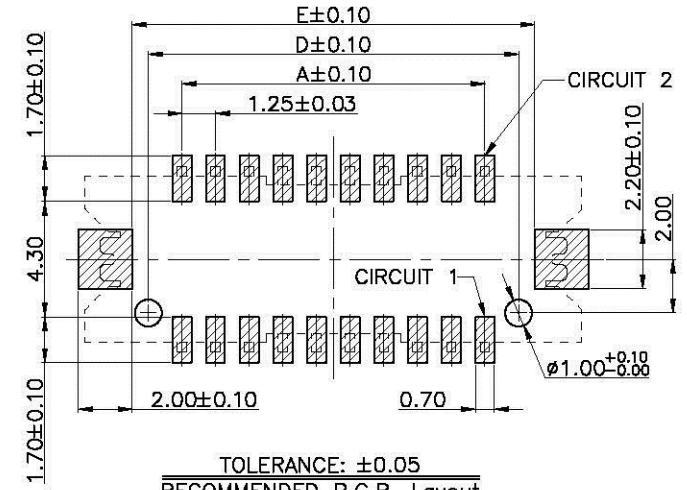

Mating Condition (REF.)

## NOTES:

- MATERIAL:  
INSULATION(STANDARD): NYLON 9T, UL94V-0 (CREAM)  
CONTACT: COPPER ALLOY  
SOLDER TAB: COPPER ALLOY t=0.20mm / MATTE-TIN PLATED OVER NICKEL
- CONTACT FINISH: (VOID)--MATTE-TIN PLATED OVER NICKEL  
GO--GOLD FLASH OVER NICKEL  
G\*--GOLD \*u" OVER NICKEL
- MATES WITH: TU1257 SERIES DUAL ROW HOUSING
- ORDERING CODE: TU1257WNV-2xNPS-\*A

PIN NO. \_\_\_\_\_ TAPE REEL PACKING  
SMT-TYPE \_\_\_\_\_  
FINISH SEE NOTE 2 \_\_\_\_\_

TOLERANCE		APPROVALS		DATE	All Connectors	
X.X	±0.25	DRAWN	<i>Suen Kong</i>	03/11/14'	www.allconnectors.com TEL: 0049 711 7009503 20294 Fildes Road Germany	
X.XX	±0.15	CHK'D	<i>Paul Chan</i>	03/11/14'	info@allconnectors.com Fax: 0049 711 7009504 Kornackerstr. 25	
ANGULA	3'	APP'D	<i>Wayne Lai</i>	03/11/14'	PART NO. TU1257WNV-2xNPS-*A	
UNLESS OTHERWISE SPECIFIED		UNITS mm	SCALE 1:1	SIZE: A4	DRAWING NO. EN-TU1257WNV-2xNPS-*A	
				SHEET 1 OF 3		TITLE: WIRE TO BOARD, WAFER, PITCH 1.25mm, DUAL ROW, VERTICAL, SMT TYPE, ASSEMBLY
						REV. C/3

This document is the property of Targ Yu Enterprise and is delivered on the express condition that it is not to be disclosed, reproduced or used, in whole or in part, for manufacture or sale by anyone other than Targ Yu Enterprise without its prior consent, and that no right is granted to disclose or to use any information in this document.

# Engineer Drawing

REV	ECN NO.	DESCRIPTION	DATE	APP'D
C/1	N/A	UPDATE DRAWING	12/27/12	Paul
C/2	N/A	UPDATE DRAWING	06/27/13	Paul
C/3	N/A	UPDATE FINISH	03/11/14	Paul

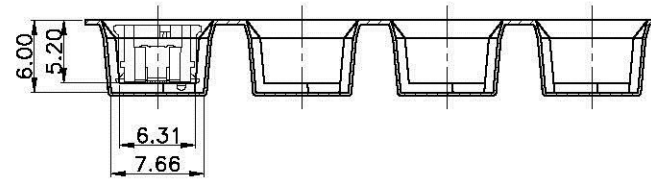
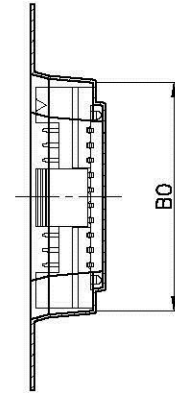
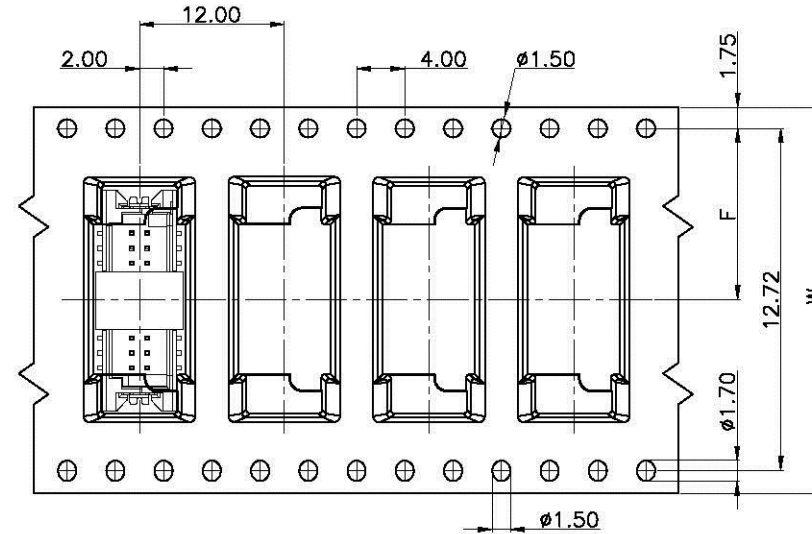
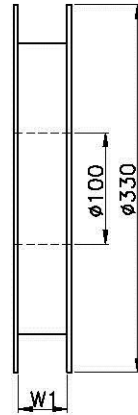
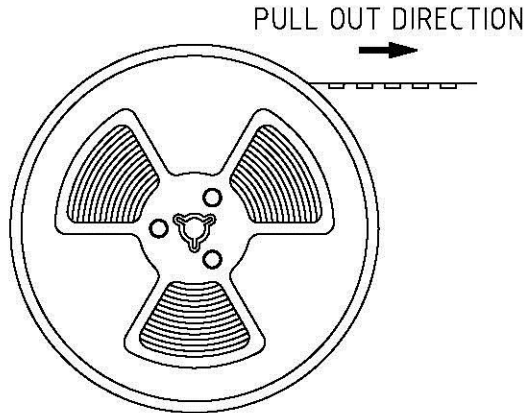

PIN	DIM.(mm)				
	B0	F	S	W	W1
2x05	12.65	11.50	-	24.00	24.50
2x10	18.90	14.20	28.40	32.00	32.50
2x15	25.15	20.20	40.40	44.00	44.50
2x20	31.40	20.20	40.40	44.00	44.50

**NOTES:**

1. 10 SPROCKET HOLE PITCH CUMULATIVE TOLERANCE  $\pm 0.20$ .
2. CARRIER CAMBER IS WITHIN 1 mm IN 250 mm.
3. MATERIAL : BLACK CONDUCTIVE POLYSTYRENE ALLOY.(UP-5000)
4. ALL DIMENSIONS MEET EIA-481-C REQUIREMENTS.
5. THICKNESS :  $0.35 \pm 0.05$ mm.
6. COMPONENT LOAD PER 19" REEL : 900 PCS.

TOLERANCE		APPROVALS		DATE	All Connectors	
X.X	$\pm 0.25$	DRAWN <i>Suen Hong</i>		03/11/14	www.allconnectors.de Tel.: 0049 711 7009503 70794 Filderstadt - Germany	
X.XX	$\pm 0.15$	CHK'D <i>Paul Chan</i>		03/11/14	PART NO. TU1257WNV-2xNPS-* -A	
ANGULA	3'	APP'D <i>Wayne Lai</i>		03/11/14	DRAWING NO. EN-TU1257WNV-2xNPS-* -A	
UNLESS OTHERWISE SPECIFIED		UNITS mm	SCALE 1:1	SIZE: A4	SHEET 2 OF 3	
					TITLE: WIRE TO BOARD, WAFER, PITCH 1.25mm, DUAL ROW, VERTICAL, SMT TYPE, ASSEMBLY	
					REV. C/3	

This document is the property of Targ Yu Enterprise and is delivered on the express condition that it is not to be disclosed, reproduced or used, in whole or in part, for manufacture or sale by anyone other than Targ Yu Enterprise without its prior consent, and that no right is granted to disclose or to use any information in this document.

# Engineer Drawing

REV	ECN NO.	DESCRIPTION	DATE	APP'D
C/1	N/A	UPDATE DRAWING	12/27/12	Paul
C/2	N/A	UPDATE DRAWING	06/27/13	Paul
C/3	N/A	UPDATE FINISH	03/11/14	Paul

PARTITION BOARD 2 PCS

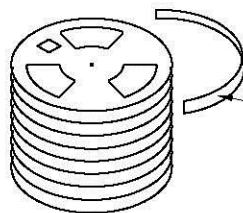
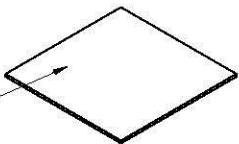

PROTECT TAPE



INNER BAG

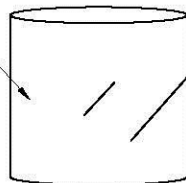

TRIANGLE BOARD 4 PCS

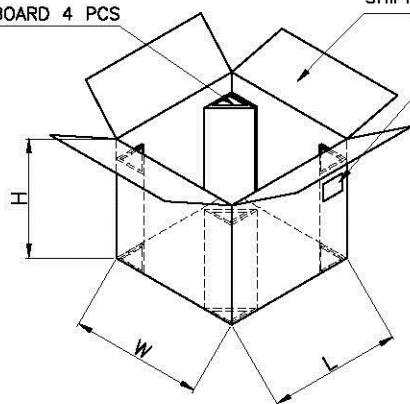

SHIPPING CARTON

TABEL

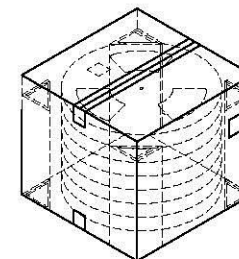

PACKING MATERIAL	
PART NAME	DIM.(mm)
REEL	ø330*(W+0.5)
CARTON	350*350*340

PACKING CAPACITY			
PART NO.	PCS/RE	RE/BC	PCS/BC
TU1257WNV-2x05S-*A	900 PCS/RE	10 RE/BC	9,000 PCS/BC
TU1257WNV-2x10S-*A	900 PCS/RE	8 RE/BC	7,200 PCS/BC
TU1257WNV-2x15S-*A	900 PCS/RE	6 RE/BC	5,400 PCS/BC
TU1257WNV-2x20S-*A	900 PCS/RE	6 RE/BC	5,400 PCS/BC

TOLERANCE		APPROVALS		DATE	All Connectors	
X.X	±0.25	DRAWN	<i>Suen Hong</i>	03/11/14	www.allconnectors.de Tel.: 0049 711 7009503 70794 Hilderstadt Germany	
X.XX	±0.15	CHK'D	<i>Paul Chan</i>	03/11/14	PART NO.	TITLE:
ANGULA	3'	APP'D	<i>Wayne Lai</i>	03/11/14	TU1257WNV-2xNPS-*A	WIRE TO BOARD, WAFER, PITCH 1.25mm, DUAL ROW, VERTICAL, SMT TYPE, ASSEMBLY
UNLESS OTHERWISE SPECIFIED		UNITS mm	SCALE 1:1	SIZE: A4	EN-TU1257WNV-2xNPS-*A	REV. C/3
					⊕	SHEET 3 OF 3

F