

This document is the property of Targ Yu Enterprise and is delivered on the express condition that it is not to be disclosed, reproduced or used, in whole or in part, for manufacture or sale by anyone other than Targ Yu Enterprise without its prior consent, and that no right is granted to disclose or to use any information in this document.

Engineer Drawing

REV	ECN NO.	DESCRIPTION	DATE	APP'D
A/2	N/A	UPDATE DRAWING	06/17/13	Paul
A/3	ECN-EN-2014021	AMEND PRODUCTION	04/01/14	Paul
A/4	ECN-EN-2014033	AMEND PRODUCTION	05/16/14	Paul

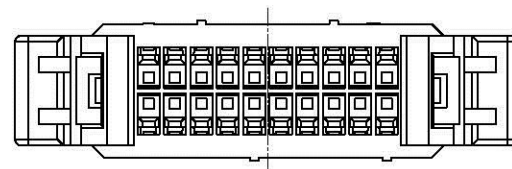
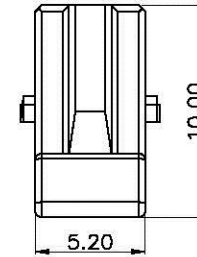
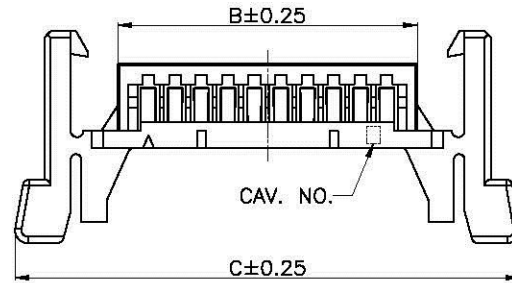
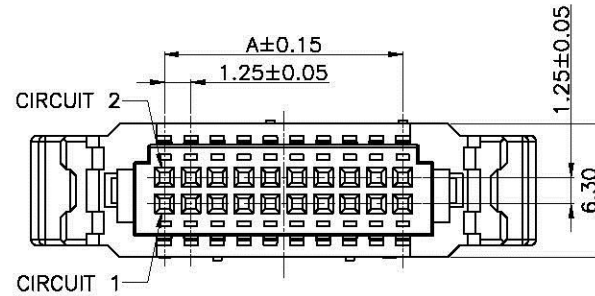

PIN	DIM.(mm)		
	A	B	C
10	5.00	7.90	17.60
20	11.25	14.15	23.85
30	17.50	20.40	30.10
40	23.75	26.65	36.35

NOTES:

1. MATERIAL(HALOGEN FREE): NYLON 66, UL94V-0 (GREY)
2. USE WITH: TU1257 CRIMP TERMINAL
3. MATES WITH: TU1257 SERIES DUAL ROW WAFER
4. ORDERING CODE: TU1257HNO-2xNPK-*

PIN NO. _____ MATERIAL COLOR
 WITH LATCH TYPE _____ (VOID)--GREY
 C1--BLACK

TOLERANCE		APPROVALS		DATE	All Connectors	
X.X	± 0.25	DRAWN	<i>Siuw Kong</i>	05/16/14	www.allconnectors.com Tel.: 0049 211 7009503 70794 Filderstadt - Germany	
X.XX	± 0.15	CHK'D	<i>Paul Shen</i>	05/16/14	PART NO.	TITLE:
ANGULA	3°	APP'D	<i>Wayne Lai</i>	05/16/14	TU1257HNO-2xNPK-*	WIRE TO BOARD, RECEPTACLE, PITCH 1.25mm, DUAL ROW, CRIMP TYPE, INSULATOR
UNLESS OTHERWISE SPECIFIED		UNITS mm	SCALE 1:1	SIZE: A4	SHEET 1 OF 1	REV. A/4