

A1201 SERIES

1.20mm pitch wire to board connector

A1201WRA-S

1.20mm pitch 90° Wafer - SMT TYPE

Reference Informations:

- *Material: Pin: Phosphor Bronze/Gold over Nickel
- Insulator: Nylon 6T, UL94V-0
- Solder Tab: Phosphor Bronze/Tin over Nickel
- *Mates with A1201HA series Housing
- *Color: Ivory

Ordering Information:

A1201WRA-S-XP - **

1. Part No.
2. Material:
(blank): Ivory
BK: Black

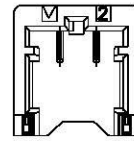

2Pin

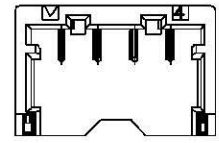

4Pin

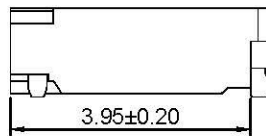
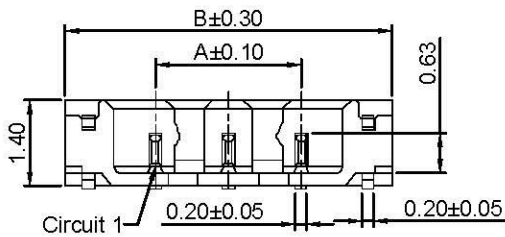
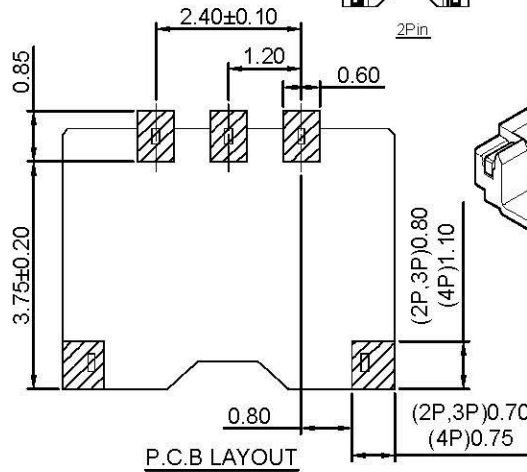
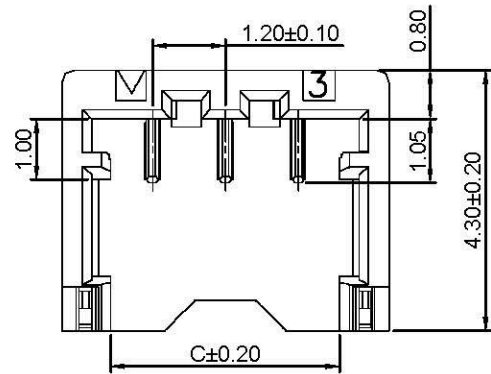
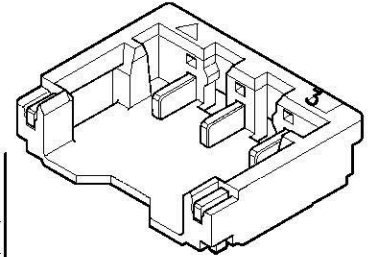

Ordering Information & Dimensions:

PART NO.	Dimensions		
	A	B	C
A1201WRA-S-2P	1.20	4.20	2.60
A1201WRA-S-3P	2.40	5.40	3.80
A1201WRA-S-4P	3.60	6.60	5.00

Unit: mm