

CKT	Dim A	Dim B	Dim C
2	0.80	1.90	3.78
3	1.60	2.70	4.58
4	2.40	3.50	5.38
5	3.20	4.30	6.18
6	4.00	5.10	6.98
7	4.80	5.90	7.78
8	5.60	6.70	8.58
9	6.40	7.50	9.38
10	7.20	8.30	10.18
11	8.00	9.10	10.98
12	8.80	9.90	11.78
13	9.60	10.70	12.58
14	10.40	11.50	13.38
15	11.20	12.30	14.18
16	12.00	13.10	14.98
17	12.80	13.90	15.78
18	13.60	14.70	16.58
19	14.40	15.50	17.38
20	15.20	16.30	18.18
22	16.80	17.90	19.78

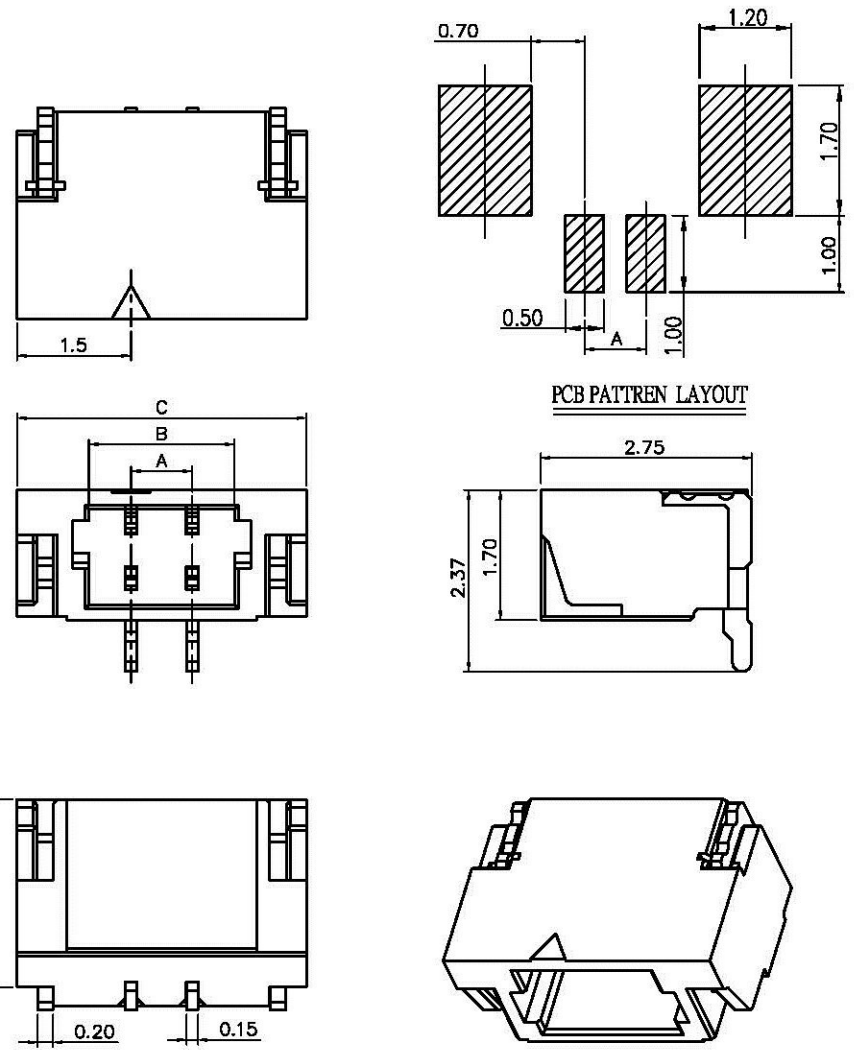

ORDERING INFORMATION

WB 080 1 U S - XX T X
 (1) (2) (3)(4) (5) (6)(7)

- SERIES NO.
WB: WIRE TO BOARD CONNECTOR
- WAFER PITCH TYPE
080: 0.80mm PITCH CONNECTOR
- TAIL CONSTRUCTION TYPE
U: SMT TYPE
- MALE AND FEMALE MATING TYPE
S: STRAIGHT R: RIGHT ANGLE
- NUMBER OF PIN
XX: XX POSITIONS
- CONTACT PLATING
T: TIN PLATING
G: GOLD PLATING
- HOUSING MATERIAL
5: NYLON 9T

MATERIAL SPECIFICATION:

- HOUSING: Thermoplastic, High temp. UL94V-0
- CONTACT: High performance copper alloy

ELECTRICAL PERFORMANCE

- RATED VOLTAGE(MAX.): 50V AC/DC
- RATED CURRENT(MAX.): 0.7A DC
- DIELECTRIC STRENGTH: 500V AC FOR 1 MINUTE
- INSULATION RESISTANCE: 100 MEGOHMS MIN.
- CONTACT RESISTANCE: 40 MILLIOHM MAX.
- OPERATING TEMPERATURE: -25° to +85°

5				DRAWING:	GENERAL TOLERANCE	 www.allconnectors.de Tel.: 0049 711 7009503 70794 Filderstadt - Germany info@allconnectors.de Fax: 0049 711 7009504 Kettnerstr. 25	DESCRIPTION: 0.8mm PITCH IDC WAFER
4			<i>Match</i>	X: ±0.40 X': ±2° XX: ±0.20 XX': ±1° XXX: ±0.10 XXX': ±0.5°			
3			CHECKED:	UNIT: MM PROJECTION:			
2			<i>Fahr</i>	SCALE: 1/1			
1			APPROVAL:	SHEET: 1/1			
NO.	DATE	DESCRIPTION	APPROVAL	<i>Felice</i>		PART NO: WB0801US-XXTX	REV: 1.0
						DRAWING NO: P1WB0801US-XXTX-01	SIZE: A4

