

This document is the property of Targ Yu Enterprise and is delivered on the express condition that it is not to be disclosed, reproduced or used, in whole or in part, for manufacture or sale by anyone other than Targ Yu Enterprise without its prior consent, and that no right is granted to disclose or to use any information in this document.

# Engineer Drawing

REV	ECN NO.	DESCRIPTION	DATE	APP'D
A/0		RELEASE TO PRODUCTION	11/30/09	Goldberg

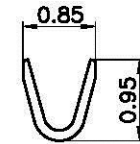
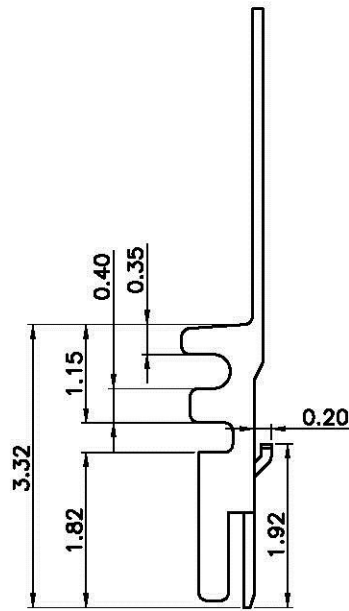
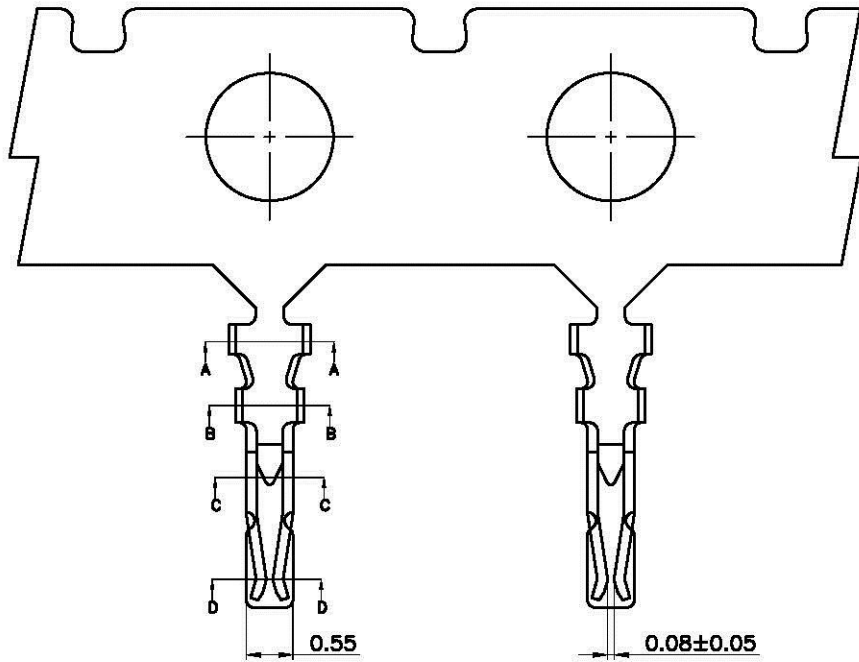

Section A-A

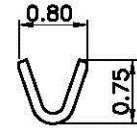

Section B-B

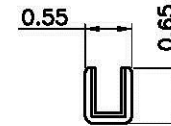

Section C-C

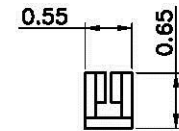

Section D-D

**NOTES:**

- MATERIAL: COPPER ALLOY.  $t=0.12\text{mm}$
- FINISH: A TIN-PLATED OVER NICKEL.  
 AE PRESSING BEFORE TIN-PLATED OVER NICKEL.  
 GO GOLD FLASH OVER NICKEL.  
 G\* GOLD \*U\* OVER NICKEL.
- APPLICABLE WIRE RANGE: AWG #32~#36
- INSULATION O.D.: 0.54mm MAX.
- PACKING: 15K/REEL
- ORDERING CODE : TU0802TPO-\*  
 └─ FINISH SEE NOTE 2

TOLERANCE		APPROVALS		DATE	All Connectors	
X.	±0.30	DRAWN <i>Vinson Hu</i>		11/30/09*	www.allconnectors.de Tel: 0049 211 7002503 70734 Filsenstadt - Germany	
X.X	±0.25	CHK'D <i>Goldberg Chen</i>		11/30/09*	info@allconnectors.de Fax: 0049 211 7002501 Kette meistr. 25	
X.XX	±0.15	APP'D <i>Wayne Lai</i>		11/30/09*	PART NO. TU0802TPO-*	TITLE: WIRE TO BOARD, PLUG, PITCH 0.80mm, CRIMP TYPE, CONTACT
X.XXX	±0.08	UNITS mm		SCALE 1:1	DRAWING NO. EN-TU0802TPO-*	
ANGULA	J	UNLESS OTHERWISE SPECIFIED		SIZE: A4	SHEET 1 OF 2	
						REV. A/0

This document is the property of Targ Yu Enterprise and is delivered on the express condition that it is not to be disclosed, reproduced or used, in whole or in part, for manufacture or sale by anyone other than Targ Yu Enterprise without its prior consent, and that no right is granted to disclose or to use any information in this document.

# Engineer Drawing

REV	ECN NO.	DESCRIPTION	DATE	APP'D
A/0		RELEASE TO PRODUCTION	11/30/09	Goldberg

## PACKING MATERIAL

PART NAME	DIM(mm)
CARTON	580*580*210

## PACKING CAPACITY

PART NO.	PCS/RE	RE/BC	PCS/BC
TU0802TPO-*	20,000PCS/RE	8RE/BC	160,000PCS/BC

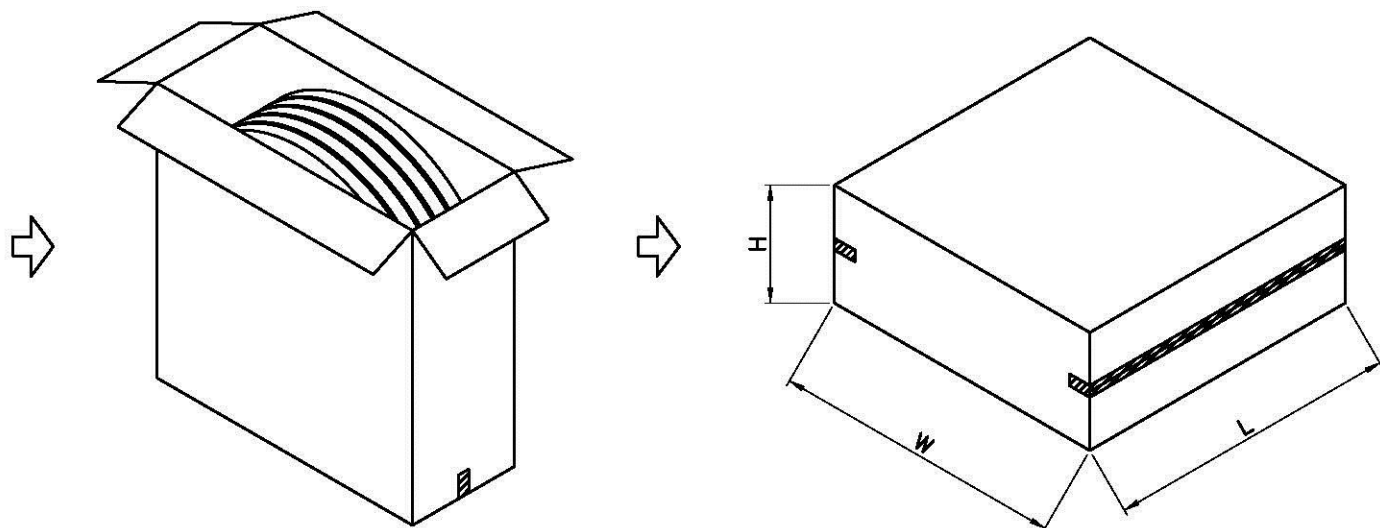
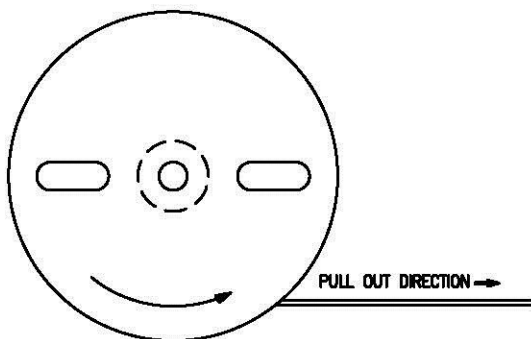
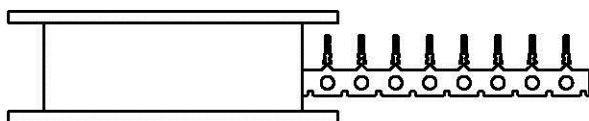

TOLERANCE	
X.	±0.30
X.X	±0.25
X.XX	±0.15
X.XXX	±0.08
ANGULA	3
UNLESS OTHERWISE SPECIFIED	

APPROVALS		DATE
DRAWN	<i>Vinson Hu</i>	11/30/09'
CHK'D	<i>Goldberg Chen</i>	11/30/09'
APP'D	<i>Wayne Lai</i>	11/30/09'
UNITS	mm	SCALE 1:1
		SIZE: A4

**All Connectors**  
 www.allconnectors.de  
 Tel.: 0049 711 7009503  
 70794 Filderstadt, Germany

info@allconnectors.de  
 Fax: 0049 711 7009504  
 Kettelerstraße 25

PART NO. TU0802TPO-*	TITLE: WIRE TO BOARD, PLUG, PITCH 0.80mm, CRIMP TYPE, CONTACT
DRAWING NO. EN-TU0802TPO-*	
SHEET 2 OF 2	
REV. A/0	