

1.00±0.10

交點

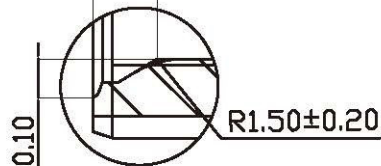

DETAIL A 10:1

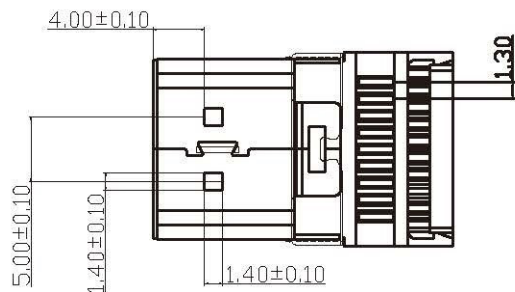
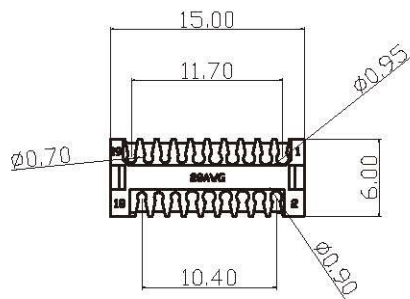
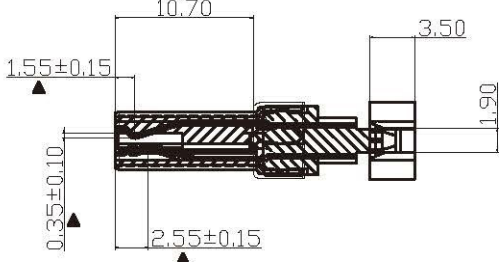
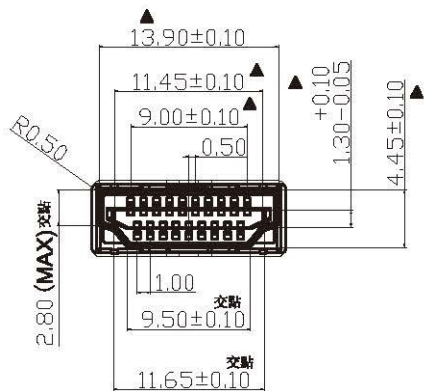
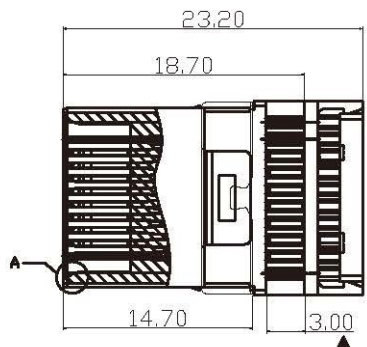

Note:

1.Material:

- 1.1 Housing: LCP / PA66, UL 94-V0 rated.
- 1.2 Contact: Phosphor Bronze, t=0.25mm.
- 1.3 Front Shell: Cold rolled steel, t=0.30mm.
- 1.4 Back Shell: Cold rolled steel, t=0.30mm.

2:Specification:

- 2.1 Current rating: 0.5 A Max.
- 2.2 Voltage rating: 40 V ac(rms) Max.
- 2.3 Contact resistance: 50 mW Max.
- 2.4 Dielectric withstanding voltage: 100 V(ac) for 1 min.
- 2.5 Insulation resistance:1000 MW Min.
- 2.6 Operation temperature range:-25°C~85°C

3.Finishes:

- 3.1 Contacts: Gold 5u",15u"30u",on Contact area . 100u-120u" 霧錫. Plating on soldertails. 50u"-80u" Nickel .underplating over all
- 3.2 front Shell: Gold flashed or Nickel Plated
- 3.3 back Shell: Tin Plated

4." 為重要尺寸符號;

7	BACK SHELL	1	Cold rolled steel	T=0.30±0.01mm	Tin Plated
6	FRONT SHELL	1	Cold rolled steel	T=0.30±0.01mm	Gold Flashed/ Nickel Plated
5	Contacts 1	10	Phosphor Bronze	T=0.25±0.01mm	Gold 15u"/5u"
4	Contacts 2	9	Phosphor Bronze	T=0.25±0.01mm	Gold 15u"/5u"
3	膠芯中塞	1	LCP		Black
2	膠芯主體	1	LCP		Black
1	膠芯後塞	1	PA66		Black
No.	Part Name	Q'ty	Material	Thickness	Finish

RoHS Compliant

TOLERANCES ARE

All Connectors

DRAWING BY CY

CHECKED BY GENIUS

UNIT / mm SCALE 1 : 1

DATE

SIZE A4 PPROJECTION

X ±
X ± 0.25
.XX ± 0.15
.XXX ± 0.05
ANG ±

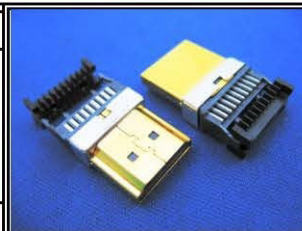

ORDER INFORMATION

HDMI-PM28-19-LF

SERIES | | | LEADFREE
19 WAY
28AWG
MOLDING
MALE

DESCRIPTION: HDMI 19PIN MALE SOLDER(兩排) (28#排線座)

www.allconnectors.de info@allconnectors.de
Tel.: 0049 711 7009503 Fax: 0049 711 7009504
70791 Filderstadt - Germany Ketteimerstr. 25