

NOTES:
 1.ALL DIMENSION ARE IN mm.
 2.MATERIAL:
 HOUSING:THERMOPLASTIC(94V-0) COLOR: GRAY
 CONTACT:COPPER ALLOY
 3.FINISH:
 CONTACT SURFACE: GOLD PLATING;
 PRESSING END: MATTE TIN PLATING.
 4.ENGAGING AND SEPARATING FORCES PER IEC 61076-4-101.
 5.ROHS DIRECTIVE COMPLIANCE.
 6.MAX SOLDERING TEMPERATURE 225 °C .
 7.PERFORMANCE CHARACTERISTICS
 INSULATION RESISTANCE:10,000 MEGOHMS MINIMUM
 DIELECTRIC WITHSTANDING VOLTAGE(AT SEA LEVEL):750 Vrms
 CURRENT RATING:1 AMP AT 70 °C,FULLY LOADED
 1.5 AMP AT 20 °C,FULLY LOADED
 OPERATING TEMPERATURE RANGE:-55 °C TO +125 °C
 CONTACT RESISTANCE: 20 MILLIOHMS MAXIMUM

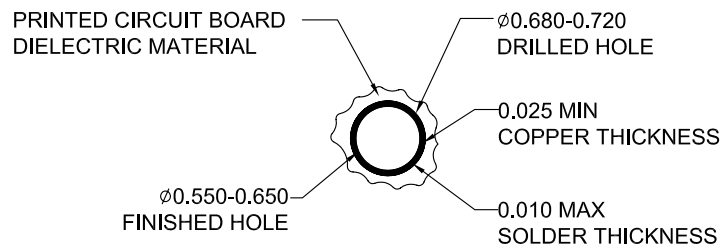

THRU HOLE PLATING
SCALE 10:1

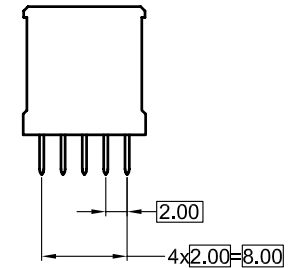
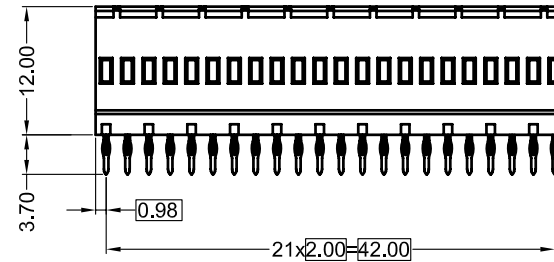
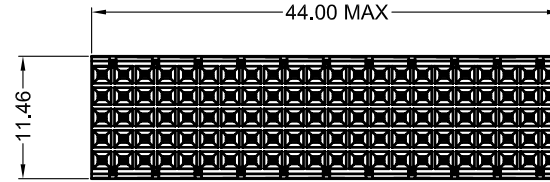
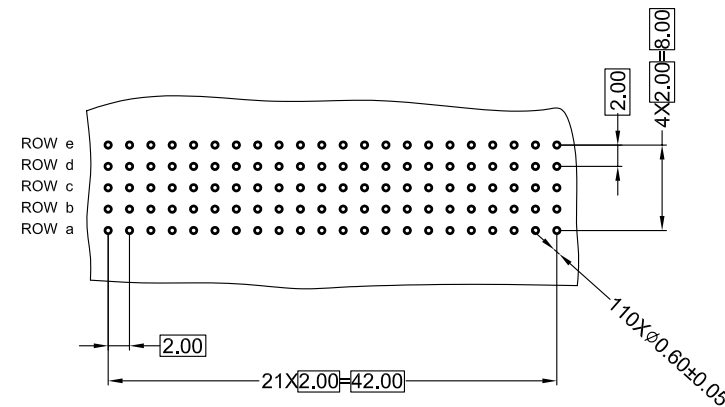

PCB LAYOUT

DESIGN UNITS <input checked="" type="checkbox"/> mm <input type="checkbox"/> INCH		NAME: 2MM 180° SOCKET B22 TYPE NO SHIELD		Allconnectors	
GENERAL TOLERANCES: (UNLESS SPECIFIED)		PART NO: NX7B0AC01A0AF		TITLE: CUSTOMER DWG C	
		APPD: 蘇侯安 2/28'07		DWG. NO: C-NX7B0AC01A0AF	
		CHKD: 楊海文 2/28'07			
		DRAWN: 蔡友華 2/28'07			
		ANGULAR: X° ± ** X° ± **			
				SCALE: SHEET: REV.:	
				1/1 1/1 X1	

X1		Release	2/28'07	蔡友華	蘇侯安
REV.	ECN. NO.	DESCRIPTION	DATE	DRAWN	APPD