

| REV | DATE | ECN NO. | MODIFICATION | APPROVER |
|-----|------------|---------|--------------|-----------|
| A | 2012/04/19 | | NEW | Jason Lee |

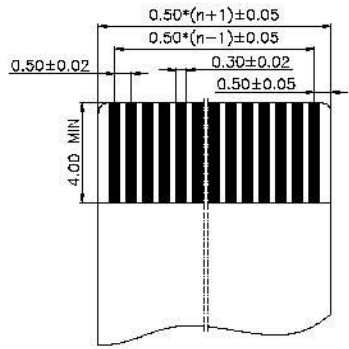

适用扁平电缆

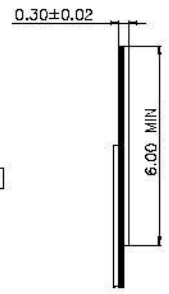
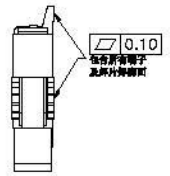
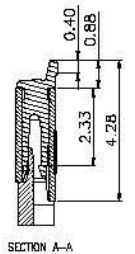
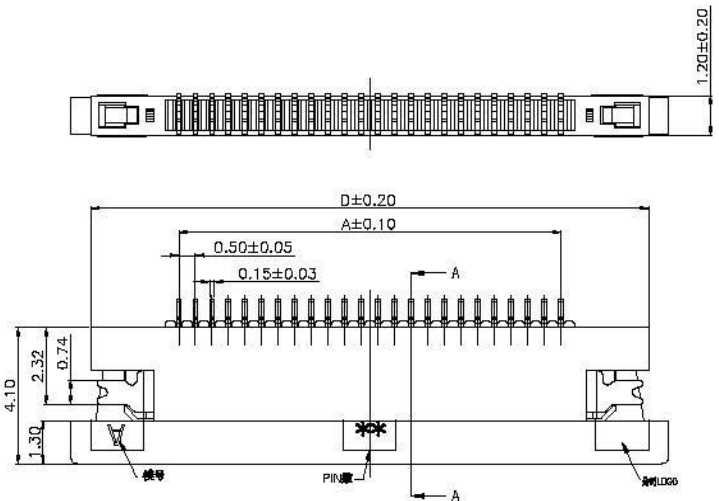
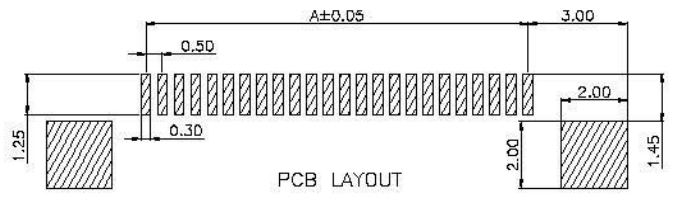
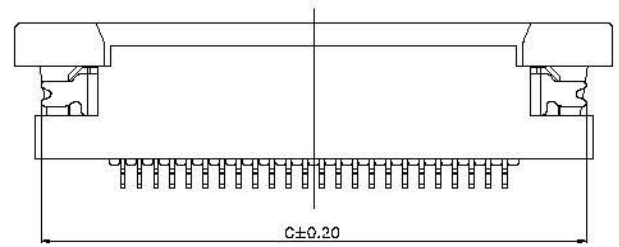
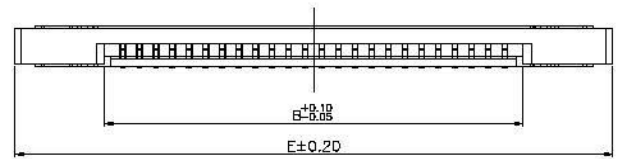

SPECIFICATION

- Material:
 - Housing: Thermoplastic, UL94V-0, color: Natural.
 - Lock: Thermoplastic, UL94V-0, color: Black.
 - Contacts: Copper alloy
 - Tin/Gold plated over nickel plated (50 u" min)
 - Solder tab: Copper alloy
 - Tin/Gold plated over nickel plated (50 u" min)
- Electrical Characteristics:
 - Voltage rating: 50V(max).
 - Current rating : 0.5A(max).
 - Operating Temperature: -40°C~+85°C.
 - Insulation resistance: 50M ohms min. at 500VDC
 - Dielectric withstanding voltage: 250 VAC/1minute.
 - Contact resistance: 30m ohms max.

| PIN NO. | DIMENSIONS | | | | |
|---------|------------|-------|-------|-------|-------|
| | A | B | C | D | E |
| 4 | 1.50 | 2.60 | 6.42 | 6.80 | 8.00 |
| 5 | 2.00 | 3.10 | 6.92 | 7.30 | 8.50 |
| 6 | 2.50 | 3.60 | 7.42 | 7.80 | 9.00 |
| 7 | 3.00 | 4.10 | 7.92 | 8.30 | 9.50 |
| 8 | 3.50 | 4.60 | 8.42 | 8.80 | 10.00 |
| 9 | 4.00 | 5.10 | 8.92 | 9.30 | 10.50 |
| 10 | 4.50 | 5.60 | 9.42 | 9.80 | 11.00 |
| 11 | 5.00 | 6.10 | 9.92 | 10.30 | 11.50 |
| 12 | 5.50 | 6.60 | 10.42 | 10.80 | 12.00 |
| 13 | 6.00 | 7.10 | 10.92 | 11.30 | 12.50 |
| 14 | 6.50 | 7.60 | 11.42 | 11.80 | 13.00 |
| 15 | 7.00 | 8.10 | 11.92 | 12.30 | 13.50 |
| 16 | 7.50 | 8.60 | 12.42 | 12.80 | 14.00 |
| 17 | 8.00 | 9.10 | 12.92 | 13.30 | 14.50 |
| 18 | 8.50 | 9.60 | 13.42 | 13.80 | 15.00 |
| 19 | 9.00 | 10.10 | 13.92 | 14.30 | 15.50 |
| 20 | 9.50 | 10.60 | 14.42 | 14.80 | 16.00 |
| 21 | 10.00 | 11.10 | 14.92 | 15.30 | 16.50 |
| 22 | 10.50 | 11.60 | 15.42 | 15.80 | 17.00 |
| 23 | 11.00 | 12.10 | 15.92 | 16.30 | 17.50 |
| 24 | 11.50 | 12.60 | 16.42 | 16.80 | 18.00 |
| 25 | 12.00 | 13.10 | 16.92 | 17.30 | 18.50 |
| 26 | 12.50 | 13.60 | 17.42 | 17.80 | 19.00 |
| 27 | 13.00 | 14.10 | 17.92 | 18.30 | 19.50 |
| 28 | 13.50 | 14.60 | 18.42 | 18.80 | 20.00 |
| 29 | 14.00 | 15.10 | 18.92 | 19.30 | 20.50 |
| 30 | 14.50 | 15.60 | 19.42 | 19.80 | 21.00 |
| 31 | 15.00 | 16.10 | 19.92 | 20.30 | 21.50 |
| 32 | 15.50 | 16.60 | 20.42 | 20.80 | 22.00 |
| 33 | 16.00 | 17.10 | 20.92 | 21.30 | 22.50 |
| 34 | 16.50 | 17.60 | 21.42 | 21.80 | 23.00 |
| 35 | 17.00 | 18.10 | 21.92 | 22.30 | 23.50 |
| 36 | 17.50 | 18.60 | 22.42 | 22.80 | 24.00 |
| 37 | 18.00 | 19.10 | 22.92 | 23.30 | 24.50 |
| 38 | 18.50 | 19.60 | 23.42 | 23.80 | 25.00 |
| 39 | 19.00 | 20.10 | 23.92 | 24.30 | 25.50 |
| 40 | 19.50 | 20.60 | 24.42 | 24.80 | 26.00 |
| 41 | 20.00 | 21.10 | 24.92 | 25.30 | 26.50 |
| 42 | 20.50 | 21.60 | 25.42 | 25.80 | 27.00 |
| 43 | 21.00 | 22.10 | 25.92 | 26.30 | 27.50 |
| 44 | 21.50 | 22.60 | 26.42 | 26.80 | 28.00 |
| 45 | 22.00 | 23.10 | 26.92 | 27.30 | 28.50 |
| 46 | 22.50 | 23.60 | 27.42 | 27.80 | 29.00 |
| 47 | 23.00 | 24.10 | 27.92 | 28.30 | 29.50 |
| 48 | 23.50 | 24.60 | 28.42 | 28.80 | 30.00 |
| 49 | 24.00 | 25.10 | 28.92 | 29.30 | 30.50 |
| 50 | 24.50 | 25.60 | 29.42 | 29.80 | 31.00 |
| 51 | 25.00 | 26.10 | 29.92 | 30.30 | 31.50 |
| 52 | 25.50 | 26.60 | 30.42 | 30.80 | 32.00 |
| 53 | 26.00 | 27.10 | 30.92 | 31.30 | 32.50 |
| 54 | 26.50 | 27.60 | 31.42 | 31.80 | 33.00 |
| 55 | 27.00 | 28.10 | 31.92 | 32.30 | 33.50 |
| 56 | 27.50 | 28.60 | 32.42 | 32.80 | 34.00 |
| 57 | 28.00 | 29.10 | 32.92 | 33.30 | 34.50 |
| 58 | 28.50 | 29.60 | 33.42 | 33.80 | 35.00 |
| 59 | 29.00 | 30.10 | 33.92 | 34.30 | 35.50 |
| 60 | 29.50 | 30.60 | 34.42 | 34.80 | 36.00 |

| | | | | | | | |
|--------------------------|-------------------------------------|-------------|---------------------|--------------------------------|---------|-------------|-------|
| GENERAL TOLERANCE | | UNITS mm | NAME: | | | | |
| SELECT | <input checked="" type="checkbox"/> | | 0.5mm FPC Connector | | | | |
| DN. | TOL | MAT'L | PART NO: | TITLE: 0.5mm FPC(H=1.2mm) 卧式下接 | | | |
| X.XXX | ±0.10 ±0.05 ±0.15 | | FPC050**~13** | | | | |
| X.XX | ±0.15 ±0.12 ±0.25 | FINISH | APPD: | Peter | DWG NO. | ATOM-A01446 | |
| X.X | ±0.20 ±0.25 ±0.5 | | Q'TY | CHKD: | Jason | SCALE | SHEET |
| X. | ±0.30 ±0.38 ±1.00 | | DR: | XH | 1:1 | 1/1 | A |
| ANGLE | ±2° | | | | | | |